

Benchmark: BM #6 - Square cut in base of L.P. at N.E. corner of IL Route 132 and Magnolia (Speedway) 45.14' LT, Sta. 32+13.24 (IL 132 E.B. M), Elev. 696.47.

Existing Structure: None.

STATE OF ILLINOIS
DEPARTMENT OF TRANSPORTATION

ROUTE NO.	SECTION	COUNTY	POST MILES	SHEET	SHEET NO. - 1
346		LAKE	469	314	21 SHEETS

125X-HB-(1&2) R-1 CONTRACT # 60826
TOTAL BILL OF MATERIAL

ITEM	UNIT	TOTAL
Structure Excavation	CU YD	459
Concrete Structures	CU YD	219
Concrete Superstructure	CU YD	259
Protective Coat	SQ YD	580
Form Liner Textured Surface	SQ YD	417
Furnishing and Erecting Structural Steel	POUND	7,780
Stud Shear Connectors	EACH	778
Untreated Timber Lagging	SQ FT	3,746
Furnishing Soldier Piles (W Section)	FOOT	1,802
Reinforcement Bars, Epoxy Coated	POUND	49,810
Geocomposite Wall Drain	SQ YD	438
Pipe Underdrains for Structures, 4"	FOOT	379
Drilling and Setting Soldier Piles (in Soil)	CU FT	9,220
Anti-Graffiti Coating	SQ FT	5,262

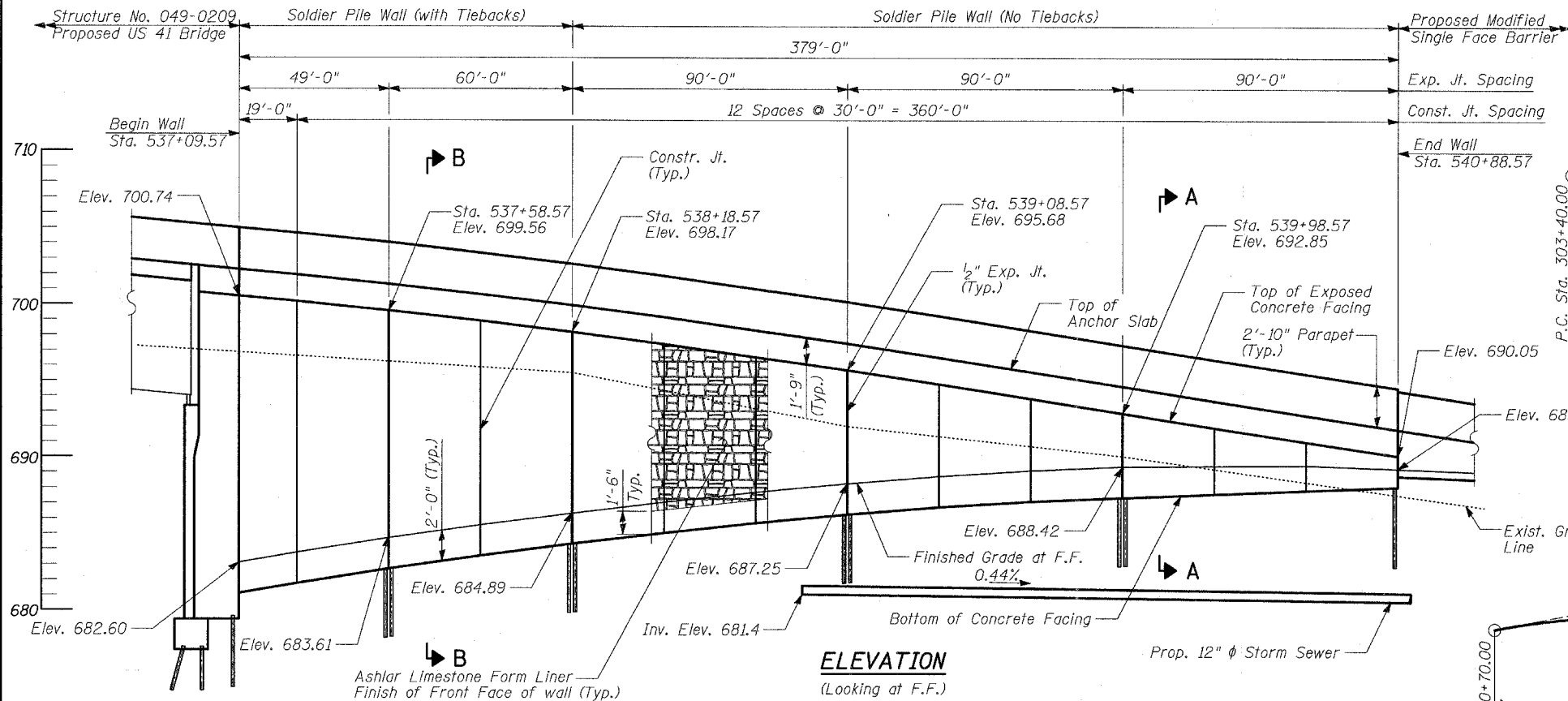

PROFILE GRADE RAMP C

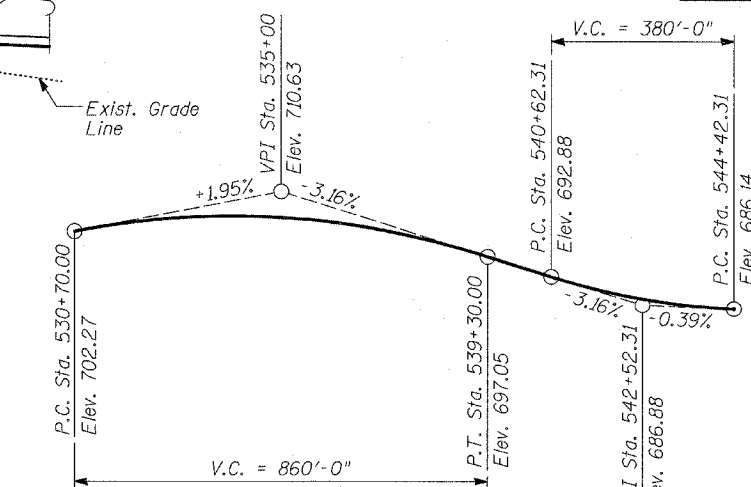

PROFILE GRADE U.S. 41 S.B.

DESIGN SPECIFICATIONS

2002 AASHTO Standard Specifications For Highway Bridges

DESIGN STRESSES

FIELD UNITS
 $f'_c = 3,500$ psi
 $f_y = 60,000$ psi (reinforcement)
 $f_y = 36,000$ psi (structural steel M270 Grade 36)
 $f'_s = 150,000$ psi (tie rods)

APPROVED
FOR STRUCTURAL ADEQUACY ONLY

Ralph E. Anderson
ENGINEER OF BRIDGES AND STRUCTURES



Signed *[Signature]*
Spiros Pantazis, S.E. II, Lic. No. 081-006448
For drawings 1 thru 21 of 21
Date 5/14/08

NOTES:

- Wall stations and offsets are given to the front face of the concrete facing, and are measured from US 41 SB Baseline.
- Existing utilities in conflict with soldier pile wall construction shall be abandoned or relocated according to direction given in roadway plans.
- Reinforcement bars shall conform to the requirements of ASTM A 706 Gr. 60 (IL Modified). See Special Provisions.
- Reinforcement bars designated (E) shall be epoxy coated.
- All exposed concrete edges shall be chamfered 3/4" except as noted.
- Slipforming of the parapet is not allowed.
- All construction joints shall be bonded.
- Soldier Pile Wall design can accommodate disturbance in front of wall for installation of proposed storm sewer. Lagging pay limits are to proposed bottom of C.I.P. concrete facing.

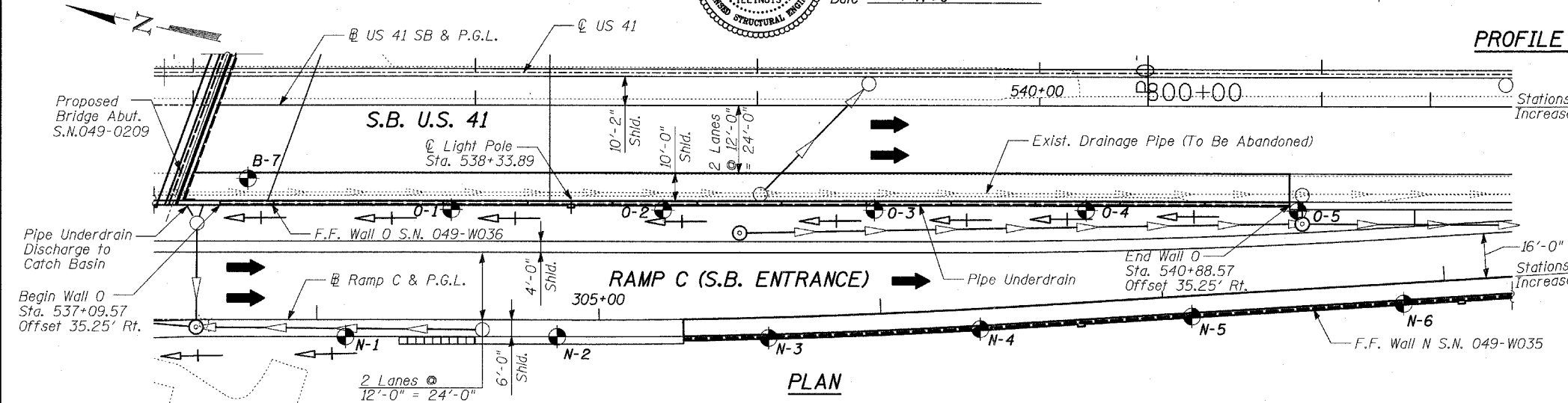
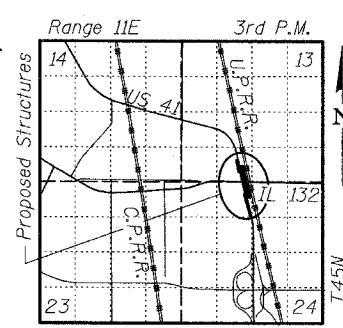

INDEX OF SHEETS

- WALL O GENERAL PLAN AND ELEVATION, STA 537+09.59 TO 540+88.57
- WALL O PLAN AND ELEVATION, STA 537+09.597 TO 537+58.57
- WALL O PLAN AND ELEVATION, STA 537+58.57 TO 538+18.57
- WALL O PLAN AND ELEVATION, STA 538+18.57 TO 539+08.57
- WALL O PLAN AND ELEVATION, STA 539+08.57 TO 539+98.57
- WALL O PLAN AND ELEVATION, STA 539+98.57 TO 540+88.57
- WALL O SECTIONS AND DETAILS - (1 OF 2)
- WALL O SECTIONS AND DETAILS - (2 OF 2)
- WALL O TIE BACK AND DEADMAN DETAILS
- WALL O ANCHORAGE SLAB AND PARAPET - (1 OF 3)
- WALL O ANCHORAGE SLAB AND PARAPET - (2 OF 3)
- WALL O ANCHORAGE SLAB AND PARAPET - (3 OF 3)
- WALL O MISCELLANEOUS DETAILS
- WALL O RUSTICATION DETAILS
- BORING LOG B-7 (1 OF 2)
- BORING LOG B-7 (2 OF 2)
- BORING LOG O-1
- BORING LOG O-2
- BORING LOG O-3
- BORING LOG O-4
- BORING LOG O-5

TYLIN INTERNATIONAL

DESIGNED	- MB
CHECKED	- CM/AD
DRAWN	- DE
CHECKED	- CM/AD

LEGEND

- ⊙ - Manhole
- - Catch Basin
- ⊕ - Soil Boring
- ▲— - Prop. Storm Sewer
- - Exist. Drain Pipe
- ▲— - Proposed Drainage Swale

WALL O GENERAL PLAN
STA 537+09.59 TO STA 540+88.57

FAP 346 (U.S. ROUTE 41 - SKOKIE HIGHWAY) OVER ILLINOIS ROUTE 132 SECTION 125X-HB-(1&2)R-1 LAKE COUNTY S.N. 049-W036