

STATE OF ILLINOIS
DEPARTMENT OF TRANSPORTATION

| | | | | |
|---------------------|---------|------------------|------------------|-----------|
| ROUTE NO. | SECTION | COUNTY | SHEET | SHEET NO. |
| 346 | * | LAKE | 469 | 316 |
| FED. ROAD DIST. NO. | | ILLINOIS | FED. AID PROJECT | |
| 125X-HB-(1&2) R-1 | | CONTRACT # 60826 | | |

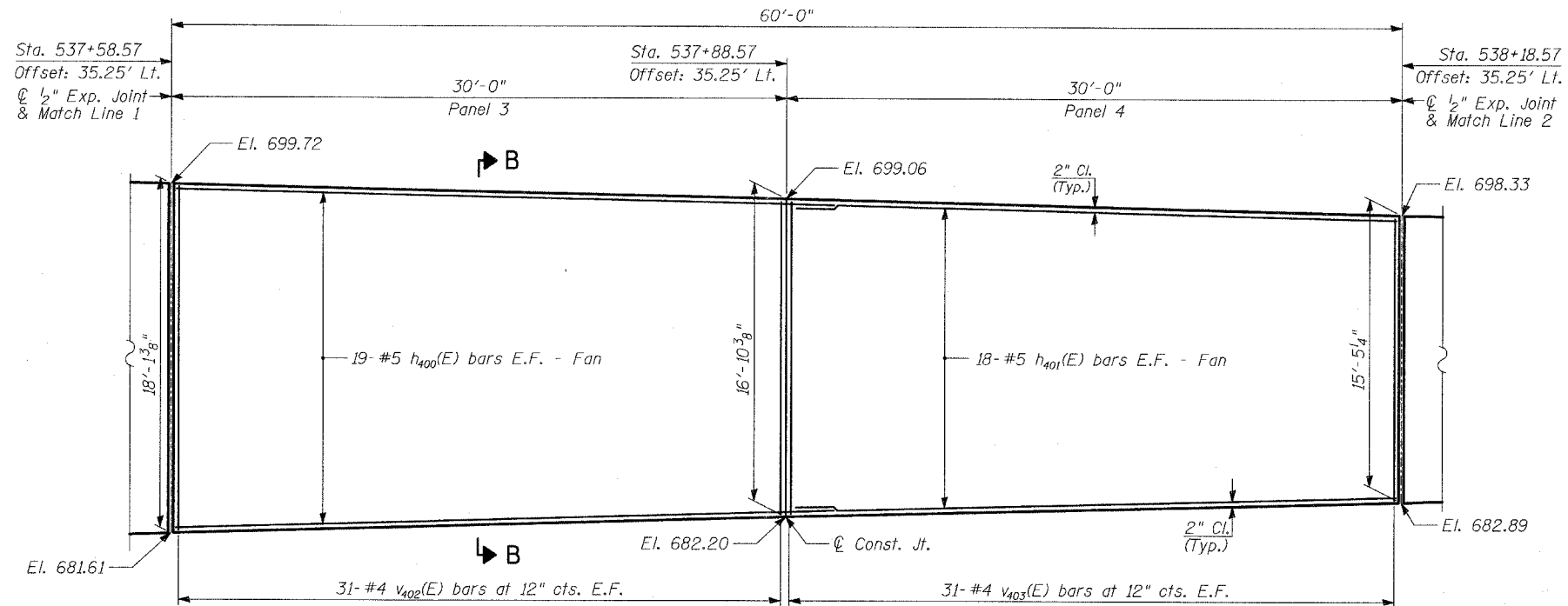

ELEVATION

(Offsets are Given From US41 SB Baseline to F.F. of Wall)

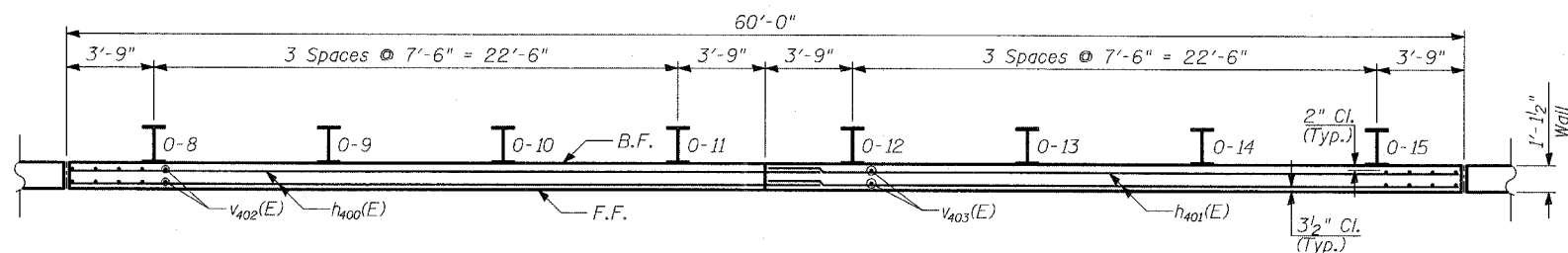

PLAN

PILE SUMMARY

| Pile Label | Pile Size | Length | Top of Pile Elevation | Bot. of Pile Elevation |
|------------|-----------|--------|-----------------------|------------------------|
| 0-8 | W18x119 | 33'-6" | 698.1 | 664.6 |
| 0-9 | W18x119 | 33'-6" | 698.0 | 664.5 |
| 0-10 | W18x119 | 33'-6" | 697.8 | 664.3 |
| 0-11 | W18x119 | 33'-6" | 697.6 | 664.1 |
| 0-12 | W18x119 | 32'-3" | 697.5 | 665.2 |
| 0-13 | W18x119 | 32'-3" | 697.3 | 665.0 |
| 0-14 | W18x119 | 32'-3" | 697.1 | 664.9 |
| 0-15 | W18x119 | 32'-3" | 696.9 | 664.7 |

TYLIN INTERNATIONAL

| | |
|----------|------|
| DESIGNED | - MB |
| CHECKED | - AD |
| DRAWN | - TB |
| CHECKED | - AD |

LAP SPLICES

| Bar | Lap |
|-----|-------|
| #4 | 1'-8" |
| #5 | 2'-2" |
| #6 | 2'-7" |
| #8 | 4'-6" |

NOTES:

1. B.F. - denotes Back Face.
2. E.F. - denotes Each Face.
3. F.F. - denotes Front Face.
4. Work this Sheet with Sheets 7 thru 14 of 21.
5. Pile spacing measured along front face of wall.
6. For Bill of Material, see Sheet 2 of 21.
7. For Section B-B, see Sheet 8 of 21.

WALL O
PLAN AND ELEVATION
STA 537+58.57 TO STA 538+18.57

FAP 346 (U.S. ROUTE 41 - SKOKIE
HIGHWAY) OVER ILLINOIS ROUTE 132
SECTION 125X-HB-(1&2)R-1
LAKE COUNTY
S.N. 049-W036