

STATE OF ILLINOIS
DEPARTMENT OF TRANSPORTATION

ROUTE NO.	SECTION	COUNTY	TOTAL SHEETS	SHEET NO.	SHEET NO. - 1
346	*	LAKE	469	2	2 SHEETS
FED. ROAD DIST. NO.	ILLINOIS	FED. AID PROJECT			
125X-HB-(1&2) R-1		CONTRACT # 60826			

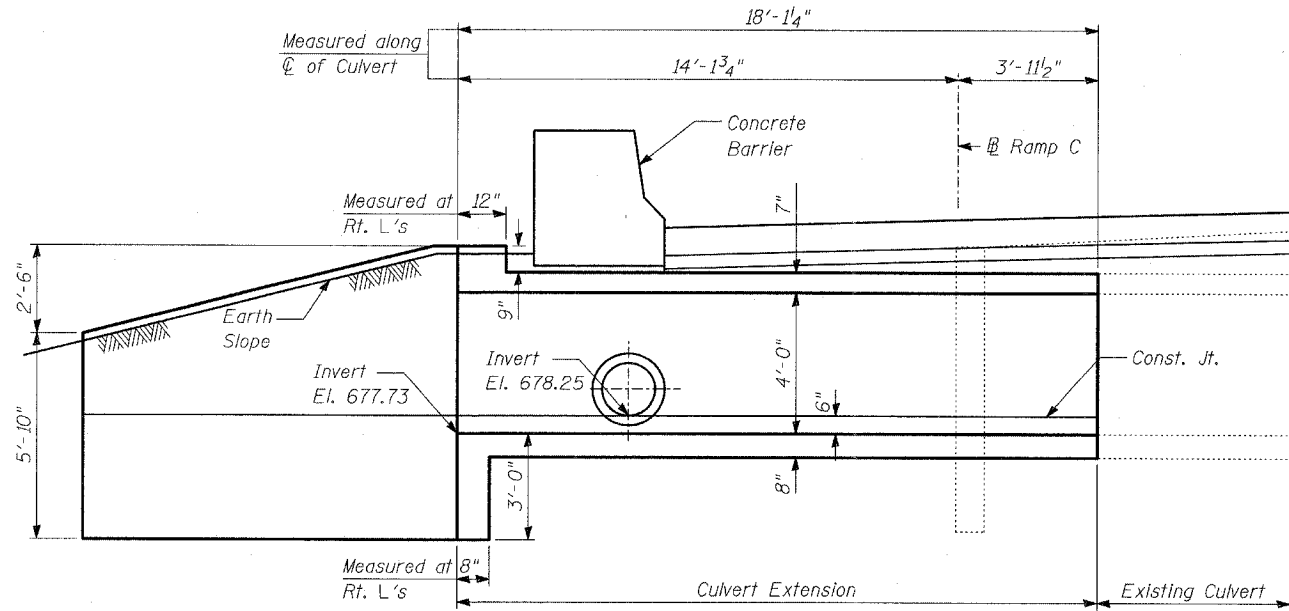

ELEVATION

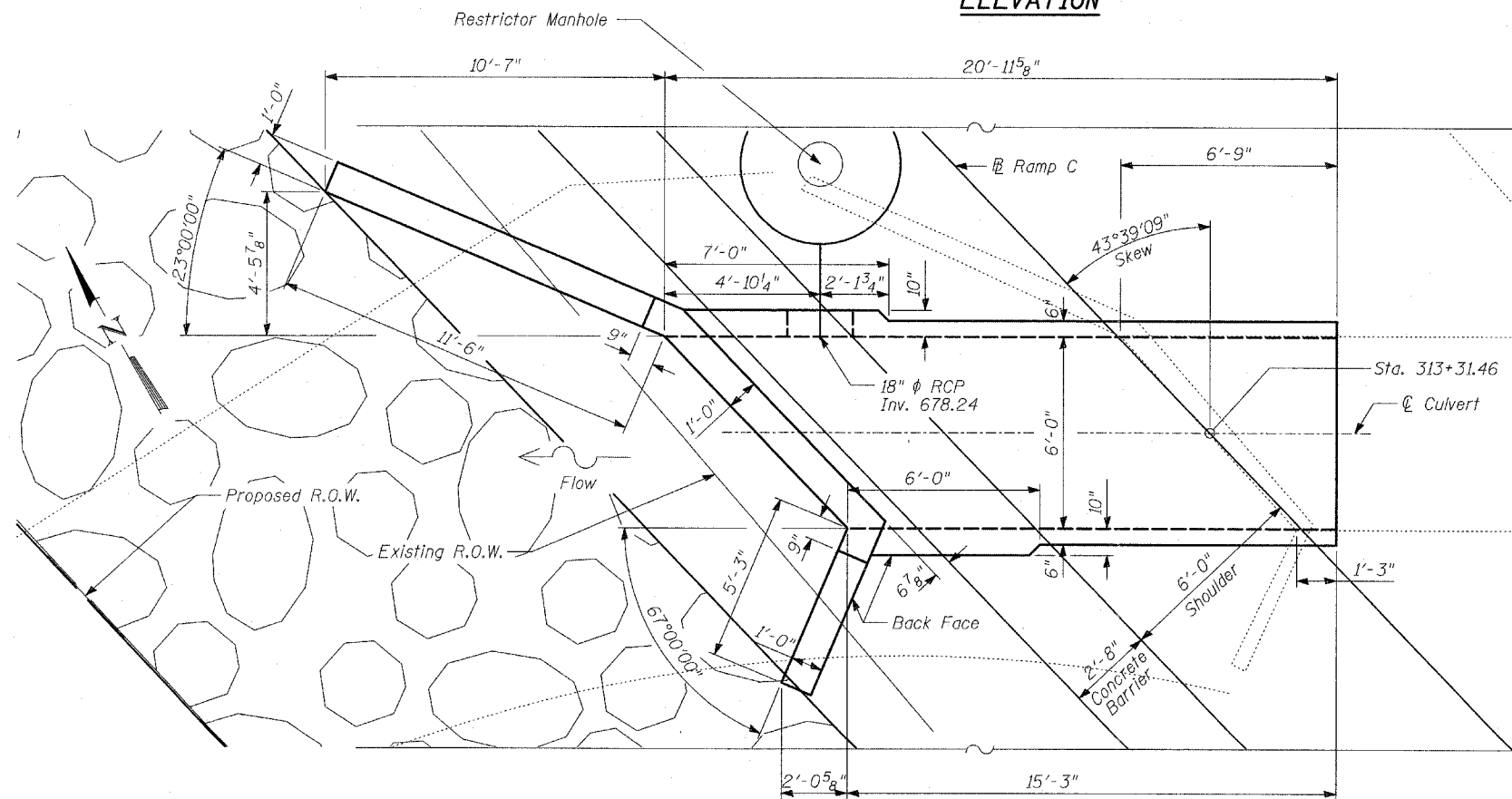

PLAN

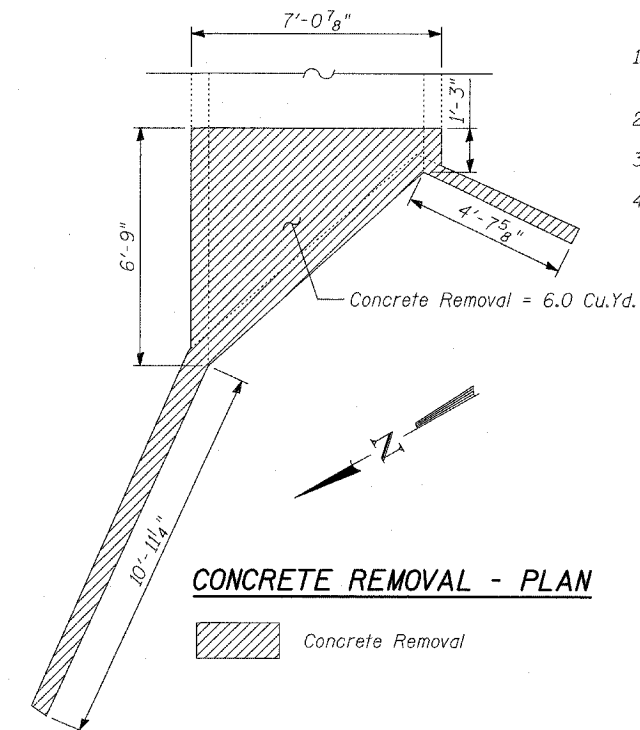

CONCRETE REMOVAL - PLAN

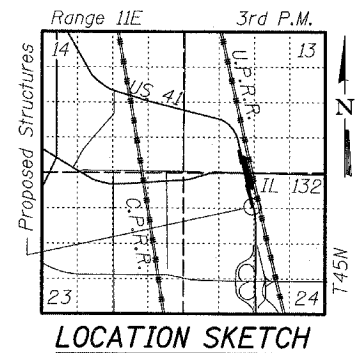

LOCATION SKETCH

TOTAL BILL OF MATERIAL

ITEM	UNIT	TOTAL
Concrete Removal	CU YD	6
Reinforcement Bars	POUND	2,520
Expansion Bolts 3/4"	EACH	16
Concrete Box Culverts	CU YD	15

LOADING HS20-44

Allow 50 psf for future wearing surface

DESIGN SPECIFICATIONS

2002 AASHTO Standard Specifications For Highway Bridges

DESIGN STRESSES

FIELD UNITS

$f'_c = 3,500$ psi
 $f_y = 60,000$ psi (reinforcement)

SEISMIC DATA

Seismic Performance Category (SPC) = A
Bedrock Acceleration Coefficient (A) = 0.035g
Site Coefficient (S) = 1.0

NOTES:

1. A distance of half the wingwall length, but not less than 6 feet of the barrel shall be poured monolithically with the wingwalls.
2. Reinforcement bars shall conform to the requirements of ASTM A 706 Gr. 60 (IL Modified). See Special Provisions.
3. All exposed concrete edges shall be chamfered 3/4" except as noted.
4. All construction joints shall be bonded.

TYLIN INTERNATIONAL

DESIGNED	- AD, MAF
CHECKED	- AD
DRAWN	- MAF
CHECKED	- AD



Signed *SP*
Spiros Pantazis, S.E. II, Lic. No. 081-006448
Chicago, Illinois
Expires 11-30-2008.
Date 5/14/08
For drawings 1 and 2 of 2

BOX CULVERT EXTENSION
STA. 313+31.46

FAP 346 (U.S. ROUTE 41 - SKOKIE
HIGHWAY) OVER ILLINOIS ROUTE 132
SECTION 125X-HB-(1&2)R-1
LAKE COUNTY