

F.A.P. RTE.	SECTION	COUNTY	TOTAL SHEETS	SHEET NO.
346	*	LAKE	469	425
STA.		TO STA.		
FED. ROAD DIST. NO.		ILLINOIS FED. AID PROJECT		
		• 125X-HB-(1&2) R-1		
REVISIONS		DATE		
NAME		6/17/06		
ANNA ZYSMAN				

DATE	BY

DATE	BY

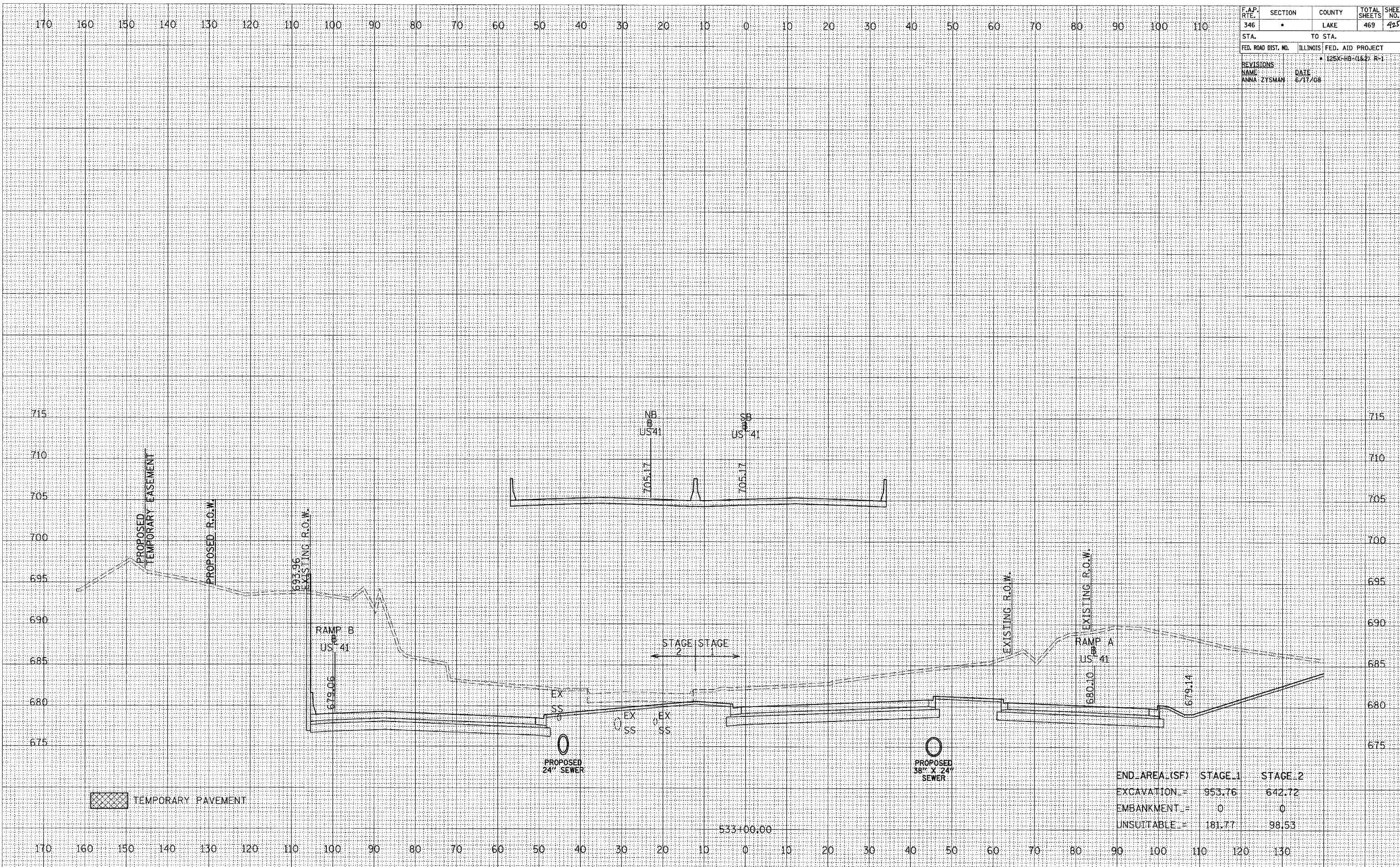

END_AREA_(SF)	STAGE_1	STAGE_2
EXCAVATION_	953.76	642.72
EMBANKMENT_	0	0
UNSUITABLE_	181.77	98.53