

F.A.P. RTE.	SECTION	COUNTY	TOTAL SHEETS	SHEET NO.
346	*	LAKE	469	499
STA.		TO STA.		
FED. ROAD DIST. NO.		ILLINOIS	FED. AID PROJECT	
			* 125X-HB-(1&2) R-1	
REVISIONS:				
NAME	DATE			
ANNA ZYSMAN	6/17/08			

DATE	BY
FINAL SURVEY	SURVEYED
NOTE BOOK	PLOTTED
NO.	DATE
	AREAS CHECKED

DATE	BY
ORIGINAL SURVEY	SURVEYED
NOTE BOOK	PLOTTED
NO.	DATE
	AREAS CHECKED

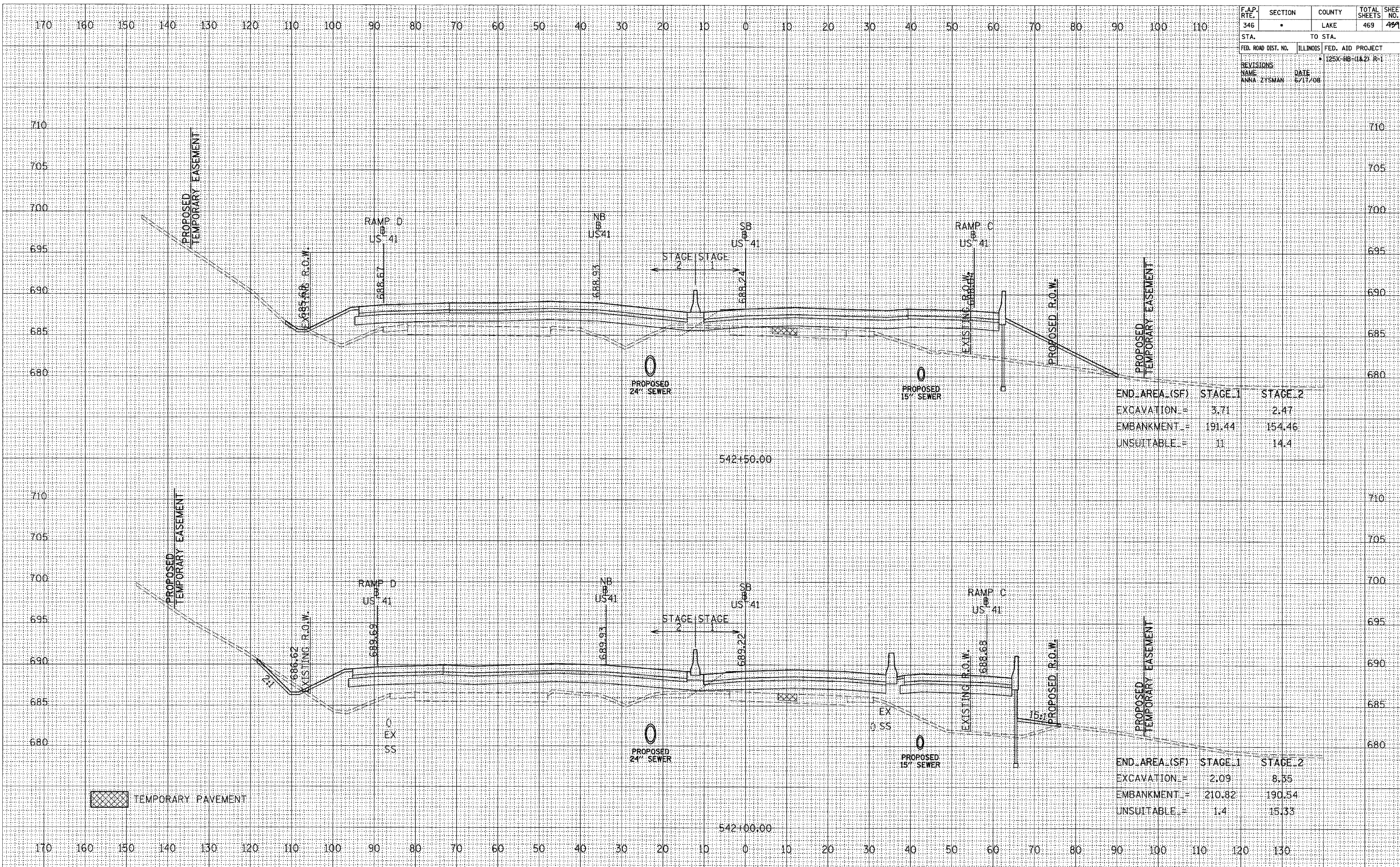

END AREA (SF)	STAGE 1	STAGE 2
EXCAVATION =	3.71	2.47
EMBANKMENT =	191.44	154.46
UNSUITABLE =	11	14.4

END AREA (SF)	STAGE 1	STAGE 2
EXCAVATION =	2.09	8.35
EMBANKMENT =	210.82	190.54
UNSUITABLE =	1.4	15.33

TEMPORARY PAVEMENT