

F.A.P. RTE.	SECTION	COUNTY	TOTAL SHEETS	SHEET NO.
346	•	LAKE	469	442
STA.		TO STA.		
FED. ROAD DIST. NO.		ILLINOIS	FED. AID PROJECT	
			• 125X-HB-(1&2) R-1	
REVISIONS:				
NAME	DATE			
ANNA ZYSMAN	6/17/08			

DATE	BY
DATE	BY
DATE	BY
DATE	BY
DATE	BY

DATE	BY
DATE	BY
DATE	BY
DATE	BY
DATE	BY

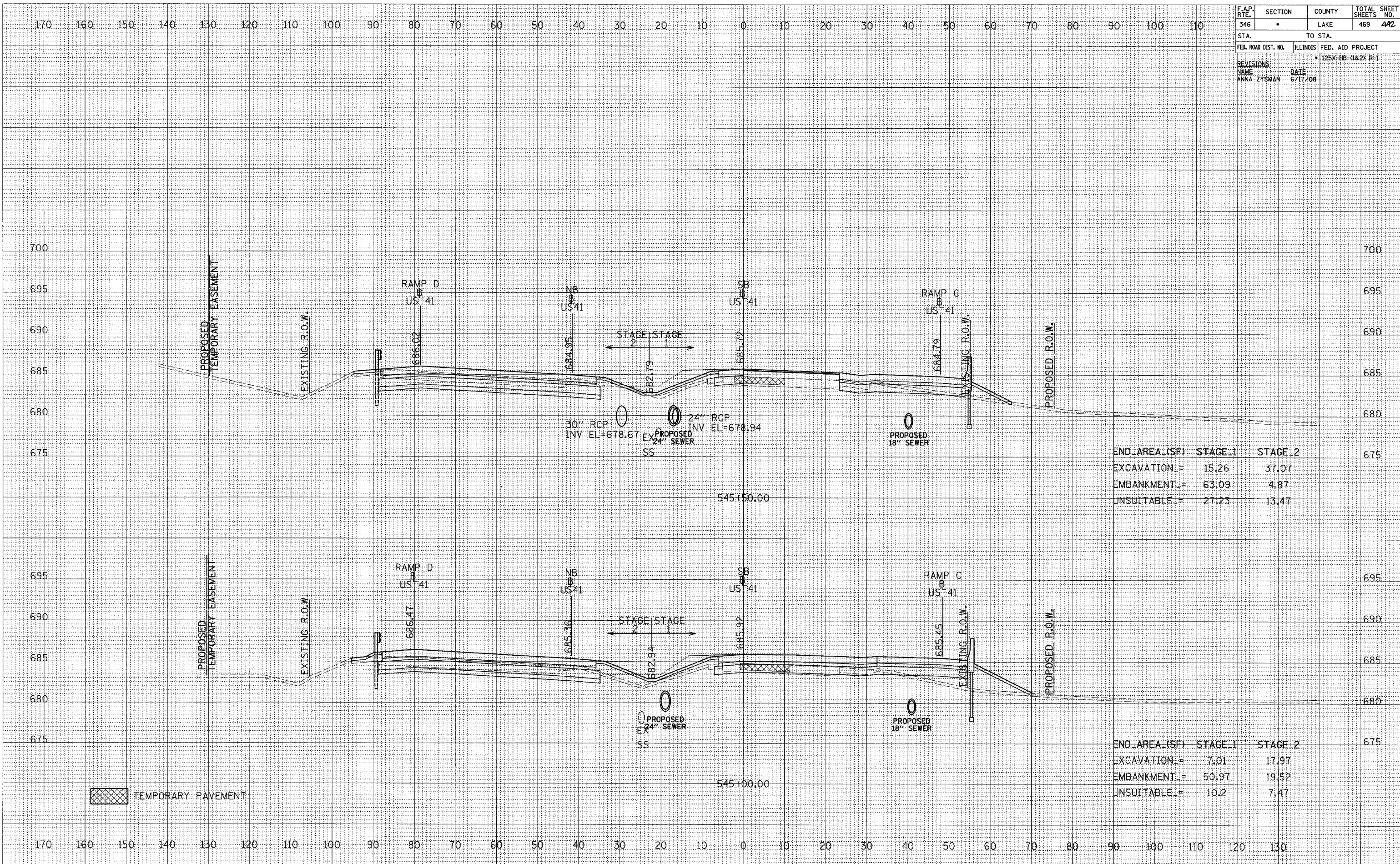

END AREA (SF)	STAGE 1	STAGE 2
EXCAVATION	15.26	37.07
EMBANKMENT	63.09	4.87
UNSUITABLE	27.23	13.47

END AREA (SF)	STAGE 1	STAGE 2
EXCAVATION	7.01	17.97
EMBANKMENT	50.97	19.52
UNSUITABLE	10.2	7.47

TEMPORARY PAVEMENT