

F.A.P. RTE. 346	SECTION •	COUNTY LAKE	TOTAL SHEETS 469	SHEET NO. 445
STA.		TO STA.		
FED. ROAD DIST. NO.		ILLINOIS FED. AID PROJECT		
REVISIONS		• (25X-HB-4&2) R-1		
NAME ANNA ZYSMAN	DATE 6/17/08			

DATE	BY
FINAL SURVEY	SURVEYED
NOTE BOOK	PLOTTED
NO.	DATE
	AREAS CHECKED

DATE	BY
ORIGINAL SURVEY	SURVEYED
NOTE BOOK	PLOTTED
NO.	DATE
	AREAS CHECKED

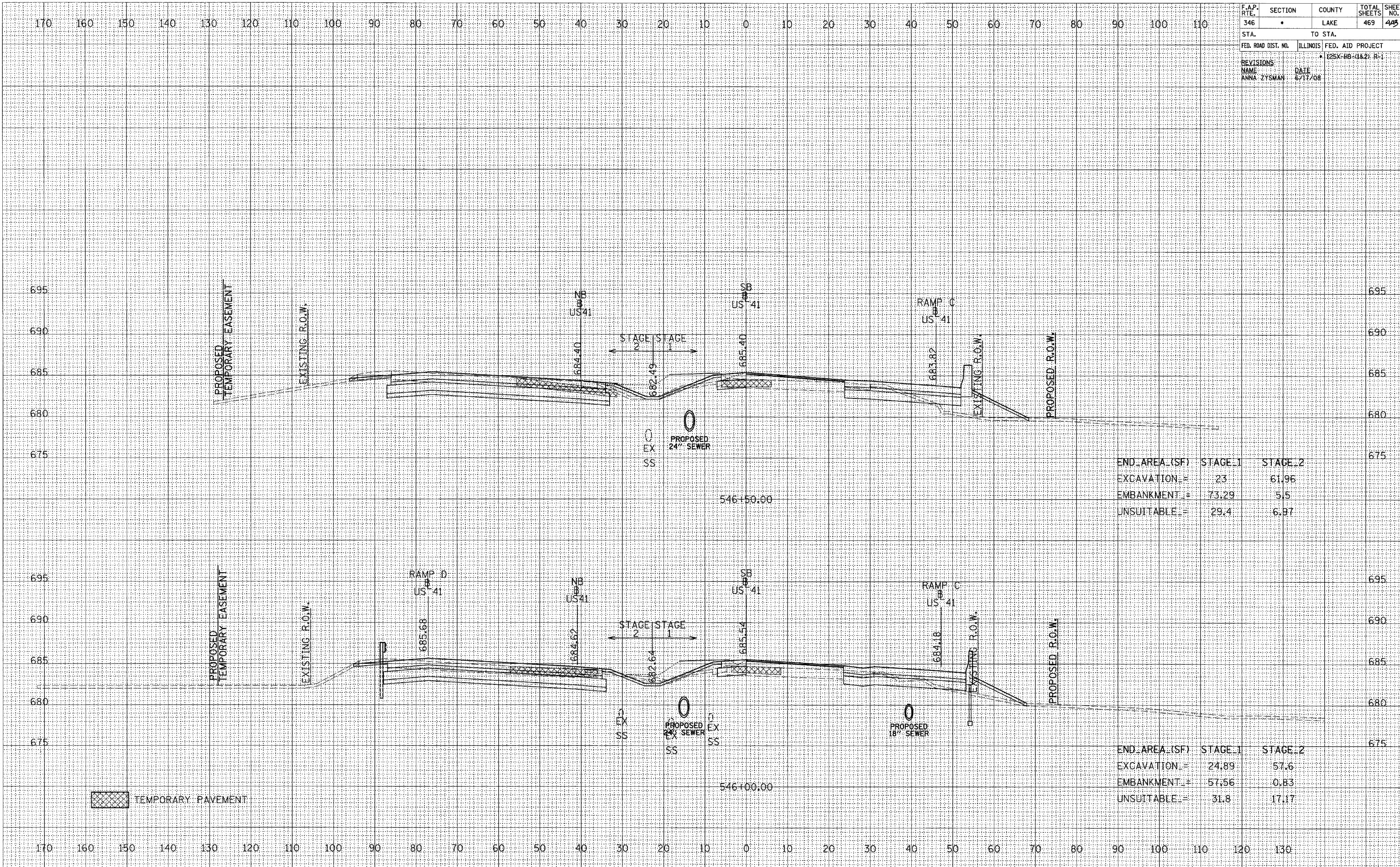

END AREA (SF)	STAGE 1	STAGE 2
EXCAVATION =	23	61.96
EMBANKMENT =	73.29	5.5
UNSUITABLE =	29.4	6.97

END AREA (SF)	STAGE 1	STAGE 2
EXCAVATION =	24.89	57.6
EMBANKMENT =	57.56	0.83
UNSUITABLE =	31.8	17.17

TEMPORARY PAVEMENT