

CONSTRUCTION SEQUENCE

PRESTAGE
CONSTRUCTION **TRAFFIC CONTROL**
 TEMPORARY PAVEMENT UTILIZE STANDARD 701201

STAGE 1
CONSTRUCTION **TRAFFIC CONTROL**
 NORTHBOUND DECK BEAM REPLACEMENT, BRIDGE APPROACH AND GUARDRAIL ONE-WAY TRAFFIC ON SOUTHBOUND LANE FROM STA. 817+40 TO STA. 824+81 UTILIZING STANDARD 701321

STAGE 2
CONSTRUCTION **TRAFFIC CONTROL**
 SOUTHBOUND DECK BEAM REPLACEMENT, BRIDGE APPROACH AND GUARDRAIL REMOVE TEMPORARY PAVEMENT ONE-WAY TRAFFIC ON NORTHBOUND LANE FROM STA. 817+86 TO STA. 824+68 UTILIZING STANDARD 701321

- Work area
- Sign
- Type III barricade
- Traffic signal
- Detector loops
- Impact attenuator
- Stop Bar 24-inch
- Drum with steady burning light (25' cts.)
- Temporary concrete barrier
- Temporary rumble strip (when specified)
- Double vertical panel (see detail)
- Crystal, bidirectional barrier wall/guardrail marker (25' cts.)

- Temporary Pavement
 HOT-MIX ASPHALT SURFACE COURSE, MIX "C", N50 1 1/2"
 HOT-MIX ASPHALT BINDER COURSE, IL-19.0, N50 8 1/2"
- ① Type III barricade to be placed when no work is being performed.
- ② Barrier wall/guardrail markers at 25' cts. See Standards 704001 & 635011.

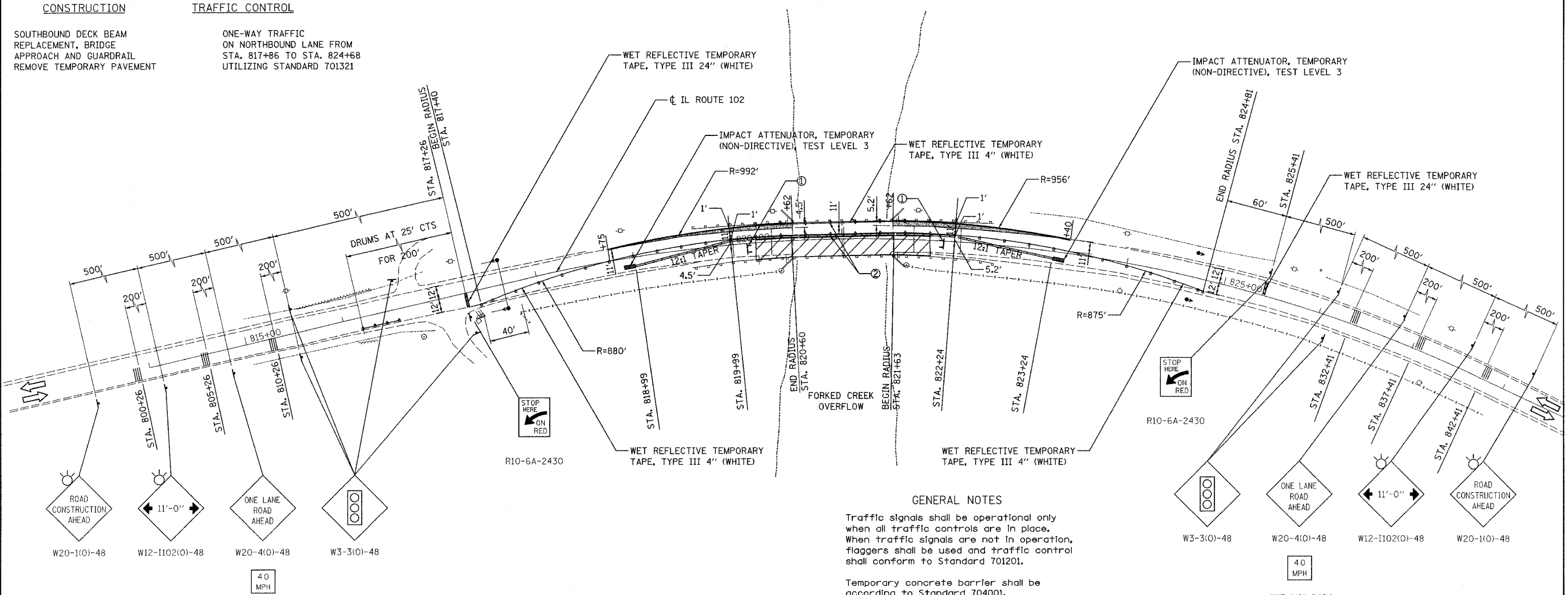

GENERAL NOTES

Traffic signals shall be operational only when all traffic controls are in place. When traffic signals are not in operation, flaggers shall be used and traffic control shall conform to Standard 701201.

Temporary concrete barrier shall be according to Standard 704001.

When existing pavement markings and raised pavement markers are in conflict with the traffic control and protection plan, existing pavement marking and raised pavement markers shall be removed and paid for as pavement marking removal or as raised reflective pavement marking removal.

FILE NAME = m:\p\0\3329\3329_21.dwg; Design\Proposed\plan\3329_21.mxd

Ciorba Group, Inc.
 CONSULTING ENGINEERS
 5607 North Cumberland Avenue, Suite 402
 Chicago, Illinois 60656
 Tel: 773.775.4009 Fax: 773.775.4014

USER NAME = rdenney	DESIGNED - DMM	REVISED -
PLOT SCALE = 50.0000' / IN.	DRAWN - DMM	REVISED -
PLOT DATE = 5/15/2008	CHECKED - MJL	REVISED -
	DATE - 05/13/2008	REVISED -

STATE OF ILLINOIS
DEPARTMENT OF TRANSPORTATION

FAP 631 / ILLINOIS ROUTE 102
ILLINOIS ROUTE 102 OVER FORKED CREEK OVERFLOW
TRAFFIC CONTROL AND PROTECTION - STAGE 1

SCALE: 1"=50' SHEET NO. OF SHEETS STA. TO STA.

F.A.P. RTE.	SECTION	COUNTY	TOTAL SHEETS	SHEET NO.
631	111N-1 B	WILL	32	7
FED. ROAD DIST. NO. ILLINOIS FED. AID PROJECT			CONTRACT NO. 60D85	