

**CONSTRUCTION SEQUENCE**

CONSTRUCTION	TRAFFIC CONTROL
<b>PRESTAGE</b>	
TEMPORARY PAVEMENT	UTILIZE STANDARD 701201
<b>STAGE 1</b>	
NORTHBOUND DECK BEAM REPLACEMENT, BRIDGE APPROACH AND GUARDRAIL	ONE-WAY TRAFFIC ON SOUTHBOUND LANE FROM STA. 817+40 TO STA. 824+81 UTILIZING STANDARD 701321
<b>STAGE 2</b>	
SOUTHBOUND DECK BEAM REPLACEMENT, BRIDGE APPROACH AND GUARDRAIL REMOVE TEMPORARY PAVEMENT	ONE-WAY TRAFFIC ON NORTHBOUND LANE FROM STA. 817+86 TO STA. 824+68 UTILIZING STANDARD 701321

- Work area
- Sign
- Type III barricade
- Traffic signal
- Detector loops
- Impact attenuator
- Stop Bar 24-inch
- Drum with steady burning light (25' cts.)
- Temporary concrete barrier
- Temporary rumble strip (when specified)
- Double vertical panel (see detail)
- Crystal, bidirectional barrier wall/guardrail marker (25' cts.)

- Temporary Pavement  
HOT-MIX ASPHALT SURFACE COURSE, MIX "C", N50 1 1/2"  
HOT-MIX ASPHALT BINDER COURSE, IL-19.0, N50 8 1/2"
- ① Type III barricade to be placed when no work is being performed.
- ② Barrier wall/guardrail markers at 25' cts. See Standards 704001 & 635011.

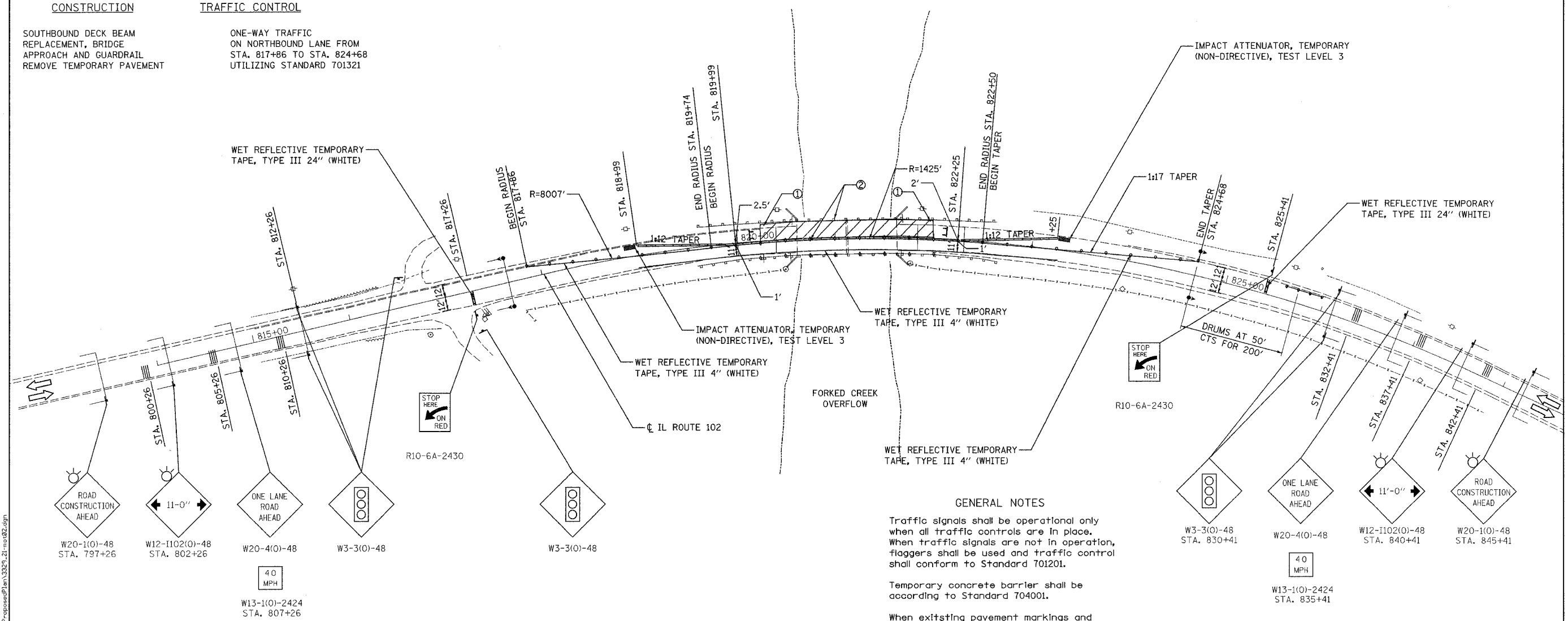

**GENERAL NOTES**

Traffic signals shall be operational only when all traffic controls are in place. When traffic signals are not in operation, flaggers shall be used and traffic control shall conform to Standard 701201.

Temporary concrete barrier shall be according to Standard 704001.

When existing pavement markings and raised pavement markers are in conflict with the traffic control and protection plan, existing pavement marking and raised pavement markers shall be removed and paid for as pavement marking removal or as raised reflective pavement marking removal.

FILE NAME = n:\p\631\322\322.dwg, 21:10:02.dgn

**Ciorba Group, Inc.**  
CONSULTING ENGINEERS  
5507 North Cumberland Avenue, Suite 402  
Chicago, Illinois 60656  
Tel. 773.775.4009 Fax 773.775.4014

USER NAME = rdenley	DESIGNED - DMM	REVISED -
PLOT SCALE = 50.0000' / IN.	DRAWN - DMM	REVISED -
PLOT DATE = 5/15/2008	CHECKED - MJL	REVISED -
DATE - 05/13/2008	DATE -	REVISED -

**STATE OF ILLINOIS  
DEPARTMENT OF TRANSPORTATION**

**FAP 631 / ILLINOIS ROUTE 102  
ILLINOIS ROUTE 102 OVER FORKED CREEK OVERFLOW  
TRAFFIC CONTROL AND PROTECTION - STAGE 2**

SCALE: SHEET NO. OF SHEETS STA. TO STA.

F.A.P. RTE.	SECTION	COUNTY	TOTAL SHEETS	SHEET NO.
631	111N-1 B	WILL	32	8
FED. ROAD DIST. NO. ILLINOIS FED. AID PROJECT			CONTRACT NO. 60D85	