

1. IDOT, KANE COUNTY HIGHWAY DEPARTMENT AND THE VILLAGE OF ALGONQUIN SHALL BE NOTIFIED 72 HOURS PRIOR TO PUTTING THE DETOUR IN EFFECT AND IMMEDIATELY AFTER THE DETOUR HAS BEEN REMOVED.
2. THE CONTRACTOR SHALL FURNISH, INSTALL, MAINTAIN AND REMOVE ALL TEMPORARY SIGN SUPPORTS. THE CONTRACTOR SHALL PATCH HOLES (IF ANY) AND RESTORE THE GROUND TO ITS ORIGINAL CONDITION AND ELEVATION.
3. ALL SIGNS, SUPPORTS AND POSITIONING SHALL BE IN ACCORDANCE WITH THE ILLINOIS MANUAL ON UNIFORM TRAFFIC CONTROL DEVICES, LATEST EDITION.
4. ALL EXISTING SIGNS THAT CONFLICT WITH THE DETOUR SHALL BE COVERED.
5. EACH TYPE III BARRICADE SHALL BE EQUIPED WITH TWO FLASHING AMBER LIGHTS.
6. THE CONTRACTOR SHALL ERECT SIGN NO. 15 AT LEAST 48 HOURS IN ADVANCE OF THE CLOSURE.
7. ALL ENTRANCES AND SIDE STREETS ON THE CLOSED IL ROUTE 31 MUST BE OPEN FOR LOCAL TRAFFIC DURING THE ENTIRE CONSTRUCTION PERIOD.

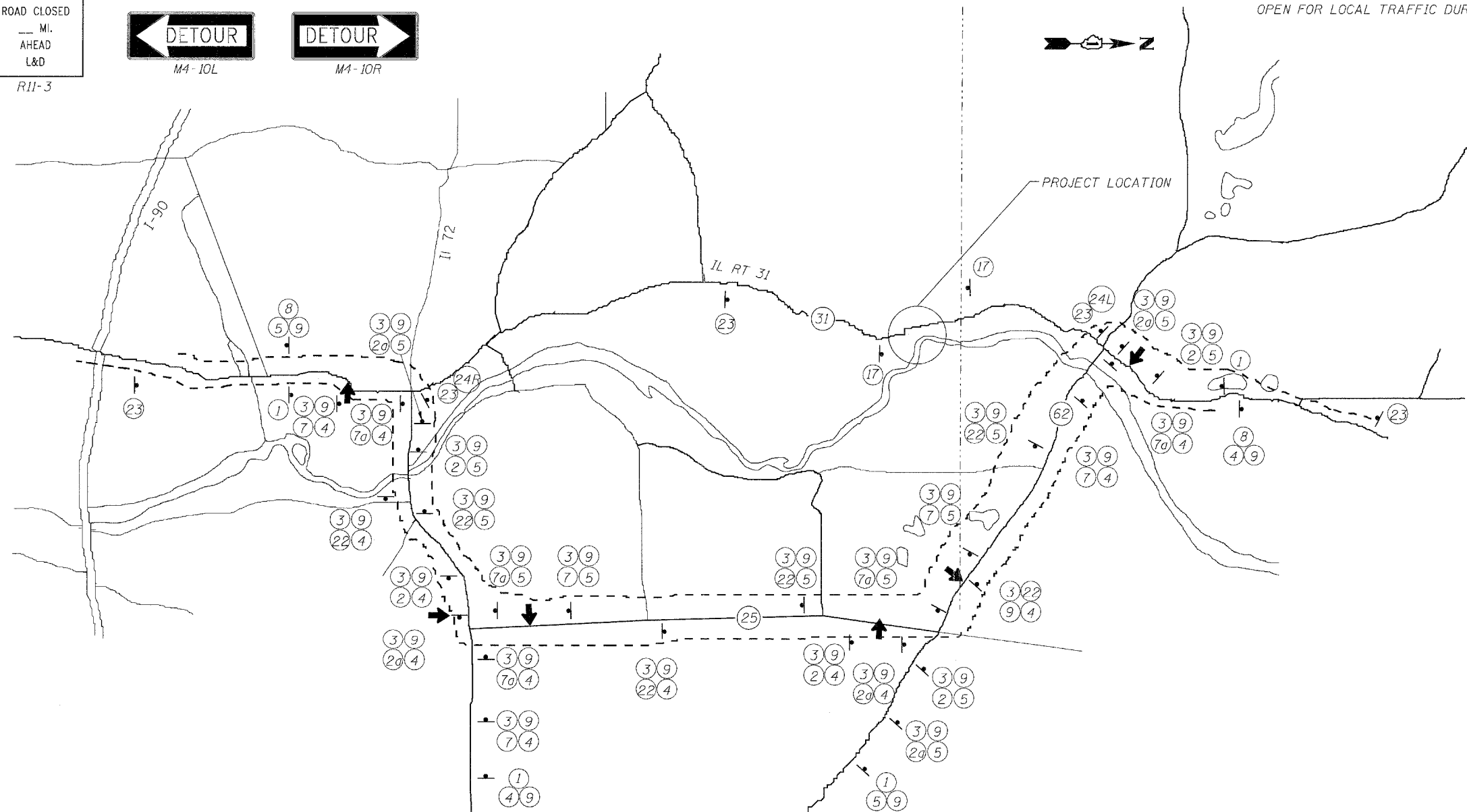

**LEGEND**

- DETOUR ROUTE
- DETOUR GUIDE SIGN ASSEMBLY
- ← CHANGABLE MESSAGE SIGN