

Engineering Enterprises, Inc.

F.A. RTE.	SECTION	COUNTY	TOTAL SHEETS	SHEET NO.
N/A	06-00017-00-PV	KANE	232	71
STA.		TO STA.		
FED. ROAD DIST. NO.		ILLINOIS FED. AID PROJECT		

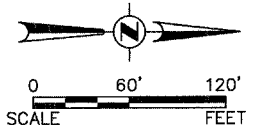

- WORK AREA
- TRAFFIC CONTROL DRUM W/ STEADY BURN AMBER LIGHT
- SIGN
- TYPE 3 BARRICADE
- DIRECTIONAL INDICATOR BARRICADE
- ARROW BOARD

PLAN	SURVEYED	DATE
	PLOTTED	
	NOTED	
	RT. OF WAY CHECKED	
	CADD FILE NAME	
	NO.	

PROFILE	SURVEYED	DATE
	PLOTTED	
	NOTED	
	STRUCTURE NOTATION CHECKED	
	NO.	

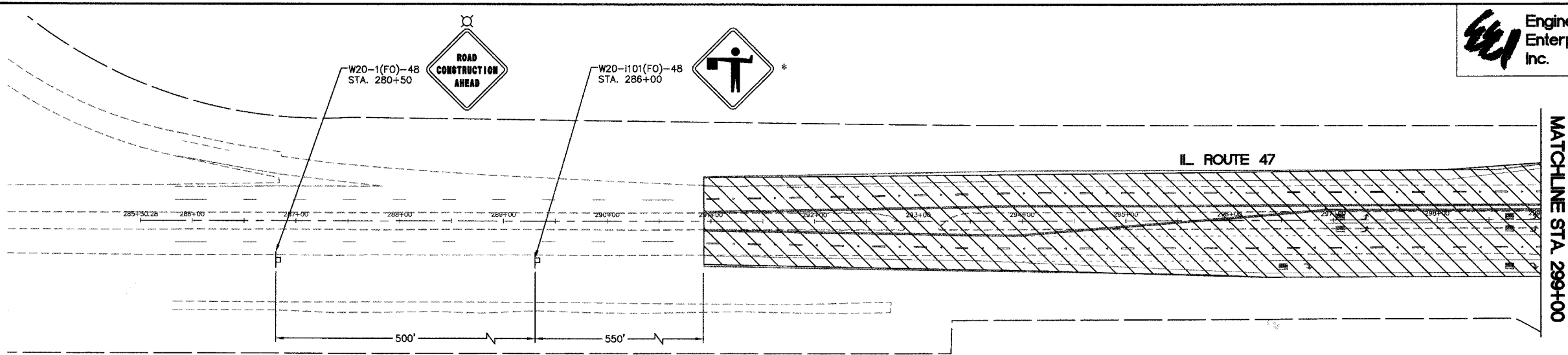

* FLAGGER SIGNS SHALL ONLY BE IN PLACE WHILE WORKERS ARE PRESENT (TYP.)

MATCHLINE STA. 299+00

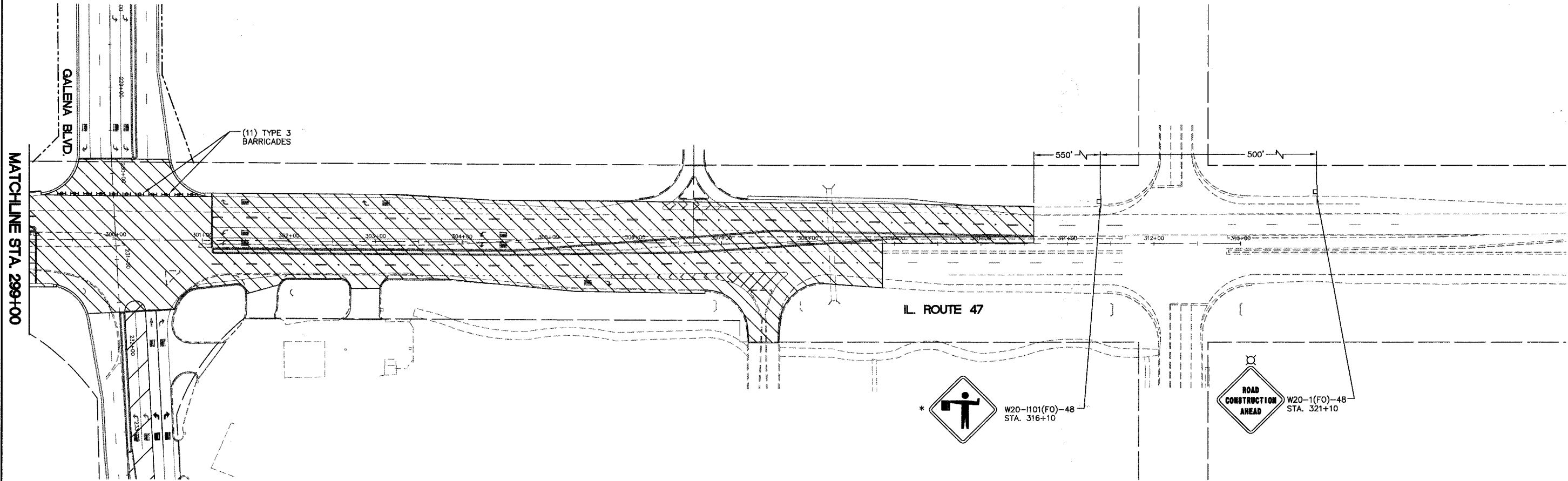

WORK ITEMS

- REMOVE CONFLICTING TEMPORARY PAVEMENT MARKINGS
- MILL AND OVERLAY IL. ROUTE 47.
- PERMANENT PAVEMENT MARKINGS.

STAGE 4A: IL. ROUTE 47 AND GALENA BOULEVARD

NOTES:

1. SEE IDOT STANDARD 701606-05 FOR DETAILS ON DAYTIME LANE CLOSURES.
2. PAVEMENT JOINTS ARE TO BE CONSISTENT WITH FUTURE LANE LINES PER ARTICLE 406.06(g) OF THE STANDARD SPECIFICATIONS.
3. BUTT JOINTS SHALL NOT REMAIN EXPOSED TO TRAFFIC OVER NIGHT. MILLED OR UNFINISHED SURFACES WILL REQUIRE A 40(H) : 1(V) TEMPORARY RAMP PER ARTICLE 406.08 OF THE STANDARD SPECIFICATIONS.
4. TO BE COMPLETED WITH STAGE 4 GALENA BOULEVARD.

REVISIONS	
NAME	DATE

ILLINOIS DEPARTMENT OF TRANSPORTATION

ILLINOIS ROUTE 47 AND GALENA BOULEVARD TRAFFIC CONTROL AND STAGING PLAN

SCALE: 1" = 60'
DATE: 02/07/08

DRAWN BY:
CHECKED BY: WBR