

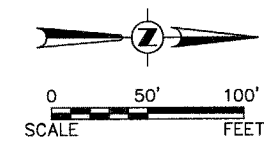

F.A. RTE.	SECTION	COUNTY	TOTAL SHEETS	SHEET NO.
N/A	06-00017-00-PV	KANE	232	132
STA.	TO STA.			
FED. ROAD DIST. NO.		ILLINOIS	FED. AID PROJECT	



PLAN	DATE
BY	
NO.	
NO.	
NO.	
NO.	
NO.	
NO.	
NO.	
NO.	

PROFILE	DATE
BY	
NO.	
NO.	
NO.	
NO.	
NO.	
NO.	
NO.	
NO.	

MATCHLINE B-B

MATCHLINE C-C

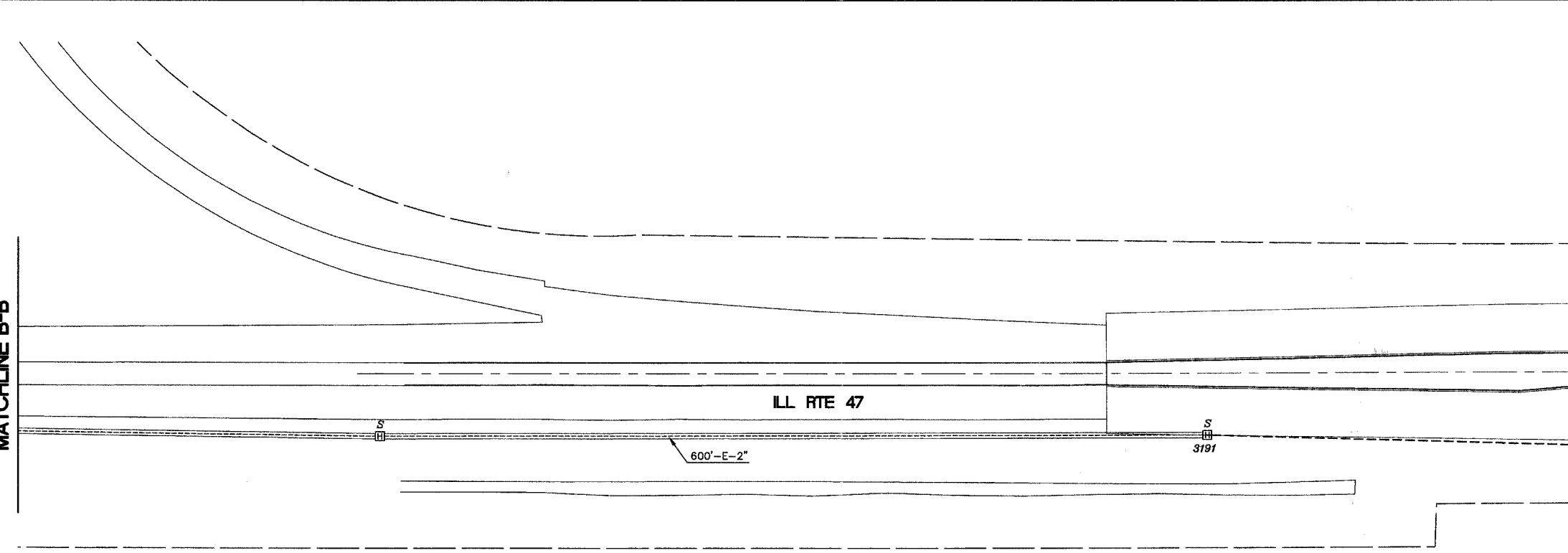

INTERCONNECT PLAN LEGEND

EXISTING	PROPOSED	
		CONTROLLER
		HANDHOLE
		DOUBLE HANDHOLE
		HEAVY-DUTY HANDHOLE
		G.S. CONDUIT IN TRENCH OR PUSHED
		DETECTOR LOOP
		COMMON TRENCH
		UNIT DUCT
		SYSTEM
		INTERSECTION
		TELEPHONE
		TEMPORARY WOOD POLE (CLASS 5 OR BETTER) 45 FOOT (13.7m MIN.)

MATCHLINE C-C

MATCHLINE D-D

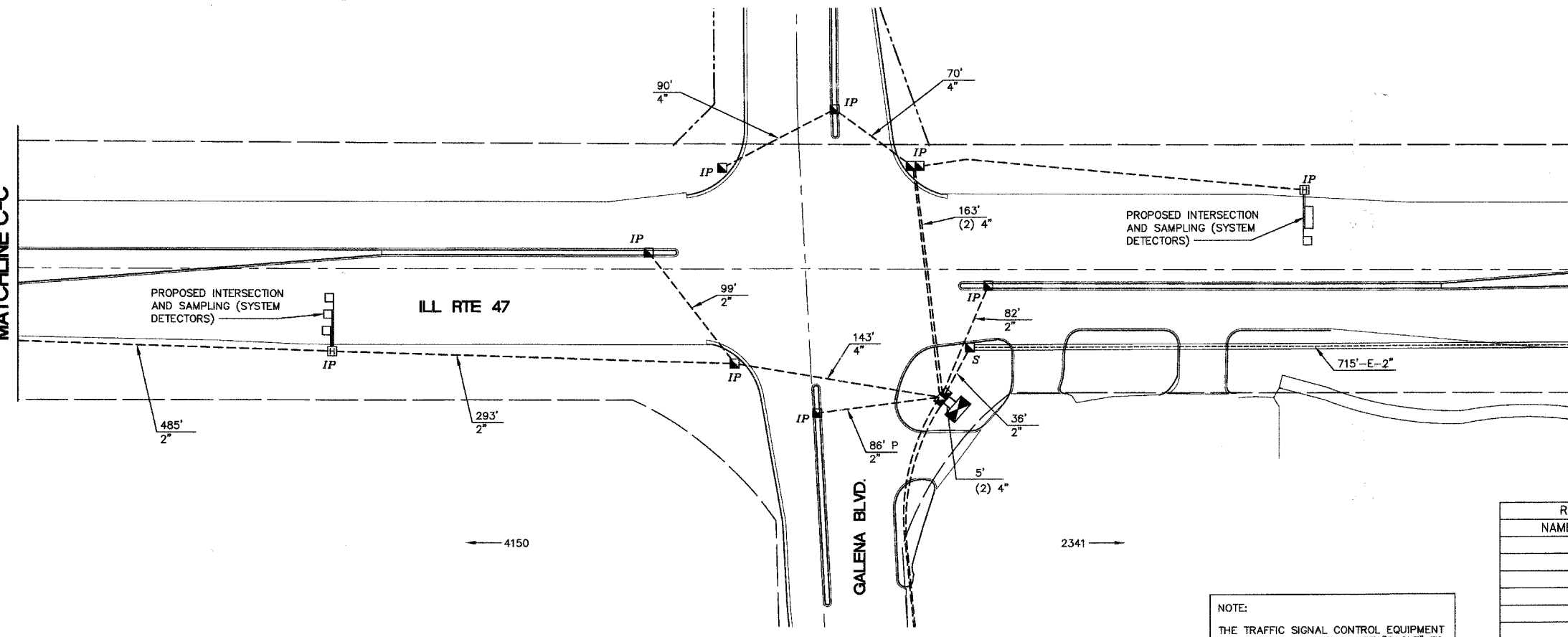

NOTE:
THE TRAFFIC SIGNAL CONTROL EQUIPMENT FOR THIS PROJECT SHALL BE "EAGLE" TO MATCH THE EXISTING ADJACENT SYSTEM.

REVISIONS	
NAME	DATE

ILLINOIS DEPARTMENT OF TRANSPORTATION

INTERCONNECT PLAN
ILL RTE 47 FROM
GALENA BOULEVARD TO
BLISS RD./WHEELER RD.
(2 OF 3)

SCALE: 1" = 50'
DATE: 05/16/08

DRAWN BY: KKP
CHECKED BY: TVW