

F.A.U. RYE.	SECTION	COUNTY	TOTAL SHEETS	SHEET NO.
2316	06-00041-00-RS	KANE	15	11

CONTRACT NO. 63042

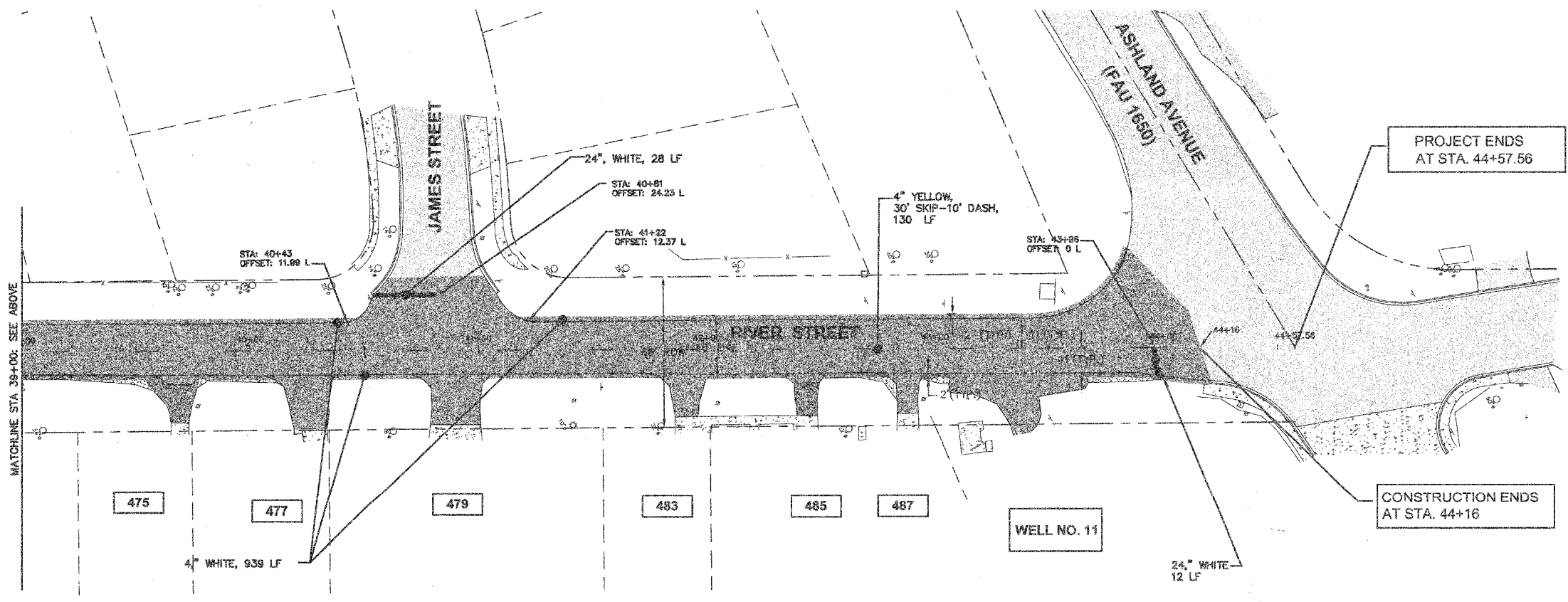
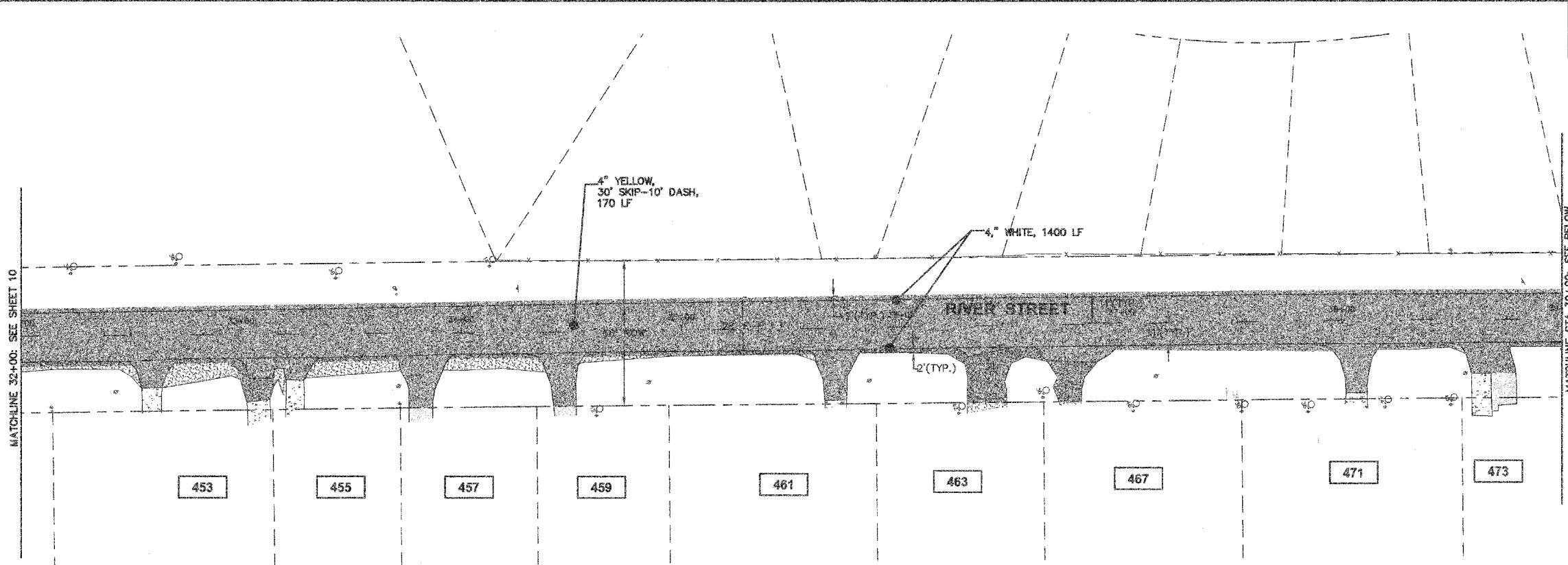
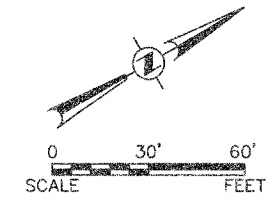

RESURFACING

NOTES:

- 1.) ALL PAVEMENT MARKINGS ARE TO BE THERMOPLASTIC

Plotted: May 2, 2008 @ 11:46 AM By: Britney Milecik - Tab: 11 Strip: 22x34

COPYRIGHT © 2008 ENGINEERING ENTERPRISES, INC.

**Engineering Enterprises, Inc.**  
 CIVIL ENGINEERS & LAND SURVEYORS  
 52 Wheeler Road  
 Sugar Grove, Illinois 60554  
 Phone: (630) 466-9350

**VILLAGE OF MONTGOMERY**  
 1300 SOUTH BROADWAY  
 MONTGOMERY, ILLINOIS 60538

NO.	DATE	REVISIONS
1	4/22/08	PER IDOT REVIEW

**RIVER STREET LAPP IMPROVEMENTS**

**PAVEMENT MARKING DETAILS**

DATE:	FEBRUARY 2008
PROJECT NO.:	M00761-V
FILE NO.:	M00761-PLAN
SHEET	<b>11</b> OF <b>15</b>

Path: H:\SS\PROJ\M00761\DWG\FINAL\ENC\M00761-PLAN