

F.A.S. RTE.	SECTION	COUNTY	TOTAL SHEETS	SHEET NO.
203	11BR-1	*	43	1

* WHITESIDE & ROCK ISLAND

44

PROJECT ENGINEER
BECKY MARRUFFO

SQUAD LEADER
THOMAS HALLA 815-284-5993

INDEX OF SHEETS

1. COVER SHEET
2. GENERAL NOTES
- 3.-4. SUMMARY OF QUANTITIES
5. TYPICAL SECTIONS
6. VERTICAL AND HORIZONTAL CONTROL
- 7.-8. SCHEDULE OF QUANTITIES
- 9.-10. PLAN AND PROFILE Moline ROAD
11. TRAFFIC CONTROL PLAN
- 12.-20. STRUCTURE PLANS
- 21.-22. SOIL BORINGS
- 23.-31. EXISTING BRIDGE PLANS (FOR INFORMATION ONLY)
32. CONCRETE HEADWALLS FOR PIPE DRAINS (27.4)
- DELINATOR AND POST ORIENTATION (37.4)
- TYPICAL BENCHING ON EXISTING EMBANKMENT (50.4)
33. DRAIN FOR AGGREGATE BASE COURSE (96.4)
34. EROSION CONTROL DETAILS FOR SILT FENCE (29.2)
- WITNESS MARKER & PERMANENT SURVEY MARKERS, TYPE II (66.2)
- 34A. STEEL PLATE BEAM GUARD RAIL, TYPE A (SPECIAL) (52.1)
35. TRAFFIC CONTROL FOR ROAD CLOSURE (40.1)
36. DETAILS OF PLANTING AND BRACING TREES (92.1)
- 37.-43. CROSS SECTIONS

HIGHWAY STANDARDS

- | | |
|-----------|---|
| 000001-05 | STANDARD SYMBOLS, ABBREVIATIONS AND PATTERNS |
| 001001-01 | AREA OF REINFORCEMENT BARS |
| 280001-04 | TEMPORARY EROSION CONTROL SYSTEMS |
| 420001-07 | PAVEMENT JOINTS |
| 420401-06 | BRIDGE APPROACH PAVEMENT |
| 421001-02 | BAR REINFORCEMENT FOR CRC PAVEMENT |
| 515001-02 | NAME PLATE FOR BRIDGES |
| 542401 | METAL END SECTION FOR PIPE CULVERTS |
| 601101 | CONCRETE HEADWALL FOR PIPE DRAINS |
| 630001-07 | STEEL PLATE BEAM GUARDRAIL |
| 630301-04 | SHOULDER WIDENING FOR TYPE 1 (SPECIAL) GUARDRAIL TERMINALS |
| 631031-06 | TRAFFIC BARRIER TERMINAL, TYPE 6 |
| 635001 | DELINEATORS |
| 635006-02 | REFLECTOR AND TERMINAL MARKER PLACEMENT |
| 635011-01 | REFLECTOR MARKER AND MOUNTING DETAILS |
| 667101 | PERMANENT SURVEY MARKERS |
| 701311-02 | LANE CLOSURE, 2L, 2W, MOVING OPERATIONS-DAY ONLY |
| 701901 | TRAFFIC CONTROL DEVICES |
| 720011 | METAL POSTS FOR SIGNS, MARKERS AND DELINEATORS |
| 728001 | TELESCOPING STEEL SIGN SUPPORT |
| 729001 | APPLICATIONS OF TYPES A & B METAL POSTS (FOR SIGNS & MARKERS) |
| 780001-01 | TYPICAL PAVEMENT MARKINGS |

STATE OF ILLINOIS
DEPARTMENT OF TRANSPORTATION
DIVISION OF HIGHWAYS
**PLANS FOR PROPOSED
FEDERAL AID HIGHWAY**
FAS ROUTE 203 (MOLINE ROAD)
SECTION 11BR-1
OVER MEREDOSIA DITCH
WHITESIDE AND ROCK ISLAND COUNTIES
PROJECT NO. ACBRS-0203(106)

C-92-088-06

R. 3 E. 4th P.M.

TRAFFIC DATA

HIGHWAY CLASSIFICATION: MAJOR COLLECTOR
2008 ADT = 3100
DESIGN SPEED 55 MPH
POSTED SPEED 55 MPH

SECTION 115BR-1
INCLUDES THE REMOVAL OF EXISTING
STRUCTURE NO. 098-0003 AND
CONSTRUCTION OF THE NEW
STRUCTURE 098-0111, A THREE SPAN
STRUCTURE OVER MEREDOSIA DITCH
AT STA 428+20.80
101'-10 3/4" BACK TO
BACK OF ABUTMENT

SECTION & IMPROVEMENT
BEGINS STA. 423+75

0 5' 10' 15' — 1" = 5' CROSS SECTION (VERTICAL)

0 5' 10' 15' — 1" = 5' CROSS SECTION (HORIZONTAL)

0 50' 100' — 1" = 20' PLAN AND PROFILE

FULL SIZE PLANS HAVE BEEN PREPARED USING STANDARD
ENGINEERING SCALES. REDUCED SIZED PLANS WILL NOT
CONFORM TO STANDARD SCALES. IN MAKING MEASUREMENTS
ON REDUCED PLANS, THE ABOVE SCALES MAY BE USED.

J.U.L.I.E.
JOINT UTILITY LOCATION INFORMATION FOR EXCAVATION
1-800-892-0123

CONTRACT NO. 64939

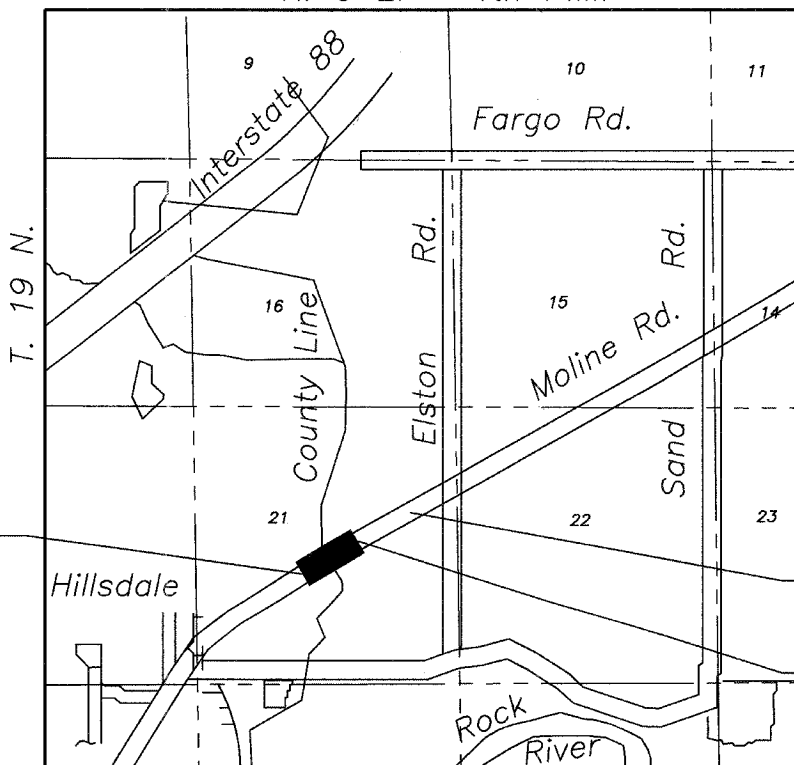

NET LENGTH OF SECTION 850 FEET (0.16 MILES)
GROSS LENGTH OF SECTION 850 FEET (0.16 MILES)

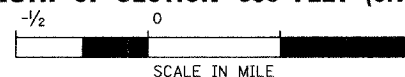

IMPROVEMENT ENDS
STA. 435+35

SECTION ENDS
STA. 432+25



signature
PROFESSIONAL DESIGN FIRM
LICENSE NO. 184-001717

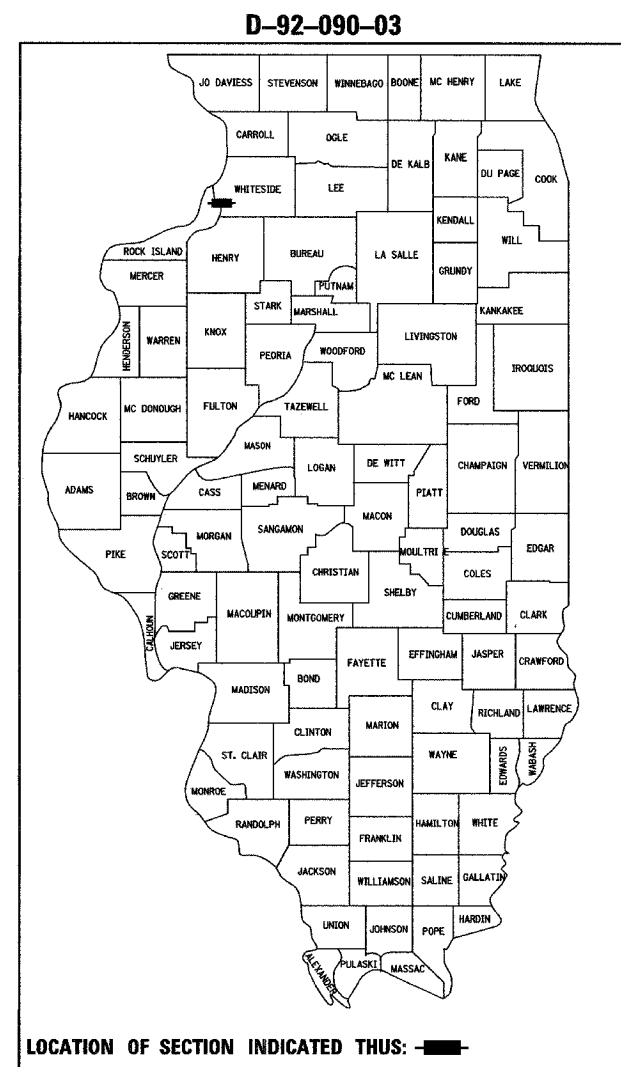

LOCATION OF SECTION INDICATED THUS: [black rectangle]

STATE OF ILLINOIS
DEPARTMENT OF TRANSPORTATION
DIVISION OF HIGHWAYS

SUBMITTED Oct 10 2007

George F. Ryan
DEPUTY DIRECTOR OF HIGHWAYS, REGION ENGINEER

February 1, 2008
Eric E. Hara
INTERIM ENGINEER OF DESIGN AND ENVIRONMENT

February 1, 2008
Christine M. Reed
DIRECTOR OF HIGHWAYS, CHIEF ENGINEER

DISTRICT 2 DIXON IL

PRINTED BY THE AUTHORITY
OF THE STATE OF ILLINOIS

JAMES K. CLIVARD
CHAMLIN & ASSOCIATES
815-223-3344

CHAMLIN & ASSOCIATES
PERU ILLINOIS MORRIS