

* At end of slab

MINI BAR CAPS
#5 bars - 1'-9"

FOR INFORMATION ONLY

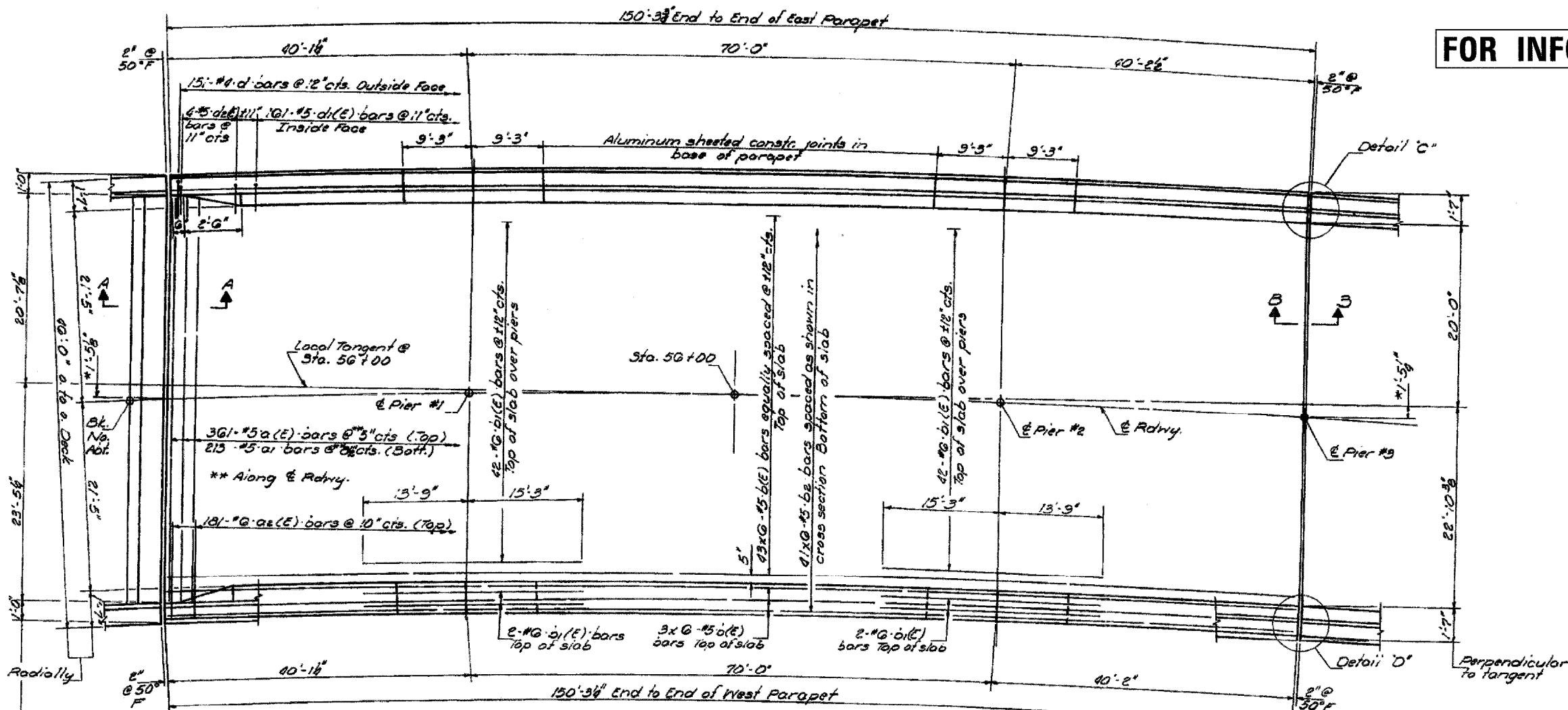

PLAN

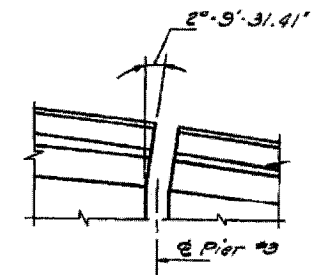

DETAIL C

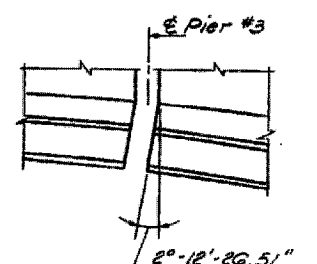

DETAIL D

NOTES:

Reinforcement bars designated (E) shall be epoxy coated. See Special Provisions.
Bars indicated thus 20x3-#5 etc. indicates 20 lines of bars with 3 lengths per line.

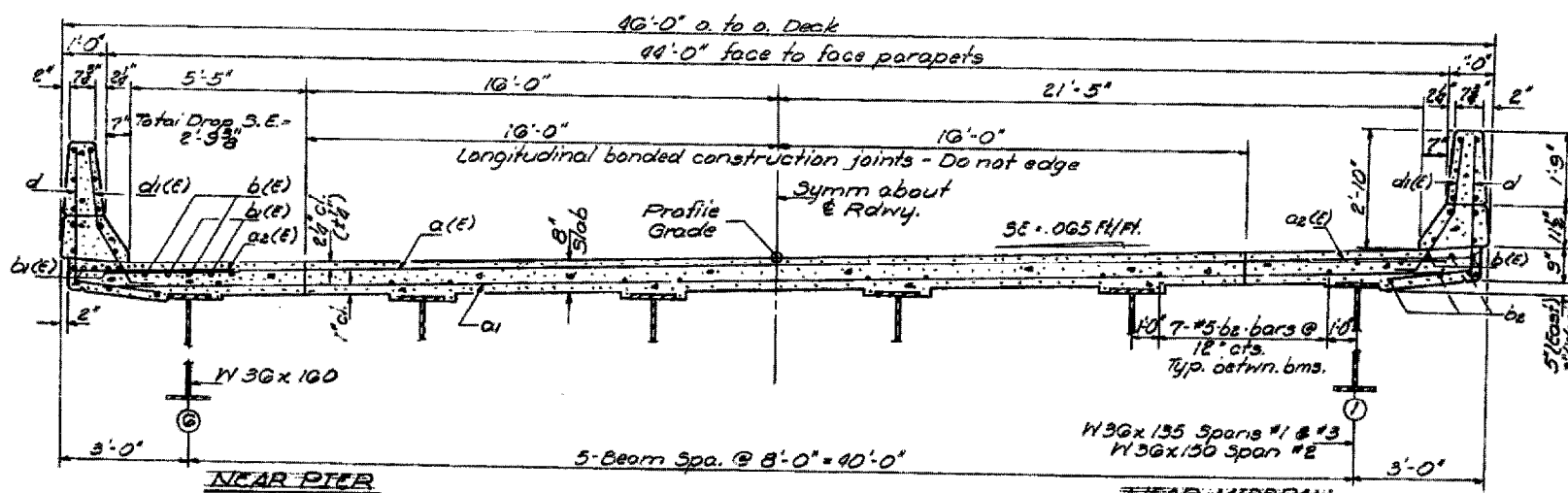

CROSS SECTION
(Looking North)

DECK PLAN & CROSS SECTION
SPANS 1-3
IL 84 OVER PLUM RIVER
FA ROUTE 18 (IL 84)
SECTION 106BR
CARROLL COUNTY
STRUCTURE NUMBER 008-0028

FILE NAME =	USER NAME = lmkdj	DESIGNED -	REVISED -	STATE OF ILLINOIS DEPARTMENT OF TRANSPORTATION	Existing Deck Plan & Cross-Section (Spans 1-3)	F.A. RTE.	SECTION	COUNTY	TOTAL SHEETS	SHEET NO.	
D:\BR\CADD\plans\Various Counties\Contract #64099 2008 expansion joints\020026.dgn		DRAWN -	REVISED -			•	••	Various	26	11	
PLOT SCALE = 5/8" = 1' / IN.		CHECKED -	REVISED -			ILLINOIS		CONTRACT NO. 64099			
PLOT DATE = Sat Mar 15 11:12:58 2008		DATE -	REVISED -			FED. ROAD DIST. NO.		ILLINOIS FED. AID PROJECT			