

F.A.T. RTE.	SECTION	COUNTY	TOTAL SHEETS	SHEET NO.
9	00	000	22	1

- FAS 1909 & FAP 322
- D9 PAVEMENT PRESERVATION FY08
- JACKSON AND UNION COUNTIES

STATE OF ILLINOIS
DEPARTMENT OF TRANSPORTATION
DIVISION OF HIGHWAYS

PROPOSED HIGHWAY PLANS

FAS ROUTE 1909 & FAP ROUTE 322
SECTION D9 PAVEMENT PRESERVATION FY08

D-99-040-07

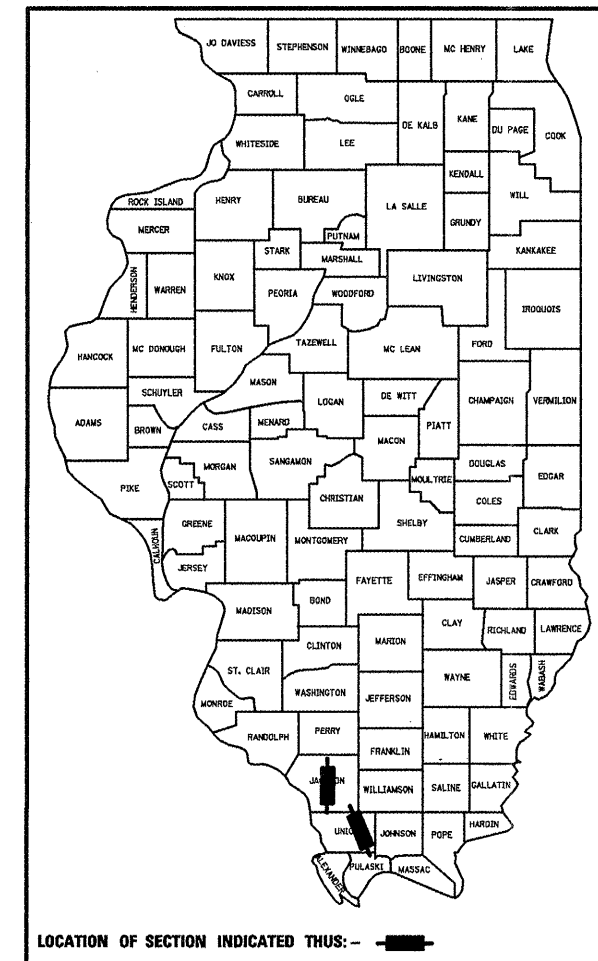

LOCATION OF SECTION INDICATED THUS: —■—

FOR INDEX OF SHEETS, SEE SHEET NO. 3

ADT:
US 51 - 4050 (2005)
MU = 125
SU = 200
TRUCKS = 8%

IL 127 - 4200 (2005)
MU = 40
SU = 100
TRUCKS = 3%

EQUATION STATIONS: US 51
EQ. STA. 1047+55.55 (BK.) = STA. 52+01.25 (AH.)
EQ. STA. 103+30.75 (BK.) = STA. 103+86.85 (AH.)
EQ. STA. 118+04.60 (BK.) = STA. 2018+04.60 (AH.)
EQ. STA. 2081+73.95 (BK.) = STA. 187+61.39 (AH.)
EQ. STA. 240+04.17 (BK.) = STA. 3040+04.17 (AH.)
EQ. STA. 3101+03.20 (BK.) = STA. 304+62.66 (AH.)

EQUATION STATIONS: IL 127
EQ. STA. 344+07.40 (BK.) = STA. 6+06.70 (AH.)
EQ. STA. 79+77.70 (BK.) = STA. 80+07.70 (AH.)
EQ. STA. 138+96.20 (BK.) = STA. 139+83.10 (AH.)

OMISSION STATIONS:
STA. 3073+50 TO STA. 3075+71 (S.N. 091-0071)

PROJECT AT FAS 1909 LOCATION 3:
STA. 335+53 TO STA. 227+32
LENGTH = 22,862.8' = 4.33 MILES

TOWNSHIPS: POMONA, ANNA, BALCOM

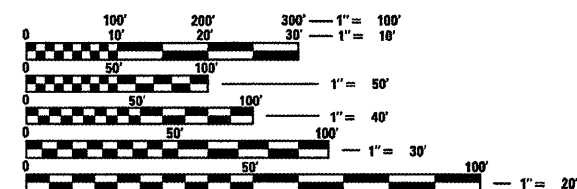

FULL SIZE PLANS HAVE BEEN PREPARED USING STANDARD ENGINEERING SCALES. REDUCED SIZED PLANS WILL NOT CONFORM TO STANDARD SCALES. IN MAKING MEASUREMENTS ON REDUCED PLANS, THE ABOVE SCALES MAY BE USED.

J.U.L.I.E.
JOINT UTILITY LOCATION INFORMATION FOR EXCAVATION
1-800-892-0123

CONTRACT NO. 78017

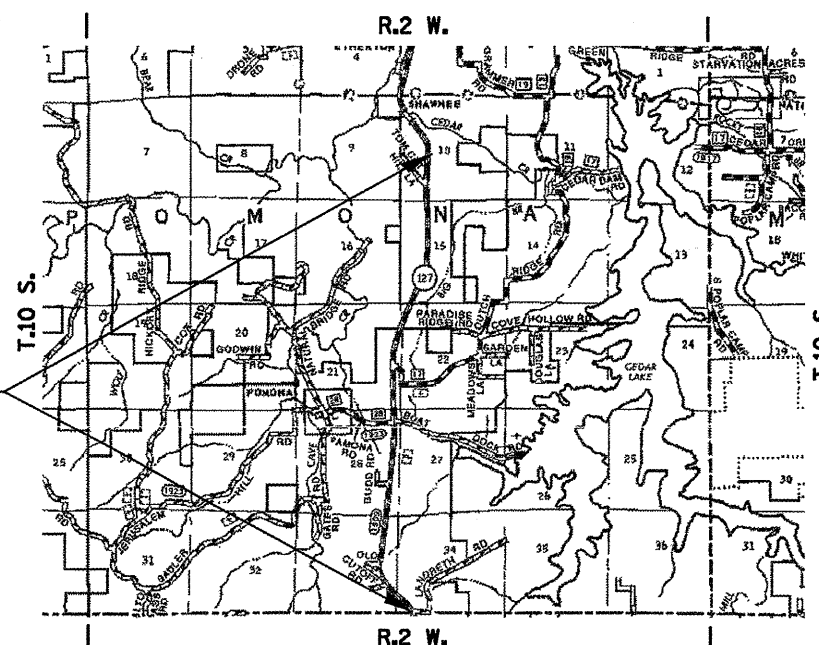

PROJECT AT US 51 LOCTION 1:
STA. 1000+33 TO STA. 238+50
LENGTH = 22,727.76' = 4.31 MILES

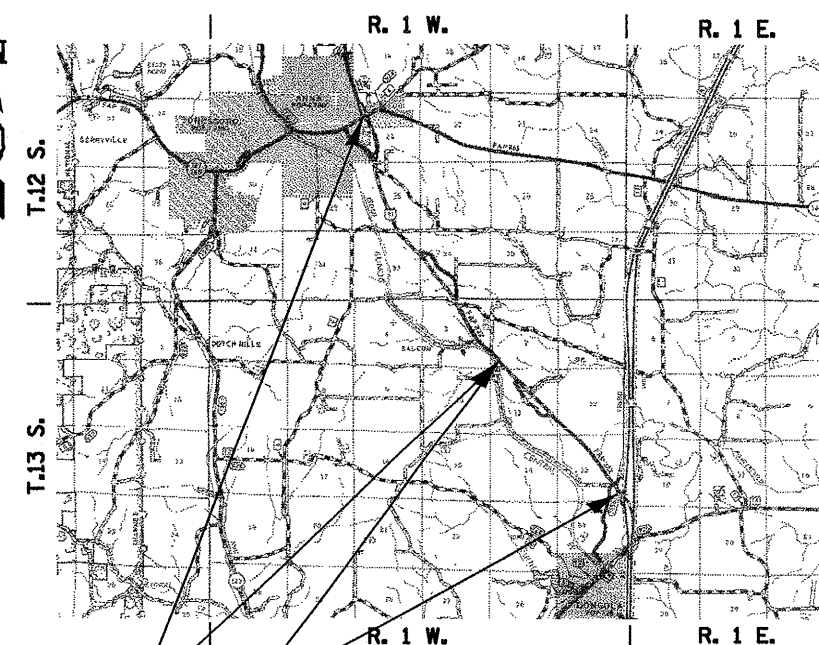

PROJECT AT US 51 LOCTION 2:
STA. 238+50 TO STA. 378+65
LENGTH = 13,434.54' = 2.54 MILES

GROSS PROJECT LENGTH = 59,246.1 = 11.22 MILES
NET PROJECT LENGTH: 59,025.1' = 11.18 MILES

STATE OF ILLINOIS
DEPARTMENT OF TRANSPORTATION
DIVISION OF HIGHWAYS

SUBMITTED Jan 23 20 08
Mary C. Davis
DEPUTY DIRECTOR OF HIGHWAYS, REGION ENGINEER
March 21 20 08
Eric E. Harnik
Interim ENGINEER OF DESIGN AND ENVIRONMENT
March 21 20 08
Christina M. Reed
DIRECTOR OF HIGHWAYS, CHIEF ENGINEER

PRINTED BY THE AUTHORITY
OF THE STATE OF ILLINOIS