

F.A.I. RTE.	SECTION	COUNTY	TOTAL SHEETS	SHEET NO.
•	••	•••	22	21
STA. _____ TO STA. _____				
FED. ROAD DIST. NO. - ILLINOIS FED. AID PROJECT				

- FAS 1909 & FAP 322
- D9 PAVEMENT PRESERVATION FY08
- JACKSON AND UNION COUNTIES

PAVEMENT MARKING DETAIL
 FAP 322 (US 51) AT LOCATION 2
 STA. 365+98 TO STA. 378+65

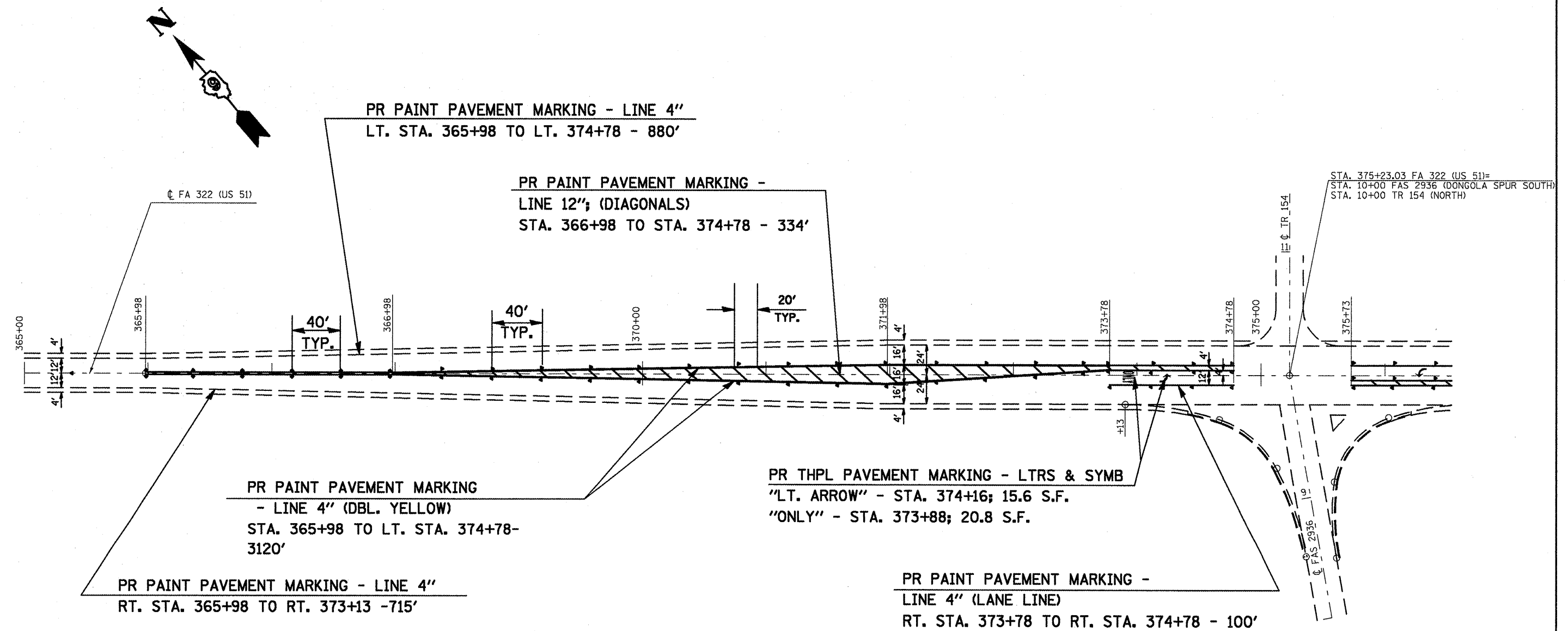

PR PAINT PAVEMENT MARKING - LINE 4"
 LT. STA. 365+98 TO LT. 374+78 - 880'

PR PAINT PAVEMENT MARKING -
 LINE 12"; (DIAGONALS)
 STA. 366+98 TO STA. 374+78 - 334'

PR PAINT PAVEMENT MARKING
 - LINE 4" (DBL. YELLOW)
 STA. 365+98 TO LT. STA. 374+78-
 3120'

PR PAINT PAVEMENT MARKING - LINE 4"
 RT. STA. 365+98 TO RT. 373+13 -715'

PR THPL PAVEMENT MARKING - LTRS & SYMB
 "LT. ARROW" - STA. 374+16; 15.6 S.F.
 "ONLY" - STA. 373+88; 20.8 S.F.

PR PAINT PAVEMENT MARKING -
 LINE 4" (LANE LINE)
 RT. STA. 373+78 TO RT. STA. 374+78 - 100'

NOTES:
 FOR RAISED REFLECTIVE PAVEMENT MARKERS,
 SEE SCHEDULE ON SHEET 14.
 FOR PAVEMENT MARKING BEFORE STATION 365+98,
 SEE SCHEDULE ON SHT. 12.

PLOT DATE = 1/24/2008
 FILE NAME = c:\pav\pav\pav1487\mroad.dgn
 USER NAME = mroad
 USER MAKE = autocad