



PLAN	SURVEYED	DATE
NOTE BOOK	ALIGNED	BY
NO.	CHECKED	
	NO.	
	NO.	

PROFILE	SURVEYED	DATE
NOTE BOOK	GRADES	BY
NO.	CHECKED	
	NO.	
	NO.	

PLOT DATE # *DATE#
 FILE NAME # *FILE#*
 PLOT SCALE # *SCALE#*
 REFERENCE # *REF#*

CONTRACT NO. 78031

FAP RTE	SECTION	COUNTY	TOTAL SHEETS	SHEET NO.
869	105BR-2	SALINE	118	10
STA. 1559+00		TO STA. 1565+00		
FED. ROAD DIST. NO.	ILLINOIS	FED. AID PROJECT AID		

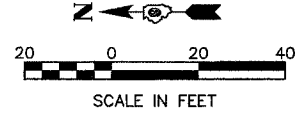

SEC. 3, T9S, R6E, 3RD P.M.

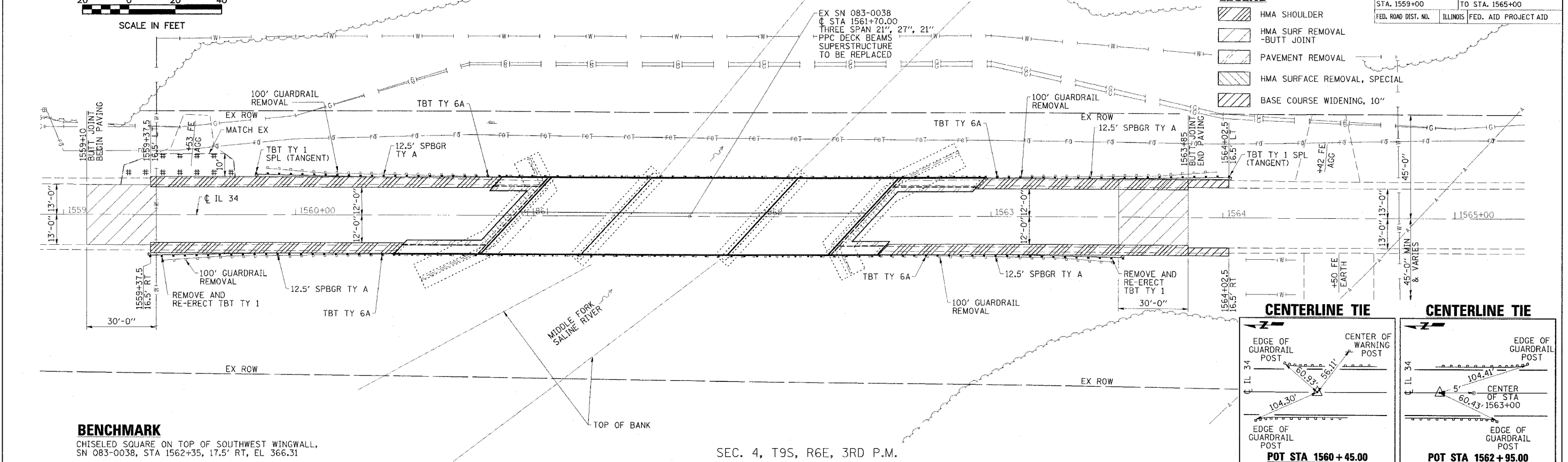

LEGEND

- HMA SHOULDER
- HMA SURF REMOVAL - BUTT JOINT
- PAVEMENT REMOVAL
- HMA SURFACE REMOVAL, SPECIAL
- BASE COURSE WIDENING, 10"

BENCHMARK
 CHISELED SQUARE ON TOP OF SOUTHWEST WINGWALL,
 SN 083-0038, STA 1562+35, 17.5' RT, EL 366.31

SEC. 4, T9S, R6E, 3RD P.M.

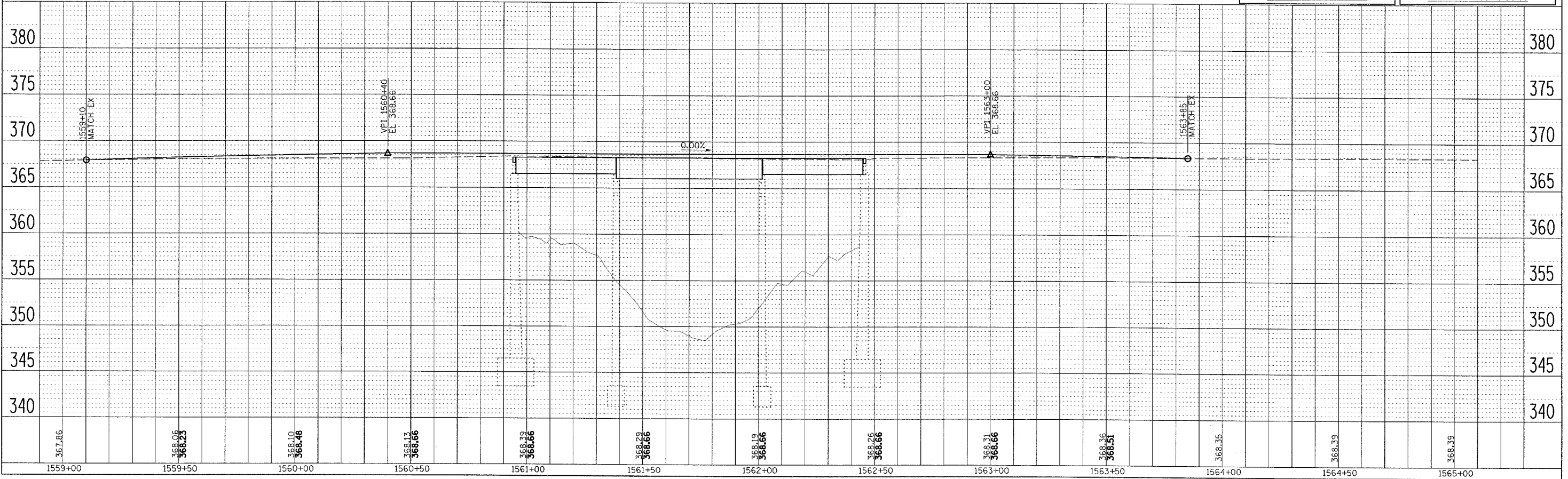

FAP RTE 869 (IL 34) PLAN & PROFILE
 STA. 1554+00 TO 1565+00