

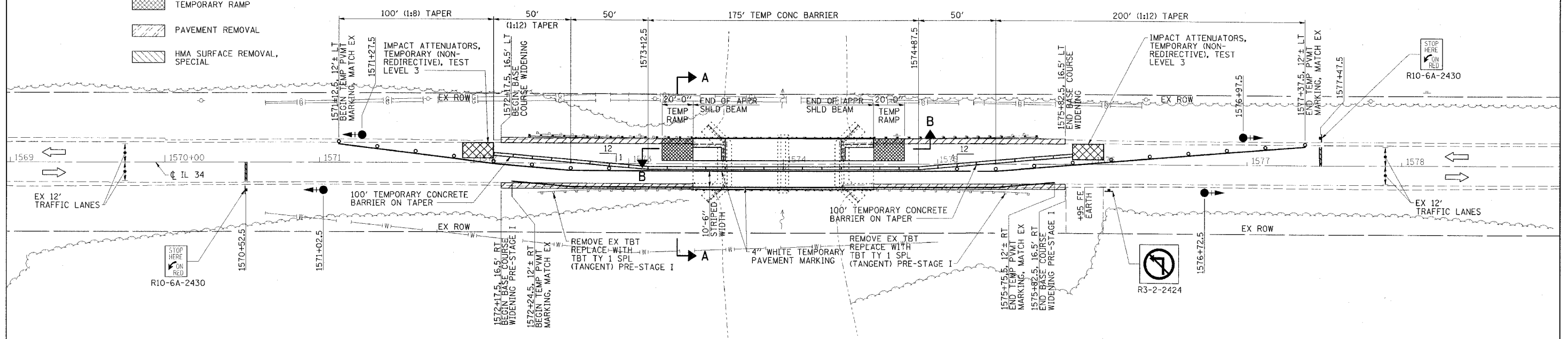

CONTRACT NO. 78031			
FAP RTE	SECTION	COUNTY	TOTAL SHEETS
869	105BR-3	SALINE	118
STA. 1569+00		TO STA. 1579+00	
FED. ROAD DIST. NO.	ILLINOIS	FED. AID PROJECT	

LEGEND

- TRAFFIC SIGNAL WITH BACKPLATE, SIGNAL DIRECTION INDICATED
- BASE COURSE WIDENING, 10"
- TEMPORARY RAMP
- PAVEMENT REMOVAL
- HMA SURFACE REMOVAL, SPECIAL

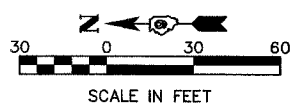

GENERAL NOTES

1. TRAFFIC CONTROL SHALL BE ERECTED AS SHOWN AND ACCORDING TO "TRAFFIC CONTROL AND PROTECTION, STANDARD 701321."
2. SEE SPECIAL PROVISIONS FOR ADDITIONAL TRAFFIC CONTROL REQUIREMENTS.
3. COORDINATE LOCATION OF SIGNALS WITH FINAL WORK AS DIRECTED BY THE ENGINEER.
4. CONSTRUCT TEMPORARY RUMBLE STRIPS AT LOCATIONS SHOWN ON STANDARD 701321.
5. THE DIMENSION SHOWN ON THE WIDTH RESTRICTION SIGN (W12-1102(0)-48) SHOWN ON STANDARD 701321 SHALL BE 11'-0" FOR STAGE I CONSTRUCTION
6. ADDITIONAL SIGNAGE AND BARRICADES SHOWN FOR SIDEROADS AND ENTRANCES SHALL BE INCLUDED IN THE COST OF STANDARD 701321.
7. THE EXISTING 'TURNDOWN' TBT'S AT THE NW AND SW CORNERS OF THE BRIDGE MUST BE REMOVED AND REPLACED WITH NEW TBT'S TY 1 SPECIAL (TANGENT) PRIOR TO SHIFTING TRAFFIC TO THE STAGE I LANE.

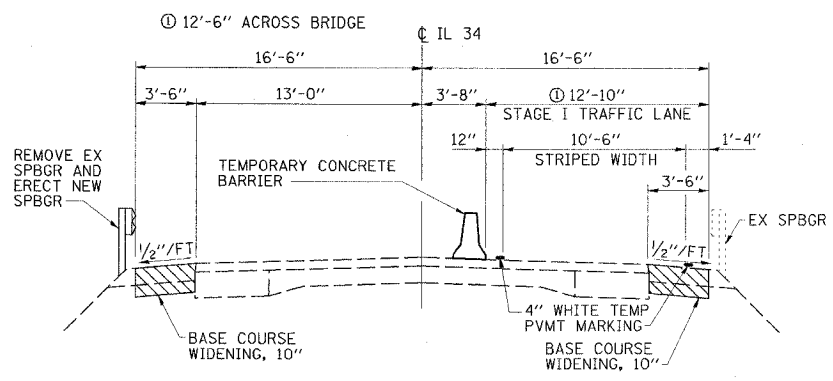
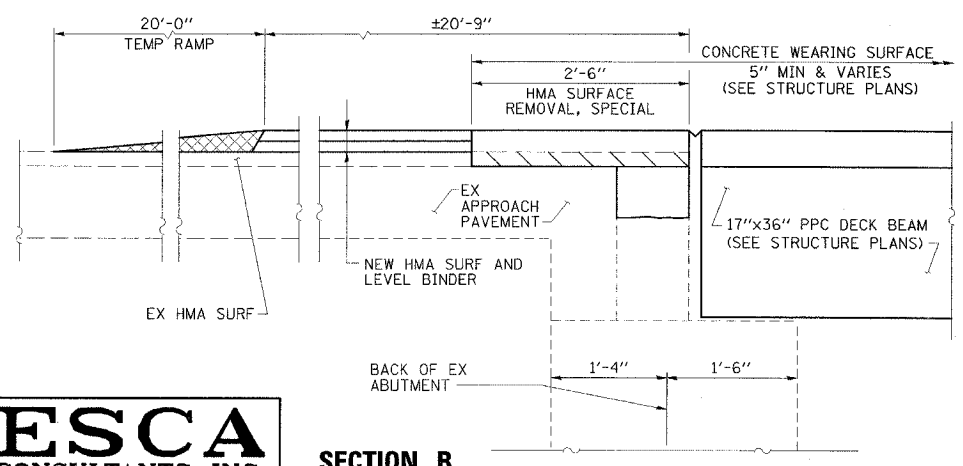

SCHEDULE OF QUANTITIES

TEMPORARY CONCRETE BARRIER	STATION TO	STATION	FEET
	1572+12.5	1575+87.5	375
		TOTAL	375
TEMPORARY BRIDGE TRAFFIC SIGNALS			- 1 EACH
TEMPORARY RUMBLE STRIPS			- 6 EACH
IMPACT ATTENUATORS, TEMPORARY (NON-REDIRECTIVE), TEST LEVEL 3			- 2 EACH

STAGE I CONSTRUCTION
 FAP RTE 869 (IL 34)
 SECTION 105BR-3
 SALINE COUNTY

ESCA CONSULTANTS, INC.

DESIGNED BY: DAJ 02/08
 DRAWN BY: JPC 02/08
 CHECKED BY: MTD 02/08
 APPROVED BY: RDP 04/08

PLOT DATE = 04/08
 DATE = 04/08
 FILE NAME = 105BR-3
 PLOT SCALE = 1/8"=1'-0"
 REFERENCE = SHEET