

RTE.	CITY SECTION	COUNTY	TOTAL SHEETS	SHEET NO.
2887	07-00083-00-RS	COOK/WILL	10	7
STA. 26+65.6±		TO STA. 39+39.2±		
FED. RD. DIST. NO.	ILLINOIS	PROJECT - M - 8003 (853)		
CONTRACT # 8 3 9 6 9				

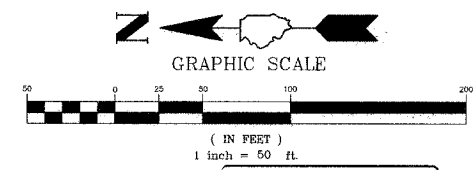

SHORT TERM PAVEMENT MARKING
 CENTERLINE 4" DOUBLE YELLOW - 4' LONG, 40' MAX. SPACING
 LANE LINE 4" WHITE - 4' LONG, 40' MAX. SPACING

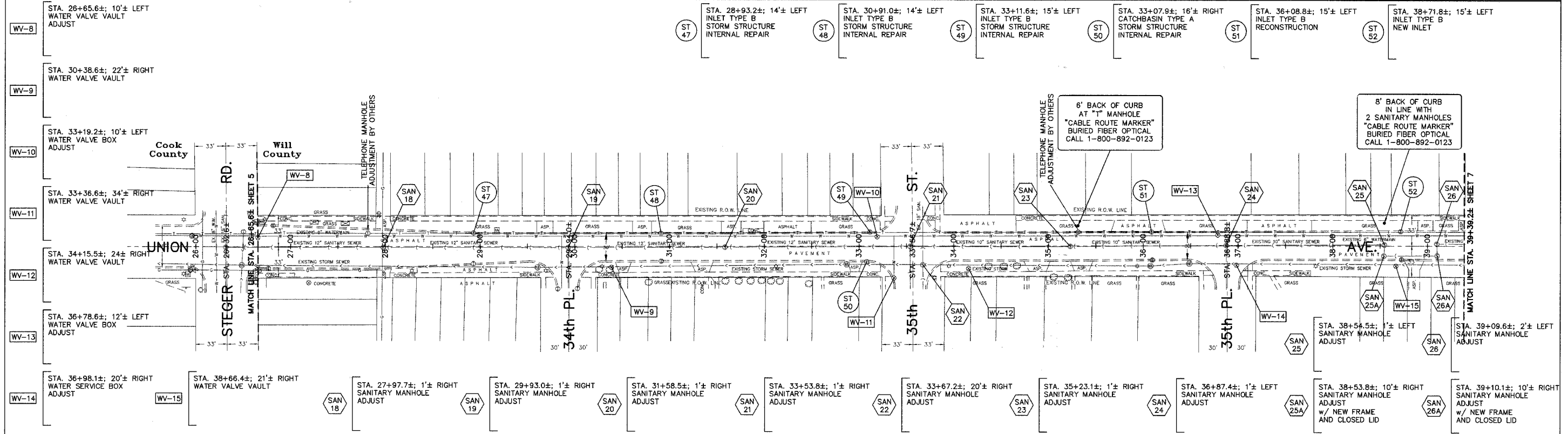
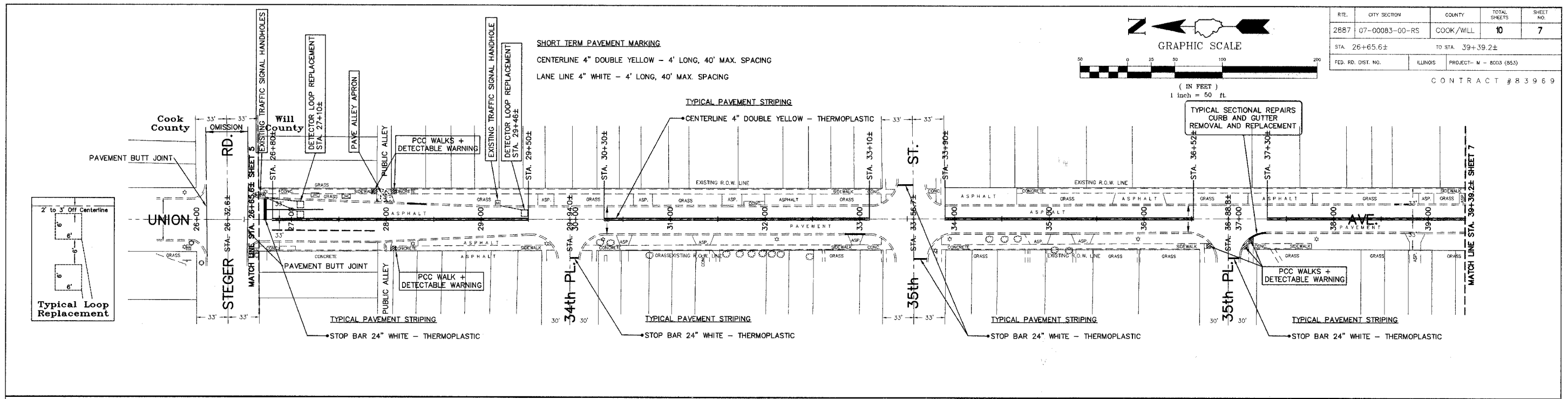

Joseph A. Schudt & Associates
 19350 S. HARLEM AVENUE FRANKFORT, IL 60423
 PHONE: 708-720-1000 FAX: 708-720-1065
 e-mail: jas@jaseng.com http://www.jaseng.com
 CIVIL ENGINEERING LAND SURVEYING ENVIRONMENTAL LAND PLANNING GPS SERVICES

*Union Avenue Street Paving
 30th Street to Richton Road*

REVISIONS	
NAME	DATE

ILLINOIS DEPARTMENT OF TRANSPORTATION
CONSTRUCTION PLAN
 SHEET 7 OF 10
 SCALE: AS SHOWN DRAWN BY: J.A.R.
 DATE: 4-4-08 CHECKED BY: S.M.H.
 07-22
 07-022-SOUTH

M:\2007\07-022-SOUTH.dwg (17:46 SCALE: 4200Wx15147 H). COPYRIGHT © JOSEPH A. SCHUDT & ASSOCIATES, INC.