

INDEX OF SHEETS

- 1 TITLE SHEET
- 2 GENERAL NOTES
- 3 TYPICAL SECTIONS & HOT-MIX ASPHALT MIXTURE REQUIREMENTS
- 4 SUMMARY OF QUANTITIES
- 5 CONSTRUCTION PLAN STA. 0+30± TO 13+54.2±
- 6 CONSTRUCTION PLAN STA. 13+54.2± TO 26+65.6±
- 7 CONSTRUCTION PLAN STA. 26+65.6± TO 39+39.2±
- 8 CONSTRUCTION PLAN STA. 39+39.2± TO 50+54.1±
- 9 CONSTRUCTION PLAN STA. 50+54.1± TO 60+15±
- 10 MISCELLANEOUS DETAILS
- 11 TC-10, DISTRICT 1, TRAFFIC CONTROL & PROTECTION FOR SIDE ROADS, INTERSECTIONS, AND DRIVEWAYS
- 12 TC-13, DISTRICT 1, TYPICAL PAVEMENT MARKINGS

STATE STANDARDS

- 000001-05 STANDARD PAVEMENT MARKING & SYMBOLS
- 424001-05 CURB RAMPS FOR SIDEWALKS
- 604001-02 FRAME AND LIDS TYPE 1
- 606001-03 CONCRETE CURB AND GUTTER
- 701606-05 URBAN LANE CLOSURE MULTILANE 2W
- 701701-05 URBAN LANE CLOSURE MULTILANE INTERSECTION
- 701801-03 LANE CLOSURE MULTILANE, 1W OR 2W CROSSWALK OR SIDEWALK CLOSURE
- 701901 TRAFFIC CONTROL DEVICES (SHEETS 1, 2, & 3)
- 780001-01 TYPICAL PAVEMENT MARKINGS
- 886001 DETECTOR LOOP INSTALLATIONS

STATE OF ILLINOIS
DEPARTMENT OF TRANSPORTATION
DIVISION OF HIGHWAYS

**PLANS FOR PROPOSED
FEDERAL AID HIGHWAY
FAU ROUTE 2887 (UNION AVENUE)
30th STREET TO RICHTON ROAD
RESURFACING
SECTION: 07-00083-00-RS
PROJECT: M-8003 (853)
VILLAGE OF STEGER
COOK-WILL COUNTIES
JOB No. C-91-001-08**

RTE.	CITY SECTION	COUNTY	TOTAL SHEETS	SHEET NO.
2887	07-00083-00-RS	COOK/WILL	10	1
STA.		TO STA.		
FED. RD. DIST. NO.		ILLINOIS PROJECT- M - 8003 (853)		

CONTRACT # 83969



TRAFFIC DATA
2006 ADT = 4650N/5200S
SPEED LIMIT = 30 M.P.H.
CLASS I

SCALE: PLAN 1" = 50'

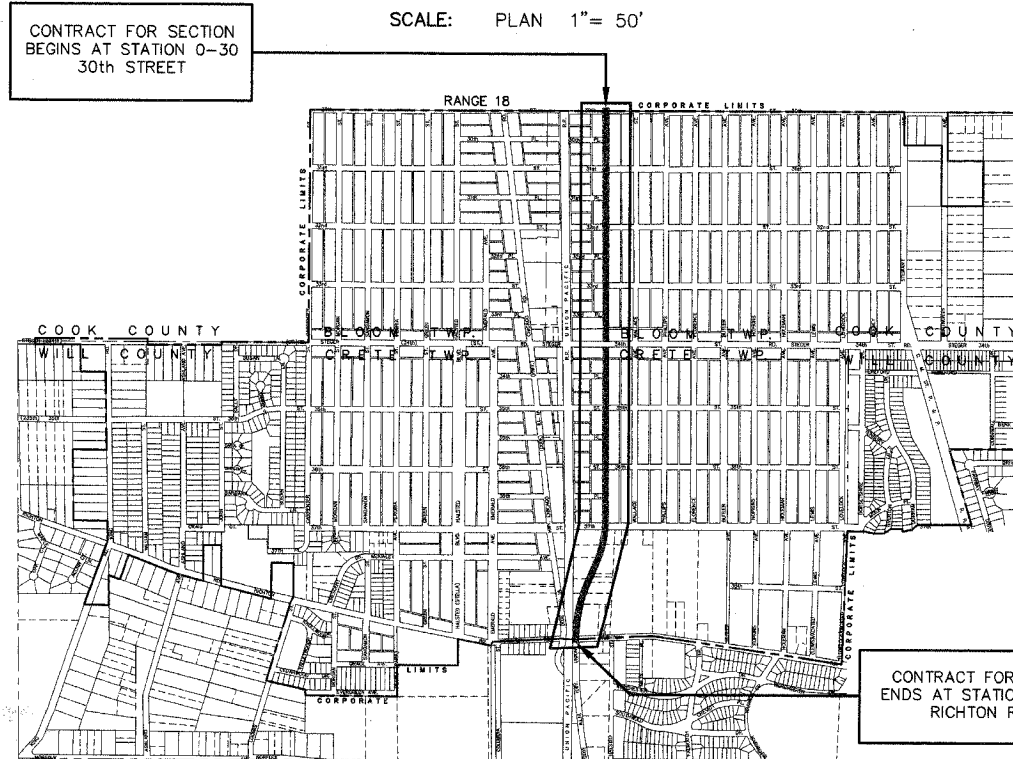

CONTRACT FOR SECTION
BEGINS AT STATION 0+30
30th STREET

CONTRACT FOR SECTION
ENDS AT STATION 60+15±
RICHTON ROAD

LOCATION MAP UNION AVENUE: GROSS LENGTH OF IMPROVEMENT= 6,045 FT.±
NET LENGTH OF IMPROVEMENT= 5,979 FT.± (1.13 MILES)
NOT TO SCALE



CALL J.U.L.I.E.
1-800-892-0123
48 HOURS
(TWO WORKING DAYS)
TOLL FREE
24 HOURS A DAY
7 DAYS A WEEK

I.D.O.T. FIELD ENGINEER: MELCHOR MANGOBA 1-847-705-4408 SCHAUMBURG, IL
CONSULTANT: JOSEPH A. SCHUDT & ASSOCIATES, MATT HORAN 1-708-720-1000 FRANKFORT, IL

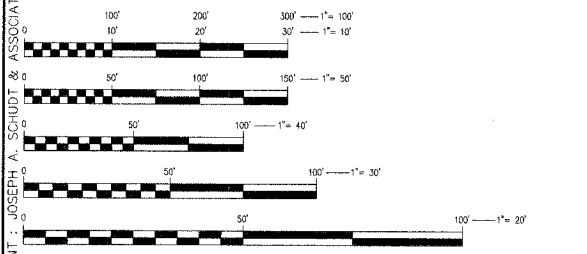

FULL SIZE PLANS HAVE BEEN PREPARED USING STANDARD ENGINEERING SCALES. REDUCED SIZED PLANS WILL NOT CONFORM TO STANDARD SCALES. IN MAKING MEASUREMENTS ON REDUCED PLANS, THE ABOVE SCALES MAY BE USED.

Joseph A. Schudt & Associates
19350 S. HARLEM AVENUE FRANKFORT, IL 60423
PHONE: 708-720-1000 FAX: 708-720-1065
e-mail: joseph@jasaeng.com <http://www.jasaeng.com>
CIVIL ENGINEERING LAND SURVEYING ENVIRONMENTAL LAND PLANNING GPS SERVICES

COPYRIGHT © 2008
JOSEPH A. SCHUDT & ASSOCIATES
ALL RIGHTS RESERVED

S. Matthew Horan
ILLINOIS PROFESSIONAL ENGINEER NO. 062-019927
SIGNED 4/4/08
LICENSE EXPIRES 11/30/09

STATE OF ILLINOIS
DEPARTMENT OF TRANSPORTATION
DIVISION OF HIGHWAYS

APPROVED APRIL 4 20 08
Pami Shuman
LOCAL AGENCY OFFICIAL

PASSED MAY 15 20 08
Christopher Holt
REGISTERED PROFESSIONAL ENGINEER OF LOCAL ROADS & STREETS

RELEASING FOR BID BASED ON LIMITED REVIEW
MAY 15, 20 08
Diana M. D'Kuhn
DEPUTY DIRECTOR OF HIGHWAYS REGION 9 ENGINEER



CONTRACT No. 83969

07-22
07-022-JAR

RTE.	CITY SECTION	COUNTY	TOTAL SHEETS	SHEET NO.
2887	07-00083-00-RS	COOK/WILL	10	2
STA.		TO STA.		
FED. RD. DIST. NO.	ILLINOIS	PROJECT- M - 8003 (853)		

CONTRACT # 83969

VILLAGE COORDINATION:

THE CONTRACTOR SHALL NOTIFY THE VILLAGE ENGINEER AT LEAST 72 HOURS IN ADVANCE OF BEGINNING WORK AND SHALL COORDINATE ALL CONSTRUCTION OPERATIONS WITH THE ENGINEER. THE CONTRACTOR SHALL NOTIFY THE PUBLIC WORKS DEPARTMENT OF THE VILLAGES OF STEGER AND SOUTH CHICAGO HEIGHTS 48 HOURS PRIOR TO ANY WORK IN ORDER TO OBTAIN VILLAGE UTILITY LOCATIONS. THE CONTRACTOR SHOULD PLAN HIS WORK TO AVOID ALL INTERFERENCE WITH THE UNDERGROUND UTILITIES.

PUBLIC OR PRIVATE UTILITIES:

THE LOCATION OF PUBLIC OR PRIVATE UTILITIES SHOWN ON THE PLANS ARE APPROXIMATE, AND THE DEPARTMENT DOES NOT GUARANTEE THEIR ACCURACY. THE CONTRACTOR WILL BE REQUIRED TO ASCERTAIN THE EXACT LOCATIONS OF SUCH UTILITIES AND EXERCISE CARE DURING CONSTRUCTION OPERATIONS, SO AS NOT TO DAMAGE THEM, IN ACCORDANCE WITH THE SPECIAL PROVISIONS AND ARTICLE 107.20 OF THE STANDARD SPECIFICATIONS. THE CONTRACTOR SHALL BE RESPONSIBLE FOR ANY DAMAGE OR DESTRUCTION OF PUBLIC OR PRIVATE PROPERTY AND SHALL RESTORE SUCH PROPERTY AT HIS OWN EXPENSE. COORDINATION OF ALL WORK INVOLVED IN THE CONSTRUCTION AREA WILL BE DISCUSSED AT A PRECONSTRUCTION CONFERENCE. THE CONTRACTOR SHALL USE ALL NECESSARY PRECAUTIONS AND PROTECTIVE MEASURES REQUIRED TO MAINTAIN EXISTING UTILITIES, SEWERS, AND APPURTENANCES THAT MUST BE KEPT IN OPERATION. IN PARTICULAR, THE CONTRACTOR WILL TAKE ADEQUATE MEASURES TO PREVENT THE UNDERMINING OF UTILITIES AND SEWERS WHICH ARE STILL IN SERVICE. WHENEVER THE CONTRACTOR ENCOUNTERS FACILITIES AND APPURTENANCES WITHIN THE LIMITS OF THE IMPROVEMENTS DURING TRENCHING OR AUGERING OPERATIONS, HE WILL BE REQUIRED TO HAND TRENCH IN THAT AREA IN ORDER NOT TO DAMAGE THE FACILITIES.

SURVEY MONUMENTS:

WHERE SECTION OR SUBSECTION MONUMENTS ARE ENCOUNTERED, THE ENGINEER SHALL BE NOTIFIED BEFORE SUCH MONUMENTS ARE REMOVED. THE CONTRACTOR SHALL PROTECT AND CAREFULLY PRESERVE ALL PROPERTY MARKS OR MONUMENTS UNTIL THE OWNER, HIS AGENT, OR AN AUTHORIZED SURVEYOR HAS WITNESSED OR OTHERWISE REFERENCED THEIR LOCATIONS.

DRAINAGE STRUCTURES:

WHEREVER DURING CONSTRUCTION OPERATIONS ANY LOOSE MATERIAL IS DEPOSITED IN THE FLOW LINE OF DRAINAGE STRUCTURES SUCH THAT THE NATURAL FLOW OF WATER IS OBSTRUCTED, IT SHALL BE REMOVED AT THE CLOSE OF EACH WORKING DAY. AT THE CONCLUSION OF CONSTRUCTION OPERATIONS, ALL DRAINAGE STRUCTURES SHALL BE FREE FROM DIRT AND DEBRIS. THE WORK SPECIFIED ABOVE WILL NOT BE PAID FOR SEPARATELY, BUT SHALL BE CONSIDERED AS INCIDENTAL TO THE CONTRACT. WHEN EXISTING DRAINAGE FACILITIES ARE DISTURBED, THE CONTRACTOR SHALL PROVIDE AND MAINTAIN TEMPORARY OUTLETS AND CONNECTIONS FOR ALL PRIVATE OR PUBLIC DRAINS, SEWERS, OR CATCH BASINS. HE SHALL PROVIDE FACILITIES TO TAKE IN ALL STORM WATER WHICH WILL BE RECEIVED BY THESE DRAINS AND SEWERS AND DISCHARGE THE SAME. HE SHALL PROVIDE AND MAINTAIN AN EFFICIENT PUMPING PLANT, IF NECESSARY, AND A TEMPORARY OUTLET AND BE PREPARED AT ALL TIMES TO DISPOSE OF THE WATER RECEIVED FROM THESE TEMPORARY CONNECTIONS. THIS WORK WILL NOT BE PAID FOR DIRECTLY BUT SHALL BE CONSIDERED INCIDENTAL TO THE CONTRACT.

FIELD OBSERVATION:

IT IS THE CONTRACTOR'S RESPONSIBILITY TO ASCERTAIN EXISTING FIELD CONDITIONS BEFORE BIDDING ON THE PROJECT, SPECIFICALLY AS THEY RELATE TO LUMP SUM ITEMS. IT IS THE CONTRACTORS RESPONSIBILITY TO VERIFY ALL DIMENSIONS AND CONDITIONS EXISTING IN THE FIELD PRIOR TO CONSTRUCTION AND ORDERING MATERIALS.

GENERAL NOTES:

ALL DISTURBED AREA WHERE RESTORATION IS NOT COVERED BY APPLICABLE SECTIONS OF THE SPECIAL PROVISIONS MUST BE RESTORED TO THE SATISFACTION OF THE ENGINEER. THE WORK SHALL BE CONSIDERED INCIDENTAL TO THE CONTRACT. SEPARATE PAYMENT WILL NOT BE MADE.

THE EXACT LOCATIONS OF ALL UTILITIES SHALL BE VERIFIED BY THE CONTRACTOR BEFORE CONSTRUCTION. FOR LOCATIONS OF THE UTILITIES, CALL JULIE TOLL FREE AT 1-800-892-0123. IT IS THE CONTRACTORS RESPONSIBILITY TO LOCATE EXISTING TRAFFIC SIGNAL CABLES AND CONDUITS, AND STREET LIGHTING. AREA TRAFFIC SIGNAL MAINTENANCE AND OPERATIONS ENGINEER 847-705-4139. SEE ADDITIONAL SPECIAL PROVISION No. 14.

CONTRACTOR SHALL TAKE ALL NECESSARY MEASURES TO RESTORE ANY SPECIALIZED LANDSCAPING, (i.e. TREES, DECORATIVE ROCKS, SHRUBS, PLANTS, etc.) OR SHALL REPLACE IT, THE COST OF WHICH SHALL BE CONSIDERED INCIDENTAL TO THE CONTRACT.

GENERAL NOTES: (CONTINUED)

MATERIALS RESULTING FROM THE REMOVAL OF PAVEMENT, DRIVEWAYS, CURB AND GUTTER, BITUMINOUS SURFACES, SEWER WORK ETC. SHALL BE REMOVED AT THE END OF EACH DAY.

IT WILL BE THE CONTRACTORS RESPONSIBILITY TO NOTIFY RESIDENTS WHEN ACCESS TO THEIR DRIVEWAYS WILL BE TEMPORARILY CLOSED DUE TO CURB AND GUTTER AND/OR DRIVEWAY REPLACEMENT.

ACCESS TO DRIVEWAYS SHALL BE PROVIDED AT ALL TIMES EXCEPT DURING ACTUAL CONSTRUCTION ADJACENT THERE TO. TEMPORARY RAMPS SHALL BE CONSTRUCTED AS NEEDED TO PROVIDE SUCH ACCESS, UTILIZING CRUSHED STONE OR CRUSHED GRAVEL AND INCLUDED IN THE PAY ITEM FOR COMBINATION CURB AND GUTTER REMOVAL AND REPLACEMENT.

ANY SIGNS OR MAILBOXES THAT ARE IN CONFLICT WITH THE PROPOSED CONSTRUCTION SHALL BE REMOVED AND REPLACED IN ACCORDANCE WITH VILLAGE STANDARDS AND INCLUDED IN THE PAY ITEM FOR COMBINATION CURB AND GUTTER REMOVAL AND REPLACEMENT. MAIL SERVICE SHALL BE MAINTAINED AT ALL TIMES.

EXISTING PAVEMENT, DRIVEWAY PAVEMENT, CURB AND GUTTER AND SIDEWALK TO REMAIN IN PLACE SHALL BE SAW-CUT FULL DEPTH TO PROVIDE A NEAT VERTICAL FACE BETWEEN THE PROPOSED AND EXISTING AND SHALL BE INCLUDED IN THE APPROPRIATE REMOVAL PAY ITEM.

IN AREAS WHERE THE EXISTING DRIVEWAY, SIDEWALK, OR CURB AND GUTTER IS TO BE REMOVED AND REPLACED, THE REMOVAL AND DISPOSAL OF ANY ADDITIONAL MATERIAL REQUIRED TO ESTABLISH THE PROPOSED DRIVEWAY, SIDEWALK, OR CURB AND GUTTER SUBGRADE ELEVATION SHALL BE INCLUDED IN THE PAY ITEMS SIDEWALK REMOVAL OR COMBINATION CONCRETE CURB AND GUTTER REMOVE AND REPLACE.

THE CONTRACTOR SHALL PROVIDE AND INSTALL TWO (2) WEIGHTED SAND BAGS ON EACH TYPE I OR TYPE II BARRICADE USED. ONE (1) WEIGHTED SANDBAG SHALL BE PLACED ACROSS EACH BOTTOM RAIL.

THE CONTRACTOR WILL ONLY TO BE ALLOWED TO REMOVE AND REPLACE CURB AND GUTTER ON ONE SIDE OF THE ROAD AT A TIME TO MINIMIZE CONGESTION. REPLACEMENT MUST BE COMPLETE ON ONE SIDE OF THE ROAD BEFORE THE CONTRACTOR IS ALLOWED TO BEGIN REMOVING CURB AND GUTTER ON THE OTHER SIDE OF THE ROAD. ALL CONSTRUCTION WORK DONE PER IDOT SPECIFICATIONS.

INTERSECTING SIDE STREETS:

CONSTRUCTION IN INTERSECTING SIDE STREETS/ALLEYS WILL TERMINATE THIRTY THREE FEET (33') FROM THE CENTERLINE OF UNION AVENUE OR AS DIRECTED BY ENGINEER. SEE DETAIL PAGE 14. WORK WILL BE PAID FOR AT CONTRACT UNIT PRICE FOR HOT-MIX ASPHALT SURFACE REMOVAL (1-1/2").



Joseph A. Schudt & Associates
 19350 S. HARLEM AVENUE FRANKFORT, IL 60423
 PHONE: 708-720-1000 FAX: 708-720-1065
 e-mail: jas@jasaeng.com http://www.jasaeng.com
 CIVIL ENGINEERING LAND SURVEYING ENVIRONMENTAL LAND PLANNING GPS SERVICES

*Union Avenue Street Paving
 30th Street to Richton Road*

COPYRIGHT © 2008
 JOSEPH A. SCHUDT & ASSOCIATES
 ALL RIGHTS RESERVED

REVISIONS		ILLINOIS DEPARTMENT OF TRANSPORTATION	
NAME	DATE		
		GENERAL NOTES	
		SHEET 2 OF 10	
		SCALE: N/A	DRAWN BY: J.A.R.
		DATE: 4-4-08	CHECKED BY: S.M.H.

07-22
 07-022-JAR

SUMMARY OF QUANTITIES

CONSTRUCTION TYPE CODE 1000

CODE NO.	PAY ITEM	UNIT	TOTAL QUANTITY
40600100	BITUMINOUS MATERIALS (PRIME COAT)	GAL.	60
40600300	AGGREGATE (PRIME COAT)	TON	12
40603310	HOT-MIX ASPHALT SURFACE COURSE, MIX "C" N50	TON	1720
42400800	DETECTABLE WARNINGS	SQ. FT.	96
44000155	HOT-MIX ASPHALT SURFACE REMOVAL, 1-1/2"	SQ. YD.	1888
44000198	HOT-MIX ASPHALT SURFACE REMOVAL VARIABLE DEPTH	SQ. YD.	8225
44001700	COMBINATION CONCRETE CURB AND GUTTER REMOVAL AND REPLACEMENT	FOOT	1250
44004610	SIDEWALK REMOVAL AND REPLACEMENT (SPECIAL)	SQ. FT.	1000
44201713	CLASS D PATCHES, TYPE I, 6 INCH	SQ. YD.	50
44201717	CLASS D PATCHES, TYPE II, 6 INCH	SQ. YD.	70
44201721	CLASS D PATCHES, TYPE III, 6 INCH	SQ. YD.	170
44201723	CLASS D PATCHES, TYPE IV, 6 INCH	SQ. YD.	400
60200105	CATCH BASINS, TYPE A, 4' DIAMETER, TYPE I FRAME, OPEN LID	EACH	2
60206905	CATCH BASINS, TYPE C, TYPE I FRAME, OPEN LID	EACH	7
60252800	CATCH BASINS TO BE RECONSTRUCTED	EACH	13
60254100	CATCH BASINS TO BE RECONSTRUCTED WITH NEW TYPE II FRAME AND GRATE	EACH	2
60255500	MANHOLES TO BE ADJUSTED	EACH	36
60255700	MANHOLES TO BE ADJUSTED WITH NEW TYPE I FRAME, OPEN LID	EACH	1
60255800	MANHOLES TO BE ADJUSTED WITH NEW TYPE I FRAME, CLOSED LID	EACH	6
60258100	MANHOLES TO BE RECONSTRUCTED WITH NEW TYPE I FRAME, OPEN LID	EACH	1
60258200	MANHOLES TO BE RECONSTRUCTED WITH NEW TYPE I FRAME, CLOSED LID	EACH	2
60260100	INLETS TO BE ADJUSTED	EACH	1
60262700	INLETS TO BE RECONSTRUCTED	EACH	4
60402510	GRATES, TYPE II	EACH	11
67100100	MOBILIZATION	L. SUM	1
70101700	TRAFFIC CONTROL AND PROTECTION	L. SUM	1
70300100	SHORT-TERM PAVEMENT MARKING	FOOT	2716
78000200	THERMOPLASTIC PAVEMENT MARKING - LINE 4"	FOOT	11569
78000400	THERMOPLASTIC PAVEMENT MARKING - LINE 6"	FOOT	1280
78000600	THERMOPLASTIC PAVEMENT MARKING - LINE 12"	FOOT	706
78000650	THERMOPLASTIC PAVEMENT MARKING - LINE 24"	FOOT	487
88600600	DETECTOR LOOP REPLACEMENT	FOOT	368
X0322052	ASPHALT REJUVENATING AGENT	GAL.	2214
X0324096	HOT-IN-PLACE RECYCLING	SQ. YD.	22140
XX006947	HOT-MIX ASPHALT DRIVEWAY REMOVAL AND REPLACEMENT	SQ. YD.	200
XX007485	CLASS D PATCHES, TYPE IV, 10 MODIFIED (SPECIAL)	SQ. YD.	37
60240500	INLETS TYPE B (SPECIAL)	EACH	5
XX007486	STORM STRUCTURE INTERNAL REPAIR (SPECIAL)	EACH	4
60300310	FRAME AND LID ADJUST (SPECIAL)	EACH	12
XX004786	ADJUSTMENTS (SPECIAL)	EACH	6

* DENOTES SPECIALTY ITEMS

	Joseph A. Schudt & Associates
	<small>19350 S. HARLEM AVENUE FRANKFORT, IL 60423 PHONE: 708-720-1000 FAX: 708-720-1065 e-mail: jag@jasaeng.com http://www.jasaeng.com</small>

CIVIL ENGINEERING LAND SURVEYING ENVIRONMENTAL LAND PLANNING GPS SERVICES

COPYRIGHT © 2008
 JOSEPH A. SCHUDT & ASSOCIATES
 ALL RIGHTS RESERVED

*Union Avenue
 Street Paving
 30th Street to
 Richton Road*

REVISIONS	
NAME	DATE

ILLINOIS DEPARTMENT OF TRANSPORTATION
SUMMARY OF QUANTITIES
 SHEET 4 OF 10

SCALE: N/A DRAWN BY: J.A.R.
 DATE: 4-4-08 CHECKED BY: S.M.H.

07-22
 07-022-JAR

RT#	CITY SECTION	COUNTY	TOTAL SHEETS	SHEET NO.
2887	07-00083-00-RS	COOK/WILL	10	4
STA.	TO STA.			
FED. RD. DIST. NO.	ILLINOIS	PROJECT- M - 8003 (853)		

CONTRACT # 83969

RT.	CITY SECTION	COUNTY	TOTAL SHEETS	SHEET NO.
2887	07-00083-00-RS	COOK/WILL	10	5
STA. 0+30±		TO STA. 13+54.2±		
FED. RD. DIST. NO.	ILLINOIS	PROJECT - M - 8003 (853)	CONTRACT # 83969	



SHORT TERM PAVEMENT MARKING
 CENTERLINE 4" DOUBLE YELLOW - 4' LONG, 40' MAX. SPACING
 LANE LINE 4" WHITE - 4' LONG, 40' MAX. SPACING

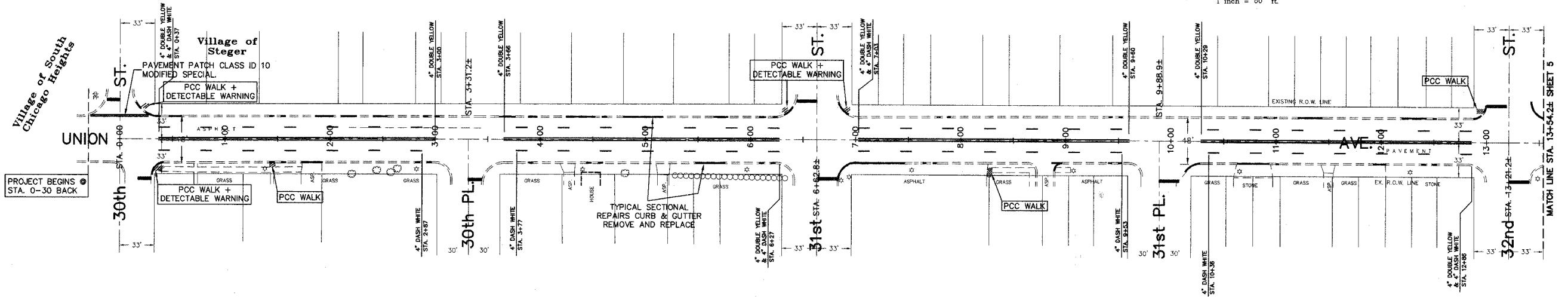

ST 44 STA. 9+46.1±; 21'± RIGHT CATCHBASIN TYPE A RECONSTRUCT w/ TYPE 11 FRAME AND GRATE	ST 42 STA. 6+37.4±; 19'± RIGHT MANHOLE ADJUST	ST 40 STA. 4+51.2±; 23'± RIGHT CATCHBASIN TYPE A RECONSTRUCT FURNISH AND INSTALL GRATE FOR TYPE 11 FRAME	ST 38 STA. 2+88.9±; 22'± RIGHT CATCHBASIN TYPE A RECONSTRUCT FURNISH AND INSTALL GRATE FOR TYPE 11 FRAME	ST 36 STA. 1+50.2±; 22'± LEFT CATCHBASIN TYPE C w/ TYPE 1 FRAME AND OPEN LID	ST 34 STA. 4+54.6±; 21'± LEFT CATCHBASIN TYPE C w/ TYPE 1 FRAME AND OPEN LID	ST 32 STA. 7+83.6±; 22'± LEFT CATCHBASIN TYPE C w/ TYPE 1 FRAME AND OPEN LID	ST 30 STA. 10+95.3±; 23'± LEFT CATCHBASIN TYPE C w/ TYPE 1 FRAME AND OPEN LID	ST 28 STA. 13+43.0±; 38'± RIGHT INLET ADJUST	ST 20 STA. 12+45.5±; 21'± RIGHT CATCHBASIN TYPE A RECONSTRUCT	ST 18 STA. 13+41.5±; 29'± LEFT MANHOLE ADJUST
ST 45 STA. 10+97.1±; 21'± RIGHT CATCHBASIN TYPE A RECONSTRUCT w/ TYPE 11 FRAME AND GRATE	ST 43 STA. 7+70.4±; 22'± RIGHT CATCHBASIN TYPE A RECONSTRUCT	ST 41 STA. 6+16.0±; 22'± RIGHT CATCHBASIN TYPE A RECONSTRUCT	ST 39 STA. 2+96.2±; 17'± RIGHT MANHOLE ADJUST	ST 37 STA. 1+50.7±; 22'± RIGHT CATCHBASIN TYPE A RECONSTRUCT FURNISH AND INSTALL GRATE FOR TYPE 11 FRAME	ST 35 STA. 2+96.1±; 22'± LEFT CATCHBASIN TYPE C w/ TYPE 1 FRAME AND OPEN LID	ST 33 STA. 6+17.6±; 22'± LEFT CATCHBASIN TYPE A w/ TYPE 1 FRAME AND OPEN LID	ST 31 STA. 9+46.5±; 22'± LEFT CATCHBASIN TYPE C w/ TYPE 1 FRAME AND OPEN LID ADJUST w/ NEW FRAME AND CLOSED LID	ST 29 STA. 12+69.6±; 29'± LEFT MANHOLE ADJUST	ST 21 STA. 12+82.0±; 16'± RIGHT MANHOLE ADJUST w/ NEW FRAME AND CLOSED LID	ST 19 STA. 12+45.9±; 23'± LEFT CATCHBASIN TYPE A RECONSTRUCT

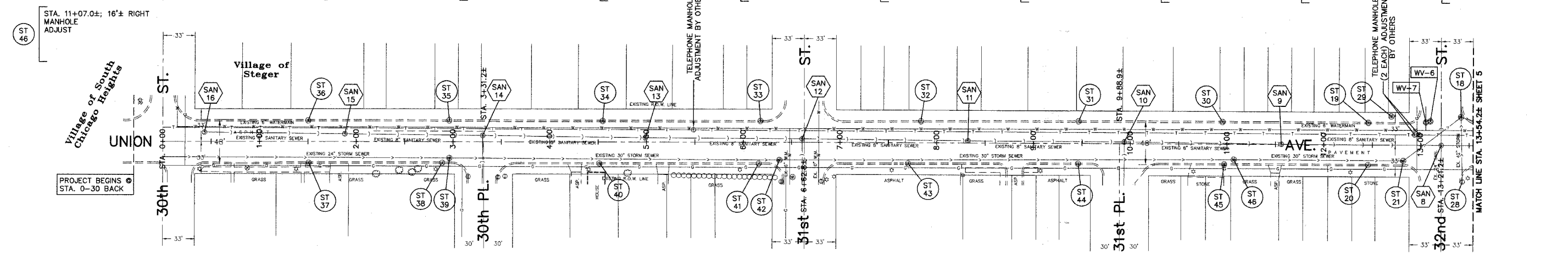

SAN 16 STA. 0+43.1±; 10'± LEFT SANITARY MANHOLE ADJUST	SAN 15 STA. 1+87.6±; 8'± LEFT SANITARY MANHOLE ADJUST	SAN 14 STA. 3+30.6±; 6'± LEFT SANITARY MANHOLE ADJUST	SAN 13 STA. 4+98.2±; 5'± LEFT SANITARY MANHOLE ADJUST	SAN 12 STA. 6+60.9±; 4'± LEFT SANITARY MANHOLE ADJUST	SAN 11 STA. 8+32.8±; 2'± LEFT SANITARY MANHOLE ADJUST	SAN 10 STA. 9+93.7±; 2'± LEFT SANITARY MANHOLE ADJUST	SAN 9 STA. 11+56.6±; 0'± LEFT SANITARY MANHOLE ADJUST	SAN 8 STA. 13+21.2±; 0'± LEFT SANITARY MANHOLE ADJUST	WV-7 STA. 13+05.2±; 23'± LEFT WATER VALVE VAULT ADJUST	WV-6 STA. 13+09.9±; 25'± LEFT WATER VALVE VAULT ADJUST
---	--	--	--	--	--	--	--	--	---	---

Joseph A. Schudt & Associates
 19350 S. HARLEM AVENUE FRANKFORT, IL 60423
 PHONE: 708-720-1000 FAX: 708-720-1065
 e-mail: jas@jasaeng.com http://www.jasaeng.com
 CIVIL ENGINEERING LAND SURVEYING ENVIRONMENTAL LAND PLANNING GPS SERVICES

Union Avenue Street Paving 30th Street to Richton Road

REVISIONS	
NAME	DATE

ILLINOIS DEPARTMENT OF TRANSPORTATION
CONSTRUCTION PLAN
 SHEET 5 OF 10
 SCALE: AS SHOWN DRAWN BY: J.A.R.
 DATE: 4-4-08 CHECKED BY: S.M.H.

07-22
 07-022-JAR

M:\2007\07-022\07-022-PLAN.dwg, 05:40 SCALE, 4/22/08 8:12:28 AM, COPYRIGHT: JOSEPH A. SCHUDT & ASSOCIATES - JAR

RTE.	CITY SECTION	COUNTY	TOTAL SHEETS	SHEET NO.
2887	07-00083-00-RS	COOK/WILL	10	6
STA. 13+54.2±		TO STA. 26+65.6±		
FED. RD. DIST. NO.	ILLINOIS	PROJECT - M - 8003 (853)		
CONTRACT # 8.3.9.6.9				

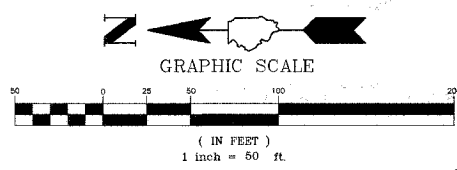

SHORT TERM PAVEMENT MARKING
 CENTERLINE 4" DOUBLE YELLOW - 4' LONG, 40' MAX. SPACING
 LANE LINE 4" WHITE - 4' LONG, 40' MAX. SPACING

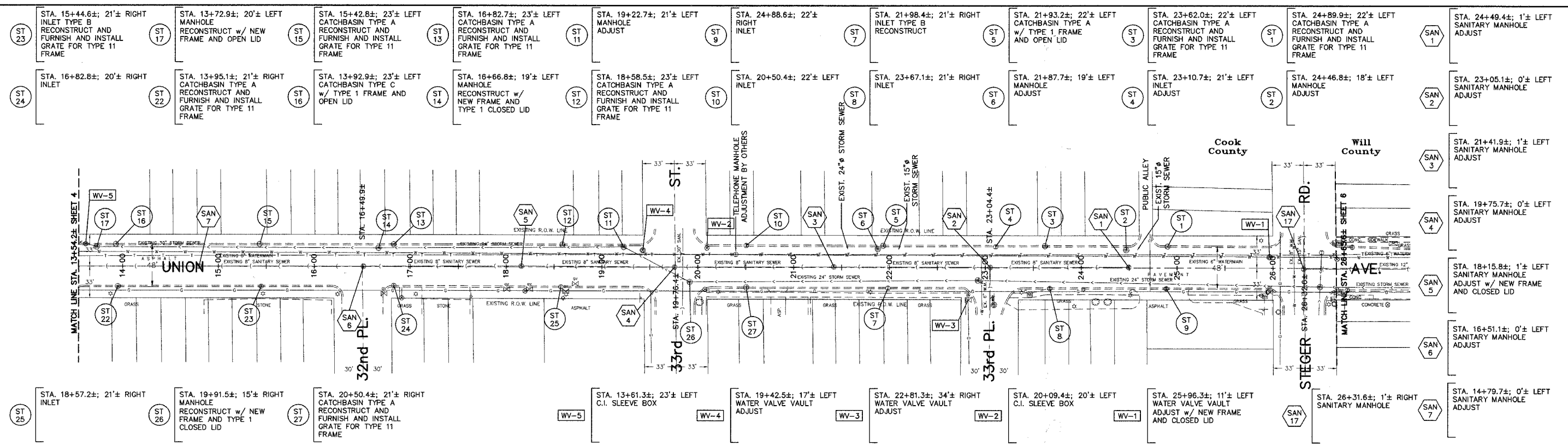
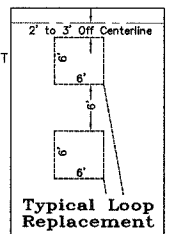
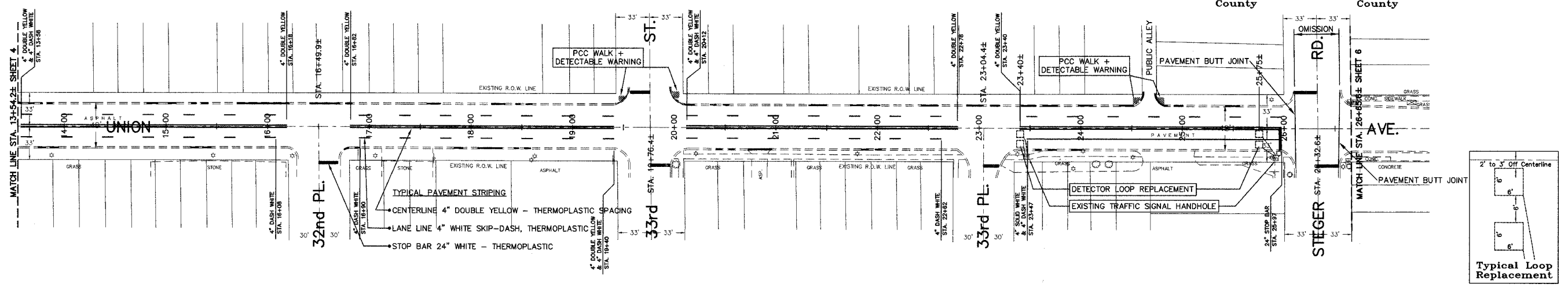

Joseph A. Schudt & Associates
 19350 S. HARLEM AVENUE FRANKFORT, IL 60423
 PHONE: 708-720-1000 FAX: 708-720-1065
 e-mail: jas@joeseng.com http://www.joeseng.com
 CIVIL ENGINEERING LAND SURVEYING ENVIRONMENTAL LAND PLANNING GPS SERVICES

Union Avenue Street Paving 30th Street to Richton Road

REVISIONS	
NAME	DATE

ILLINOIS DEPARTMENT OF TRANSPORTATION
CONSTRUCTION PLAN
 SHEET 6 OF 10
 SCALE: AS SHOWN DRAWN BY: J.A.R.
 DATE: 4-4-08 CHECKED BY: S.M.H.

07-22
07-022-JAR

M:\000707\025\0707-602-JAR.dwg, 08-30 SCALE: 40208 P=11 H:\M\COPYRIGHT JOSEPH A. SCHUDT & ASSOCIATES, JAR

RTE.	CITY SECTION	COUNTY	TOTAL SHEETS	SHEET NO.
2887	07-00083-00-RS	COOK/WILL	10	7
STA. 26+65.6±		TO STA. 39+39.2±		
FED. RD. DIST. NO.	ILLINOIS	PROJECT - M - 8003 (853)		
CONTRACT # 8 3 9 6 9				

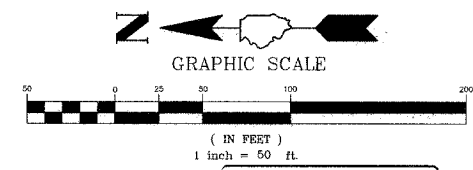

SHORT TERM PAVEMENT MARKING
 CENTERLINE 4" DOUBLE YELLOW - 4' LONG, 40' MAX. SPACING
 LANE LINE 4" WHITE - 4' LONG, 40' MAX. SPACING

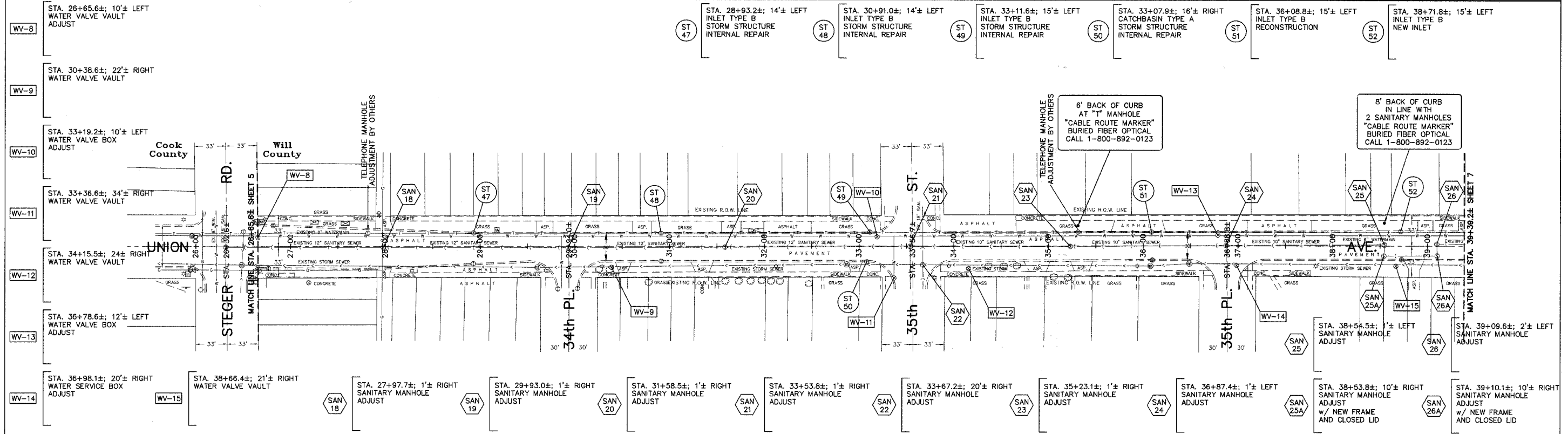
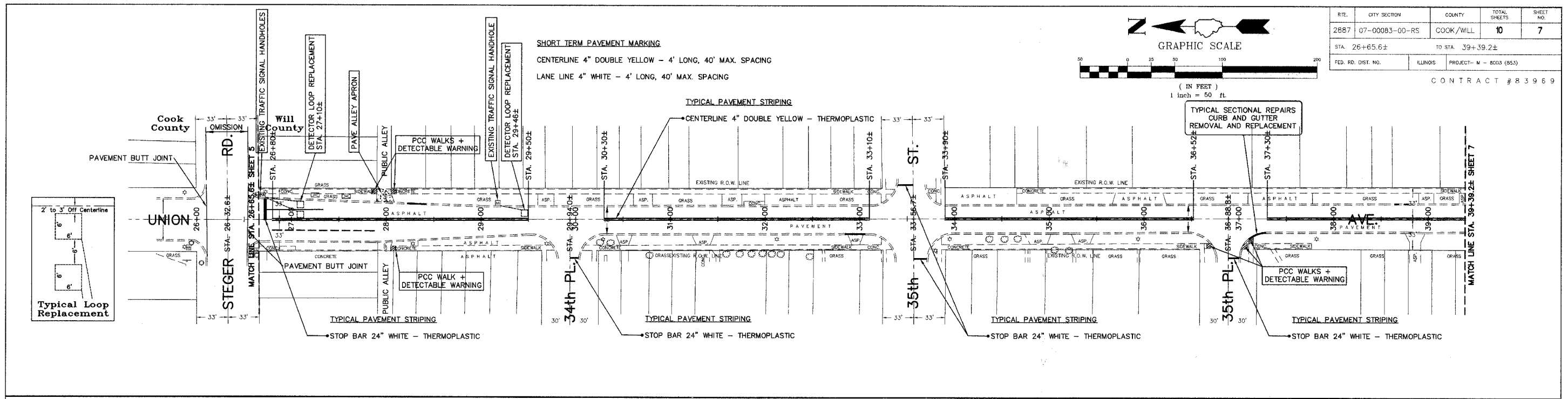

Joseph A. Schudt & Associates
 19350 S. HARLEM AVENUE FRANKFORT, IL 60423
 PHONE: 708-720-1000 FAX: 708-720-1065
 e-mail: jas@jaseng.com http://www.jaseng.com
 CIVIL ENGINEERING LAND SURVEYING ENVIRONMENTAL LAND PLANNING GPS SERVICES

*Union Avenue Street Paving
 30th Street to Richton Road*

REVISIONS	
NAME	DATE

ILLINOIS DEPARTMENT OF TRANSPORTATION
CONSTRUCTION PLAN
 SHEET 7 OF 10
 SCALE: AS SHOWN DRAWN BY: J.A.R.
 DATE: 4-4-08 CHECKED BY: S.M.H.
 07-22
 07-022-SOUTH

M:\2007\07-022-SOUTH.dwg (17:46 SCALE: 4200Wx8134H) ANI COPYRIGHT © JOSEPH A. SCHUDT & ASSOCIATES, L.P.

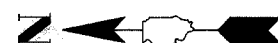

ROUTE	CITY SECTION	COUNTY	TOTAL SHEETS	SHEET NO.
2887	07-00083-00-RS	COOK/WILL	10	8
STA. 39+39.2±		TO STA. 50+54.1±		
FED. RD. DIST. NO.	ILLINOIS	PROJECT - M - 8003 (853)		

CONTRACT # 83969

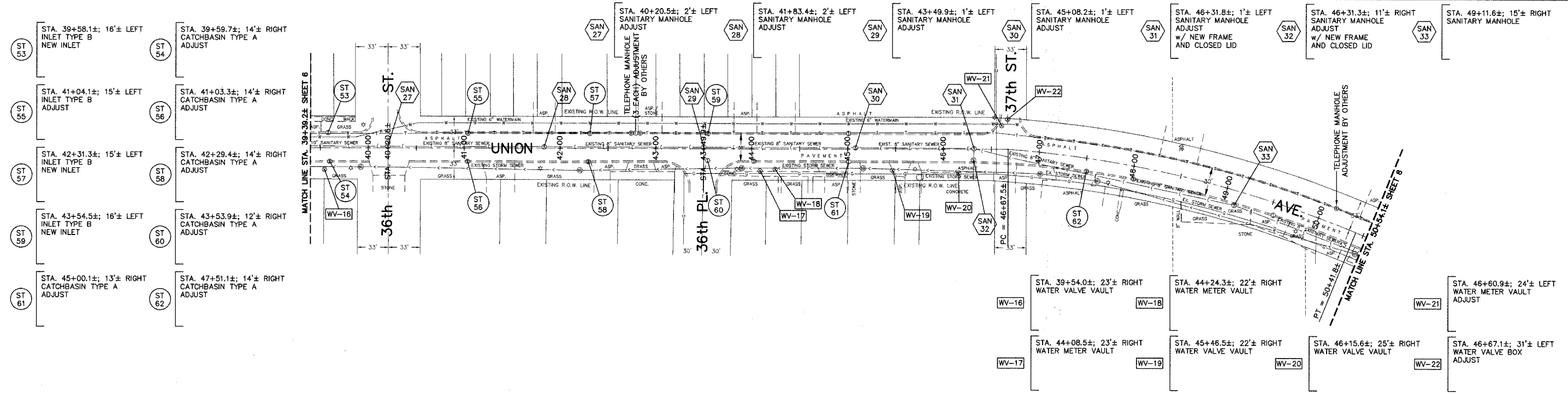
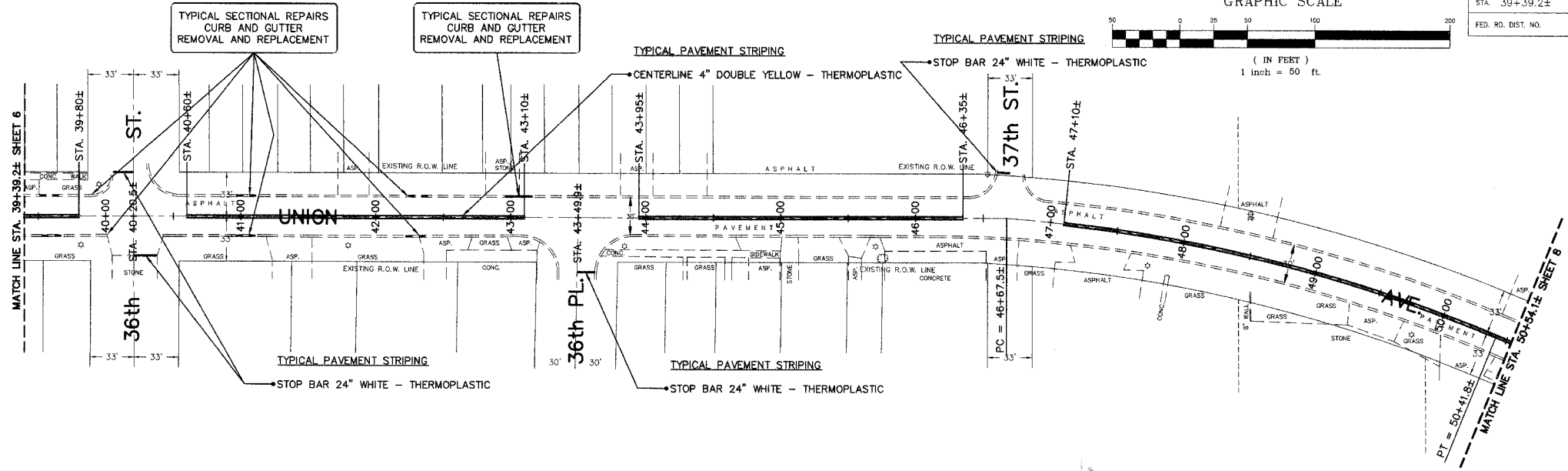

Joseph A. Schudt & Associates
 19350 S. HARLEM AVENUE FRANKFORD, IL 60423
 PHONE: 708-720-1000 FAX: 708-720-1065
 e-mail: jas@jaseg.com http://www.jaseg.com
 CIVIL ENGINEERING LAND SURVEYING ENVIRONMENTAL LAND PLANNING GPS SERVICES

Union Avenue Street Paving 30th Street to Richton Road

REVISIONS	
NAME	DATE

ILLINOIS DEPARTMENT OF TRANSPORTATION
CONSTRUCTION PLAN
SHEET 8 OF 10
 SCALE: AS SHOWN DRAWN BY: J.A.R.
 DATE: 4-4-08 CHECKED BY: S.M.H.

07-22
07-022-SOUTH

M:\000707-022-SOUTH.dwg 08-30 SCALE: 472/08 8:14:27 AM COPYRIGHT: JOSEPH A. SCHUDT & ASSOCIATES, INC.

RTE.	CITY SECTION	COUNTY	TOTAL SHEETS	SHEET NO.
2887	07-00083-00-RS	COOK/WILL	10	9
STA. 50+54.1±		TO STA. 60+15±		
FED. RD. DIST. NO.	ILLINOIS	PROJECT - M - 8003 (853)		

CONTRACT # 83969

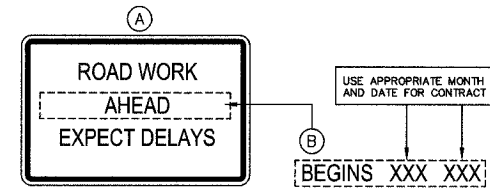
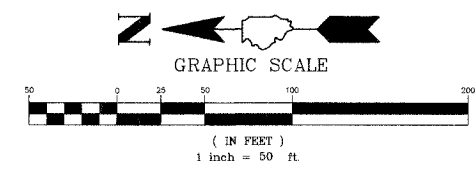

TC-22

NOTES:

1. USE BLACK LETTERING ON ORANGE BACKGROUND.
2. ERECT SIGNS IN ADVANCE OF THE LOCATION FOR THE "ROAD CONSTRUCTION AHEAD" SIGN AT LOCATIONS AS DIRECTED BY THE ENGINEER.
3. ERECT SIGN (A) WITH INSTALLED PANEL (B) ONE WEEK PRIOR TO THE START OF CONSTRUCTION.
4. REMOVE PANEL (B) SOON AFTER THE START OF CONSTRUCTION.
5. ONE SIGN ASSEMBLY EQUALS 25.7 SQ. FT.

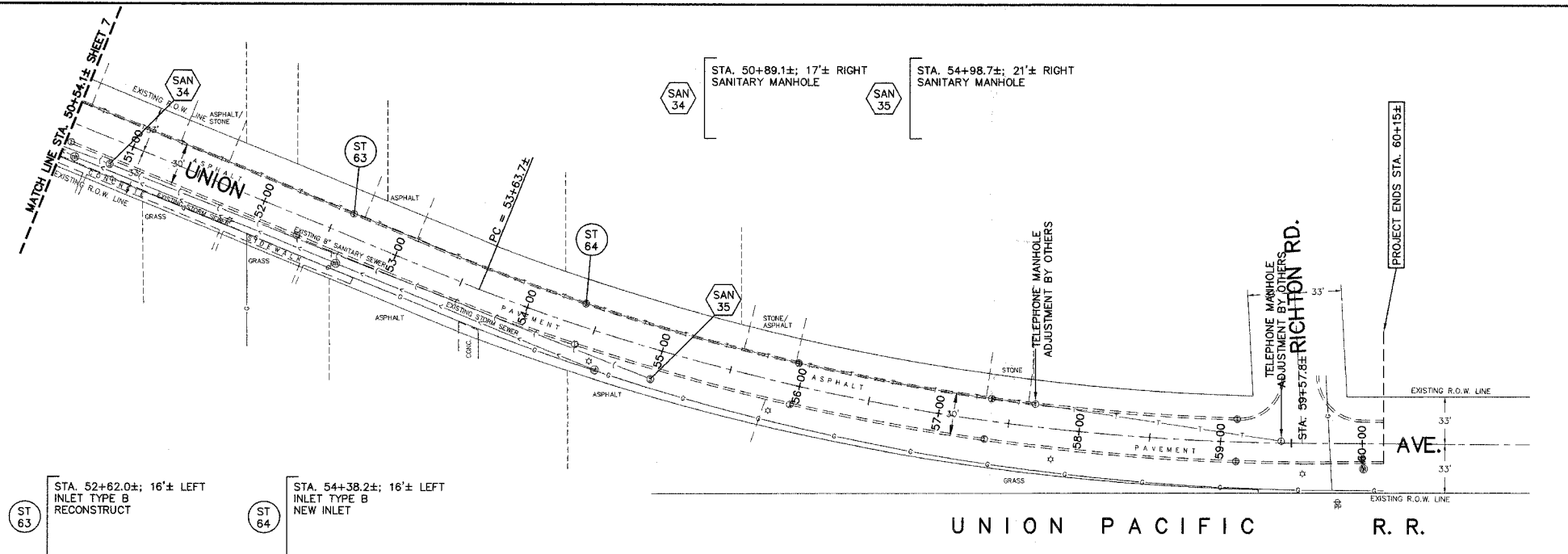
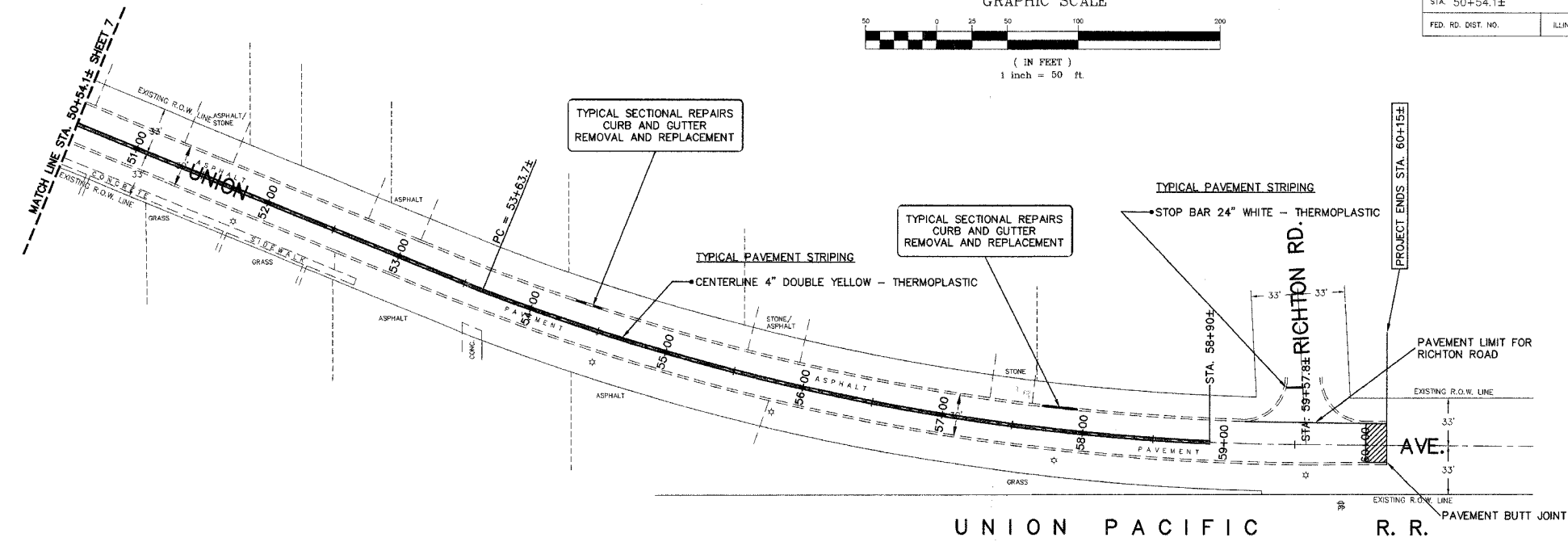

Joseph A. Schudt & Associates
 19350 S. HARLEM AVENUE FRANKFORT, IL 60423
 PHONE: 708-720-1000 FAX: 708-720-1065
 e-mail: jas@jseeng.com http://www.jseeng.com
 CIVIL ENGINEERING LAND SURVEYING ENVIRONMENTAL LAND PLANNING GPS SERVICES

COPYRIGHT © 2008
 JOSEPH A. SCHUDT & ASSOCIATES
 ALL RIGHTS RESERVED

Union Avenue Street Paving 30th Street to Richton Road

REVISIONS	
NAME	DATE

ILLINOIS DEPARTMENT OF TRANSPORTATION
CONSTRUCTION PLAN
 SHEET 9 OF 10
 SCALE: AS SHOWN DRAWN BY: J.A.R.
 DATE: 4-4-08 CHECKED BY: S.M.H.

07-22
 07-022-SOUTH

M:\0007\07-022\07-022-SOUTH\1.dwg, 08-06-08 SCALE: 4:2008 8:14:58 AM, COPYRIGHT, JOSEPH A. SCHUDT & ASSOCIATES, J.A.S.

RTE.	CITY SECTION	COUNTY	TOTAL SHEETS	SHEET NO.
2887	07-00083-00-RS	COOK/WILL	10	10
STA.	TO STA.			
FED. RD. DIST. NO.	ILLINOIS	PROJECT - M - 8003 (853)		

CONTRACT # 83969

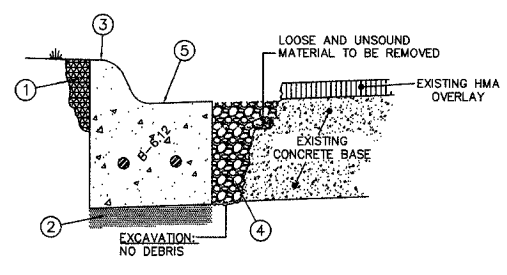

- BACK OF CURB RESTORATION BY TOPSOIL AND CLASS 1 SEED.
- EXISTING AGGREGATE TO REMAIN, CONTRACTOR TO ADD AS NEEDED.
- DEPRESSED AT DRIVEWAYS, ADA SIDEWALKS AND AS DIRECTED BY ENGINEER TO MATCH PARKWAY GRADE.
- EXCAVATION SPACE TO BE FILLED WITH CONCRETE WHILE PLACING CURB. FINISH TO GRADE OF EXISTING CONCRETE BASE.
- GUTTER TO BE HMA OVERLAYED. NORMAL FINISH OF GUTTER STILL REQUIRED.

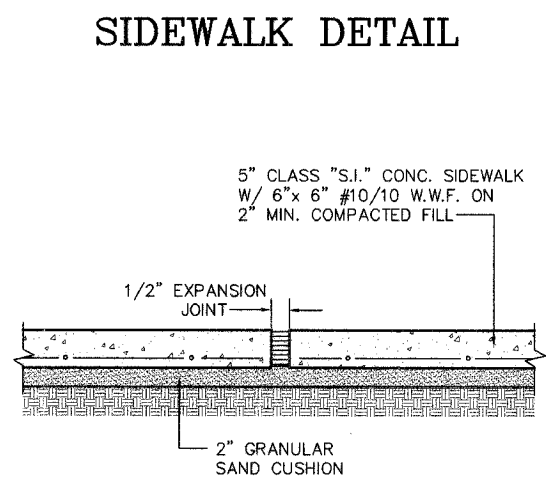
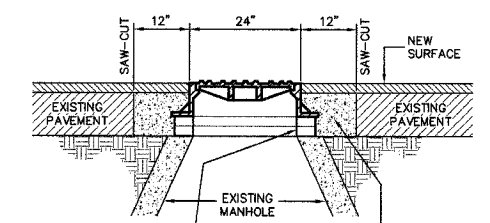

NOTE:
Place 3-#5 reinforcing bars
8 ft. long at all trench crossings.
A bar shall be placed at center of
walk and 1 ft. on either side.

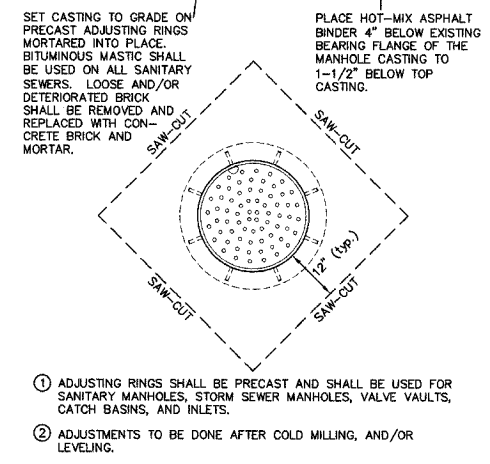

- ADJUSTING RINGS SHALL BE PRECAST AND SHALL BE USED FOR SANITARY MANHOLES, STORM SEWER MANHOLES, VALVE VAULTS, CATCH BASINS, AND INLETS.
- ADJUSTMENTS TO BE DONE AFTER COLD MILLING, AND/OR LEVELING.

RECONSTRUCT CATCHBASIN TYPE A OR RECONSTRUCT INLET TYPE B

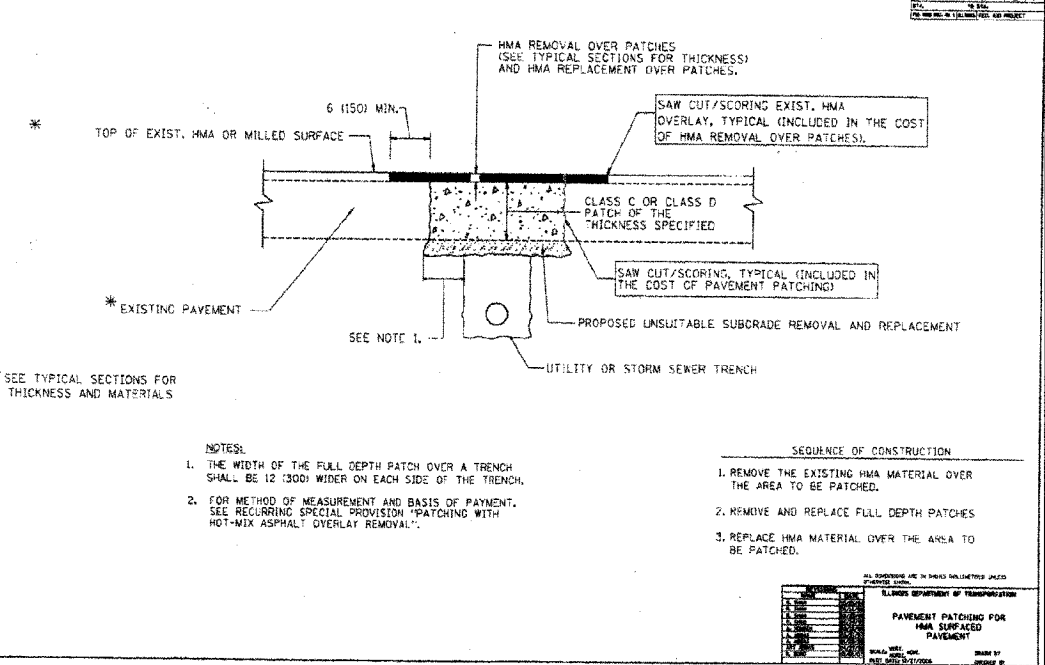
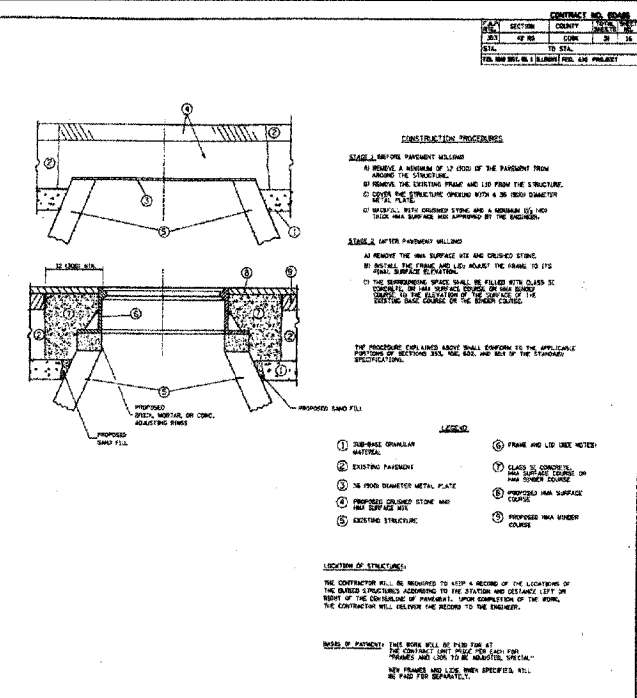
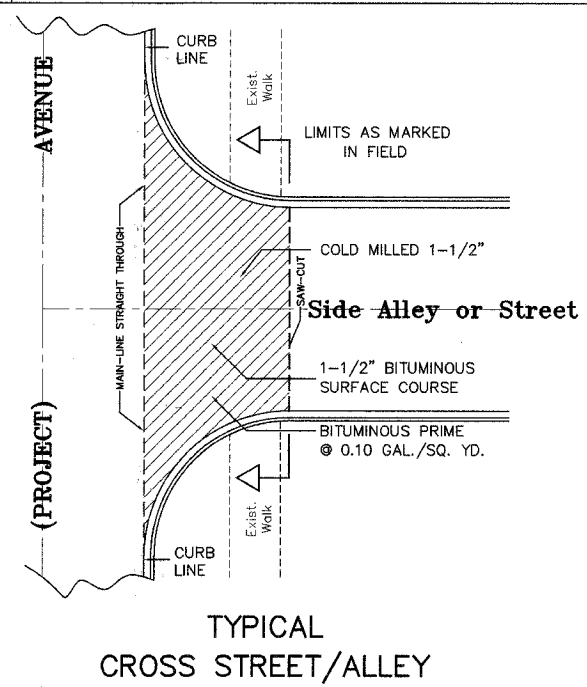
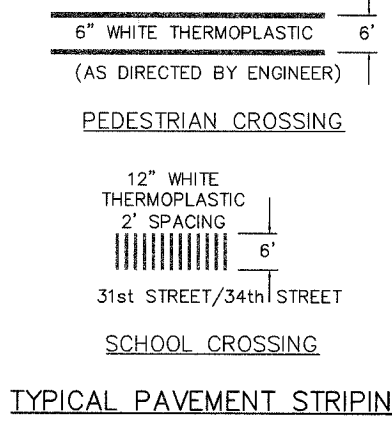
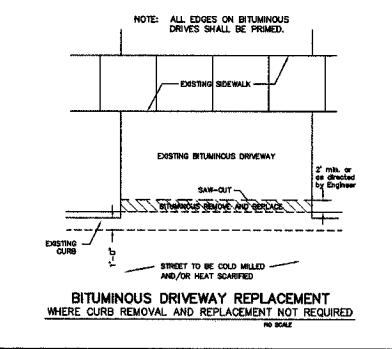
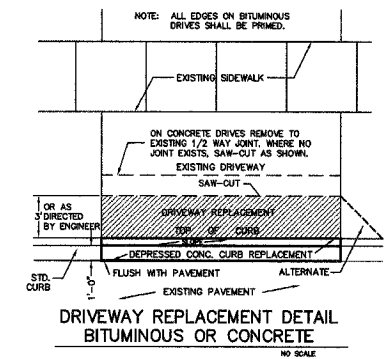
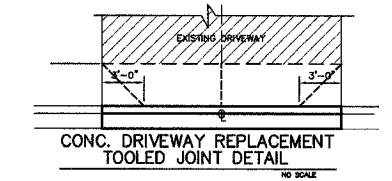
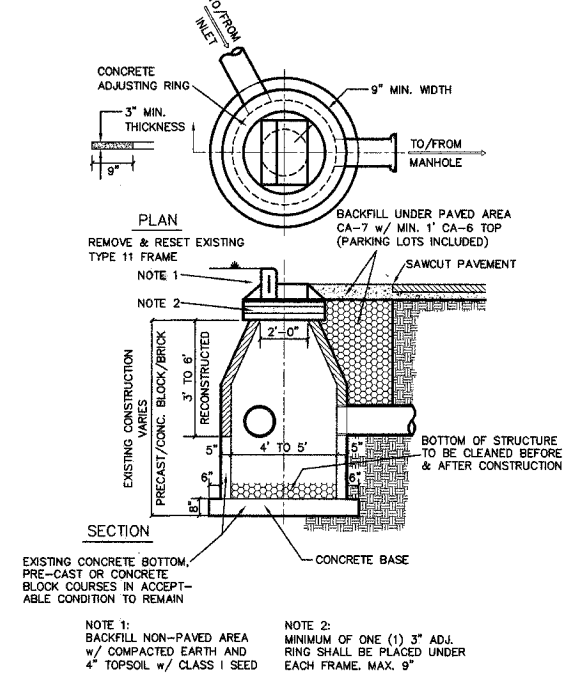

Joseph A. Schudt & Associates

19350 S. HARLEM AVENUE FRANKFORT, IL 60423
PHONE: 708-720-1000 FAX: 708-720-1065
e-mail: jaa@jasaeng.com http://www.jasaeng.com

CIVIL ENGINEERING LAND SURVEYING ENVIRONMENTAL LAND PLANNING GPS SERVICES

COPYRIGHT © 2008
JOSEPH A. SCHUDT & ASSOCIATES
ALL RIGHTS RESERVED

Village of Steger
Union Avenue Street Paving
30th Street to Richton Road

REVISIONS	
NAME	DATE

ILLINOIS DEPARTMENT OF TRANSPORTATION

MISCELLANEOUS DETAILS
SHEET 10 OF 10

SCALE: AS SHOWN DRAWN BY: J.A.R.
DATE: 4-4-08 CHECKED BY: S.M.H.

07-22
07-022-JAR

M:\0007074222\074222.dwg, 10:42:28 AM, 5/11/08 AM, COPYRIGHT JOSEPH A. SCHUDT & ASSOCIATES, INC.