

J.U.L.I.E.
 JOINT UTILITY LOCATION INFORMATION FOR EXCAVATION
 1-800-892-0123

STATE OF ILLINOIS

DEPARTMENT OF TRANSPORTATION

DIVISION OF HIGHWAYS

SURFACE TRANSPORTATION URBAN PROGRAM

FAU 6208 (CARDINAL DRIVE)

VILLAGE OF BRADLEY

SECTION 07-00093-00-RP
 PROJECT NO. M-5034(18)
 JOB NO. C-93-041-07

F.A.U. RTE.	SECTION	COUNTY	TOTAL SHEETS	SHEET NO.
6208	07-00093-00-RP	KANKAKEE	43	01
MG2A# M2-096			CONTRACT NO.: 87342	

INDEX OF SHEETS

- 01 COVER SHEET
- 02 GENERAL NOTES
- 03 SUMMARY OF QUANTITIES
- 04 TYPICAL SECTIONS
- 05-08 SCHEDULES
- 09 ALIGNMENT, TIES & BENCHMARKS
- 10-18 PLAN & PROFILE - CARDINAL DR.
- 19-21 PAVEMENT MARKING
- 22-23 STORM WATER POLLUTION PREVENTION PLAN
- 24-25 DETAILS
- 26 TRAFFIC CONTROL & DETOUR MAP
- 27-43 CROSS SECTIONS - CARDINAL DR.

HIGHWAY STANDARDS

- 280001-04 TEMPORARY EROSION CONTROL SYSTEMS
- 424001-05 CURB RAMPS FOR SIDEWALKS
- 542301-01 PRECAST REINFORCED CONCRETE FLARED END SECTION
- 542306-01 PRECAST REINFORCED CONCRETE ELLIPTICAL FLARED END SECTION
- 542311 GRATING FOR CONCRETE FLARED END SECTION
- 602301-01 INLET - TYPE A
- 602306-01 INLET - TYPE B
- 602401-01 MANHOLE, TYPE A
- 602406-02 MANHOLE, TYPE A (6") DIAMETER
- 602411 MANHOLE, TYPE A (7") DIAMETER
- 602601-01 PRECAST REINFORCED CONCRETE FLAT SLAB TOP
- 604001-02 FRAME AND LIDS, TYPE 1
- 604051-02 FRAME AND GRATE, TYPE 11
- 604056-02 FRAME AND GRATE, TYPE 11V
- 606001-03 CONCRETE CURB TYPE B AND COMBINATION CONCRETE CURB AND GUTTER
- 701006-02 OFF-RD OPERATIONS, 2L, 2W, 15'-24" FROM PAVEMENT EDGE
- 701011-01 OFF-RD MOVING OPERATIONS, 2L, 2W, DAY ONLY
- 701301-02 LANE CLOSURE, 2L, 2W, SHORT TIME OPERATIONS
- 701501-04 URBAN LANE CLOSURE, 2L, 2W UNDIVIDED
- 701901 TRAFFIC CONTROL DEVICES
- 720006-01 SIGN PANEL ERECTION DETAILS
- 728001 TELESCOPING STEEL SIGN SUPPORT
- 780001-01 TYPICAL PAVEMENT MARKINGS
- BLR 22-5 TYPICAL APPLICATIONS OF TRAFFIC CONTROL DEVICES FOR CONSTRUCTION ON RURAL LOCAL HIGHWAYS

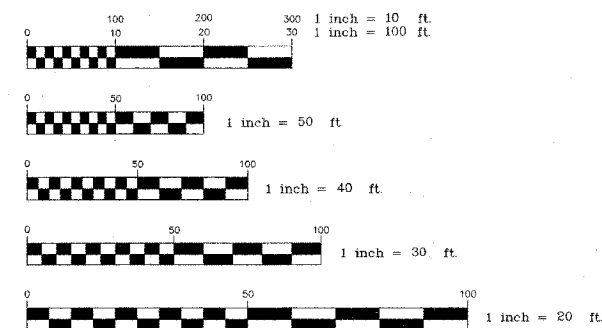

FULL SIZE PLANS HAVE BEEN PREPARED USING STANDARD ENGINEERING SCALES. REDUCED SIZED PLANS WILL NOT CONFORM TO STANDARD SCALES. IN MAKING MEASUREMENTS ON REDUCED PLANS, THE ABOVE SCALES MAY BE USED.

CONTRACT NO.: 87342

FUNCTIONAL CLASSIFICATION- URBAN TWO WAY COLLECTOR
 CURRENT 2007 ADT = 3250 M.U. 1% S.U. 4% P.V. 95%
 DESIGN 2028 ADT = 9100 M.U. 1% S.U. 4% P.V. 95%
 DESIGN SPEED - 30 M.P.H.

THIS PROJECT IS BUILT IN ACCORDANCE WITH URBAN RECONSTRUCTION POLICIES AS OUTLINED IN THE BUREAU OF LOCAL ROADS & STREETS MANUAL

CARDINAL DR.
 END OF IMPROVEMENTS STA. 104+68

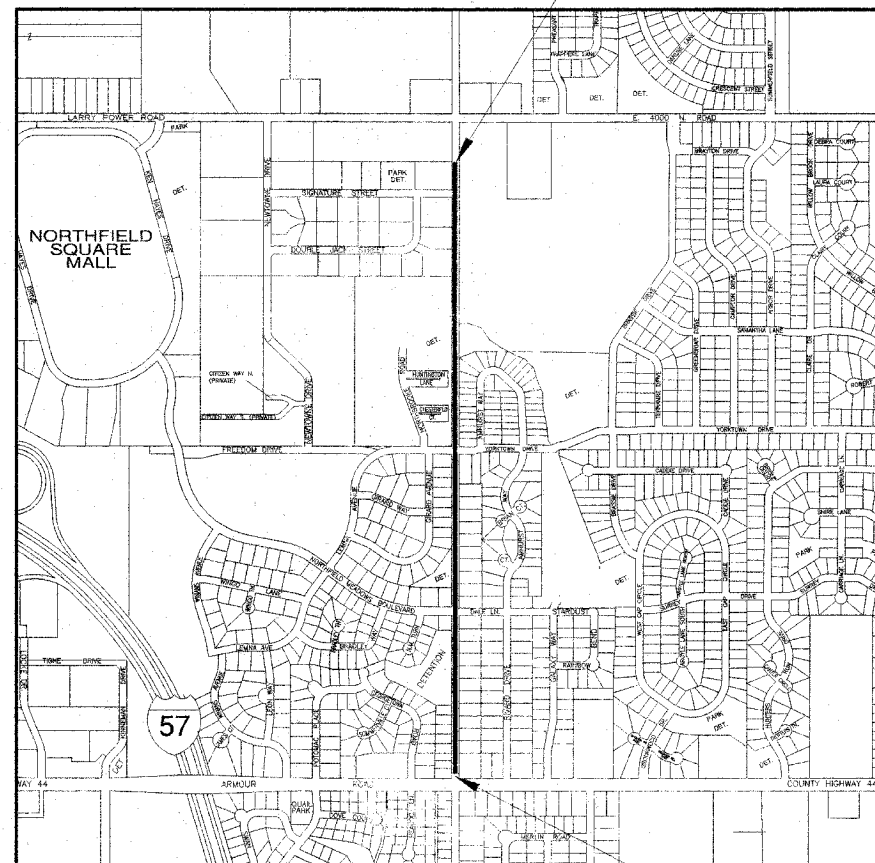

TOWNSHIP 31 N RANGE 12 E

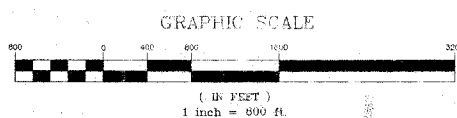

CARDINAL DR.
 BEGIN IMPROVEMENTS STA. 56+36

GROSS LENGTH - 4832 FT. = 0.915 MILES
 NET LENGTH - 4832 FT. = 0.915 MILES

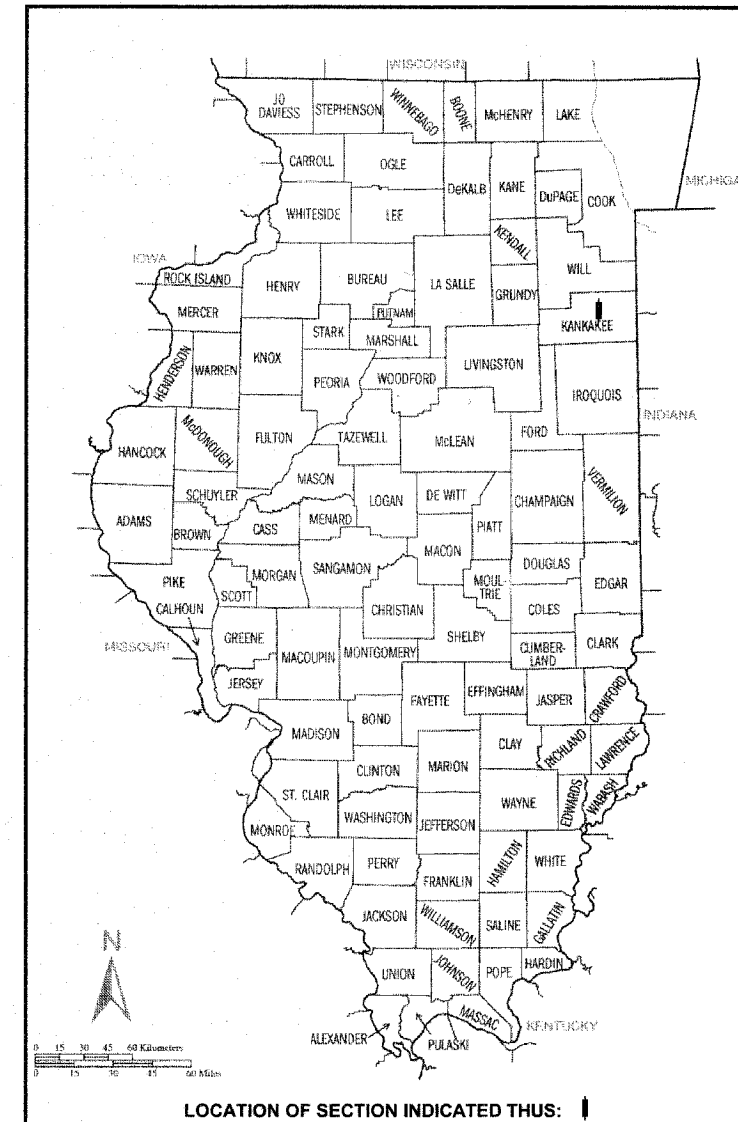

STATE OF ILLINOIS
 DEPARTMENT OF TRANSPORTATION
 DIVISION OF HIGHWAYS

APPROVED: [Signature] [Signature] 4/2/08
 VILLAGE OF BRADLEY TITLE DATE

PASSED: [Signature] 5/20/08
 DISTRICT 3 ENGINEER OF LOCAL ROADS AND STREETS DATE

RELEASED FOR BID
 BASED ON LIMITED REVIEWS:
[Signature] 05/20/08
 DEPUTY DIRECTOR OF HIGHWAYS, REGION 2 ENGINEER DATE

[Signature] 9-3-08
 MICHAEL A. GINGERICH P.E. # 062-049765 DATE

EXPIRATION DATE OF P.E. LICENSE: 11-30-2009

PRINTED BY THE AUTHORITY OF THE STATE OF ILLINOIS

REVISIONS		
DATE	BY	DESCRIPTION
2/11/08	AJC/JWP	PER IDOT REVIEW
3/27/08	JWP	PER IDOT REVIEW

ILLINOIS DEPARTMENT OF TRANSPORTATION
 COVER SHEET
 CARDINAL DRIVE

SCALE: _____ DRAWN BY: MJO/AJC
 DATE: 1/4/08 CHECKED BY: JWP