

DATE	
BY	
SURVEYED	
PLOTTED	
NOTE DATE	
AREAS CHECKED	
FINAL SURVEY	
NOTE BOOK	
NO.	

DATE	
BY	
SURVEYED	
PLOTTED	
NOTE DATE	
AREAS CHECKED	
ORIGINAL SURVEY	
NOTE BOOK	
NO.	

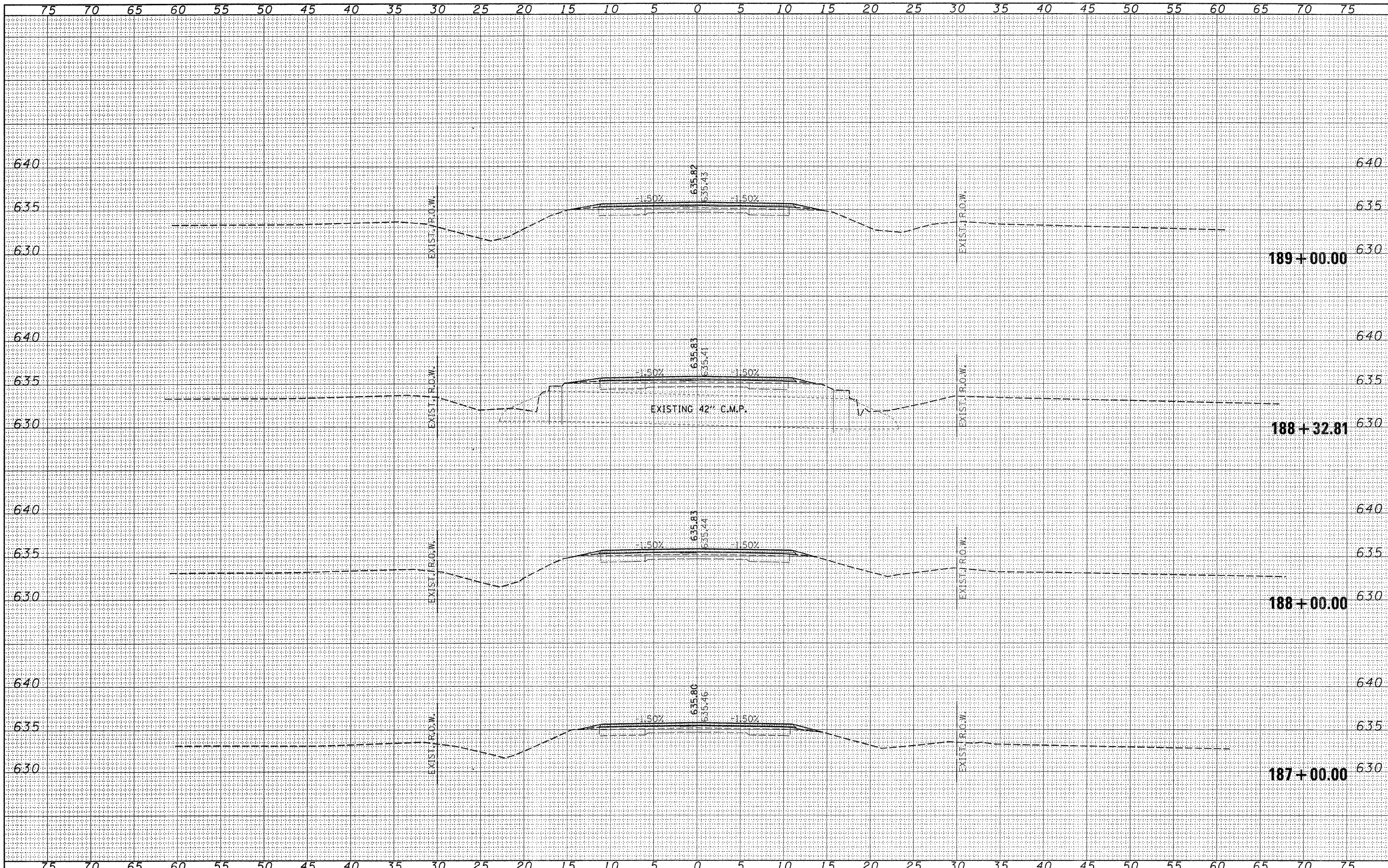

FILE NAME = 48002-sh1-xxx.dgn

USER NAME =
 DESIGNED - LFS
 DRAWN - WJS
 PLOT SCALE =
 PLOT DATE = 5/13/2008

REVISED -
 REVISED -
 REVISED -
 REVISED -

STATE OF ILLINOIS
 COUNTY HIGHWAY DEPARTMENT

HLR HAMPTON, LENZINI & RENWICK, INC.
 CIVIL & STRUCTURAL ENGINEERS
 LAND SURVEYORS
 SCALE: 5:5 SHEET NO. OF SHEETS

CROSS SECTIONS
F.A.S. 321 / C.H. 4

STA. 187+00.00 TO STA. 189+00.00

F.A.S.	SECTION	COUNTY	TOTAL SHEETS	SHEET NO.
321	05-00205-02-RS	IRROUOIS	76	75
CONTRACT NO. 87363				
FED. ROAD DIST. NO. ILLINOIS FED. AID PROJECT				