

ROUTE NO.	DISTRICT	COUNTY	TOTAL SHEETS	SHEET NO.
F.A.U. 6755	*	TAZEWELL	39	30

FED. ROAD DIST. NO. 7 ILLINOIS PROJECT M-8003-112

04-00114-00-PV
CONTRACT NO. 88351

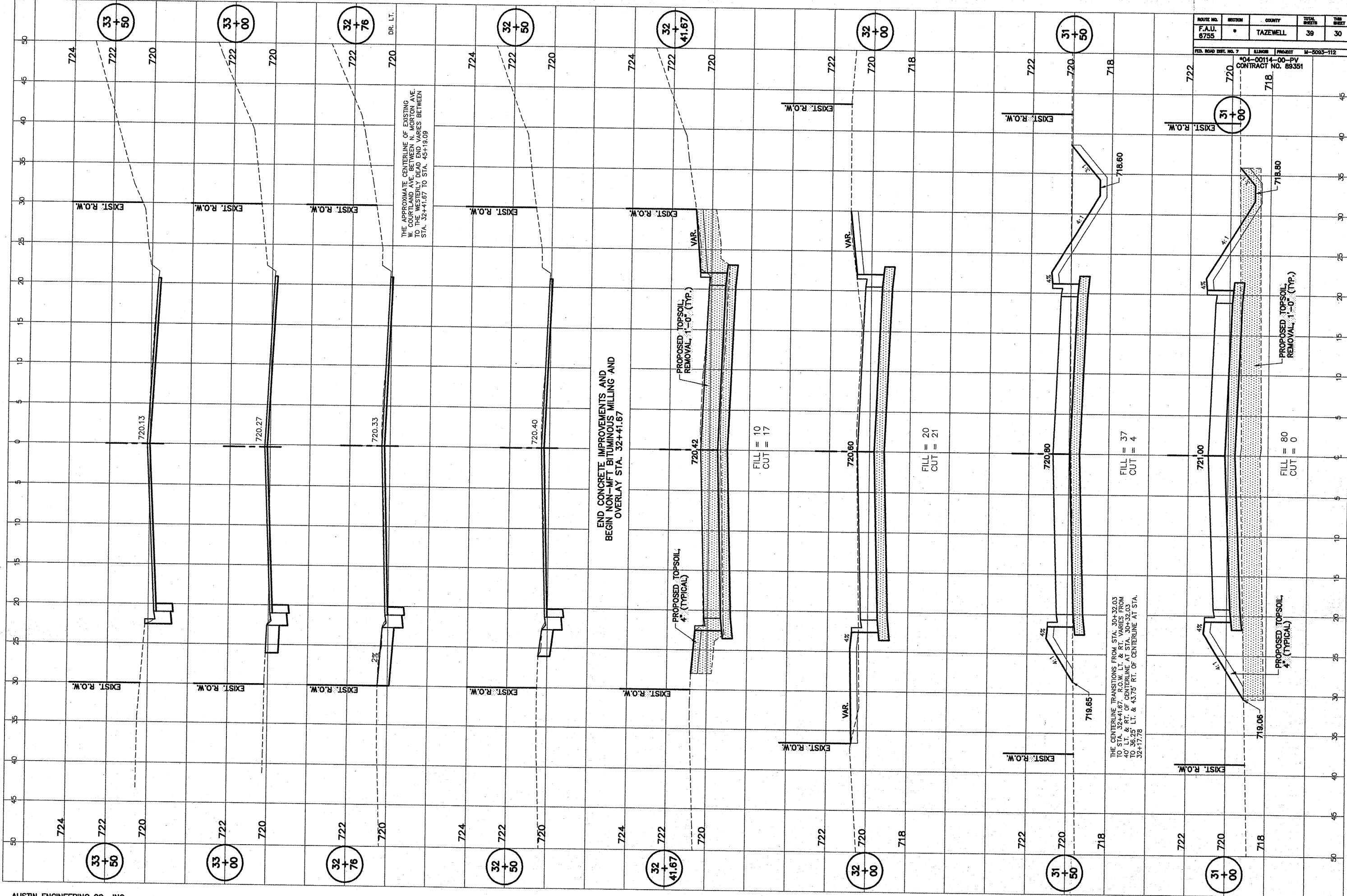

DR. LT.
THE APPROXIMATE CENTERLINE OF EXISTING W. COURTLAND AVE. BETWEEN N. MORTON AVE. TO THE WESTERLY DEAD END VARIES BETWEEN STA. 32+41.67 TO STA. 43+19.09

END CONCRETE IMPROVEMENTS AND BEGIN NON-MFT. BITUMINOUS MILLING AND OVERLAY STA. 32+41.67

THE CENTERLINE TRANSITIONS FROM STA. 30+32.03 TO STA. 32+41.67, R.O.W. LT. & RT. VARIES FROM 40' LT. & RT. OF CENTERLINE AT STA. 30+32.03 TO 36.25' LT. & 43.75' RT. OF CENTERLINE AT STA. 32+41.67