

T.R.	SECTION	COUNTY	TOTAL SHEETS	SHEET NO.
50	04-12112-00-BR 04-10100-00-BR		20	3
STA.		TO STA.		
FED. ROAD DIST. NO.		ILLINOIS FED. AID PROJECT		
SHELBY & CHRISTIAN				

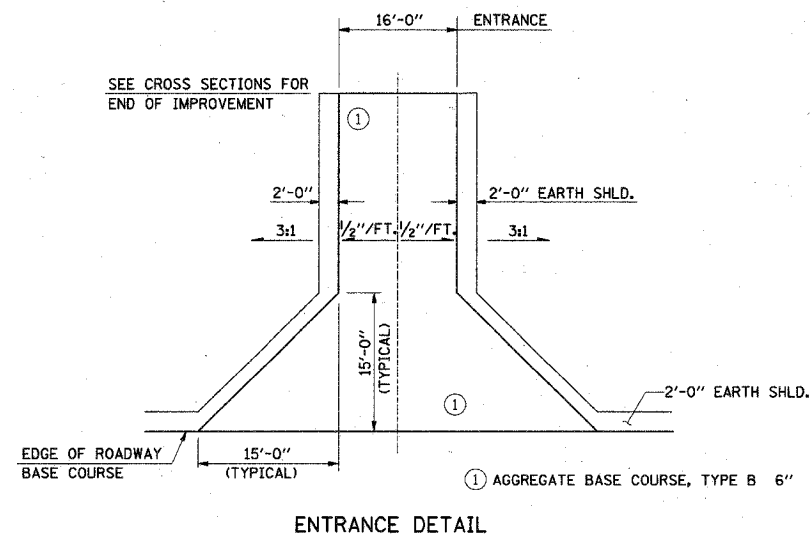

P.O.T. - P.K. NAIL STA. 10+00.00

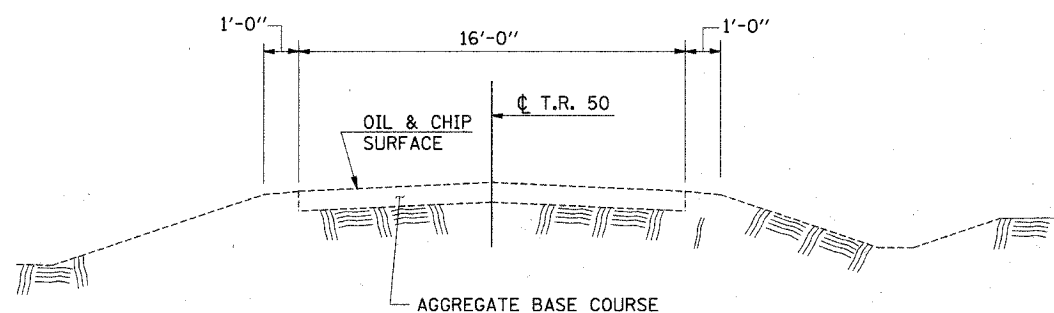
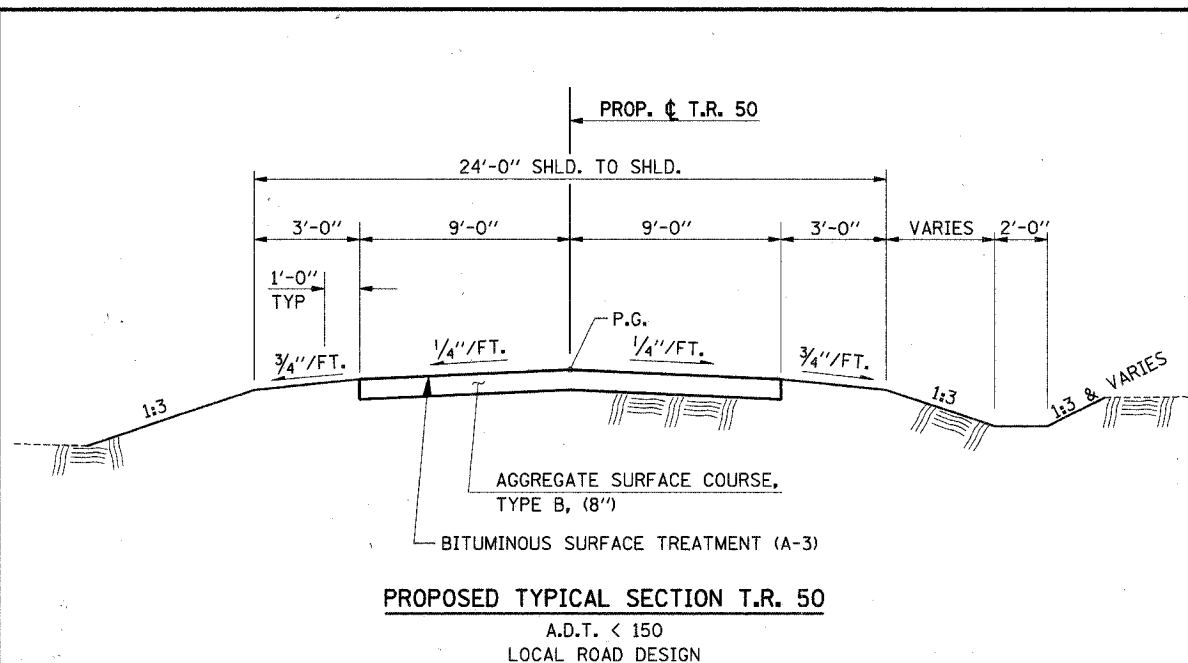
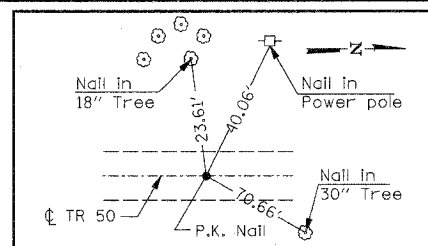

P.I. CURVE 1 - P.K. NAIL STA. 12+00.09

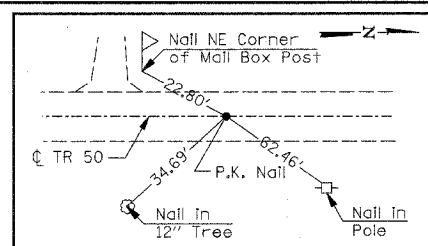

P.I. CURVE 2 - REBAR STA. 14+00.11

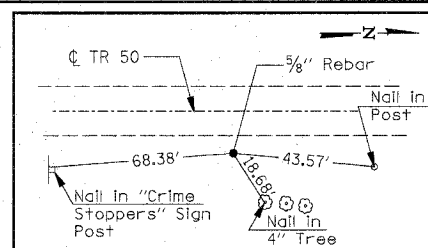

P.I. CURVE 3 - REBAR STA. 21+21.03

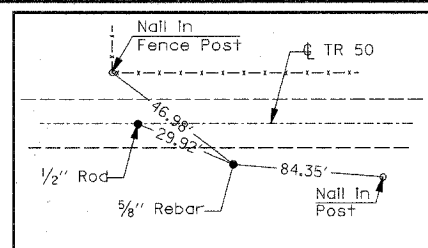

P.I. CURVE 4 - P.K. NAIL STA. 23+12.31

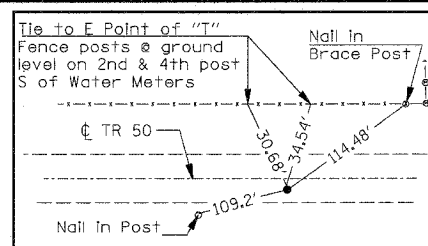

P.O.T. - P.K. NAIL STA. 28+00.28

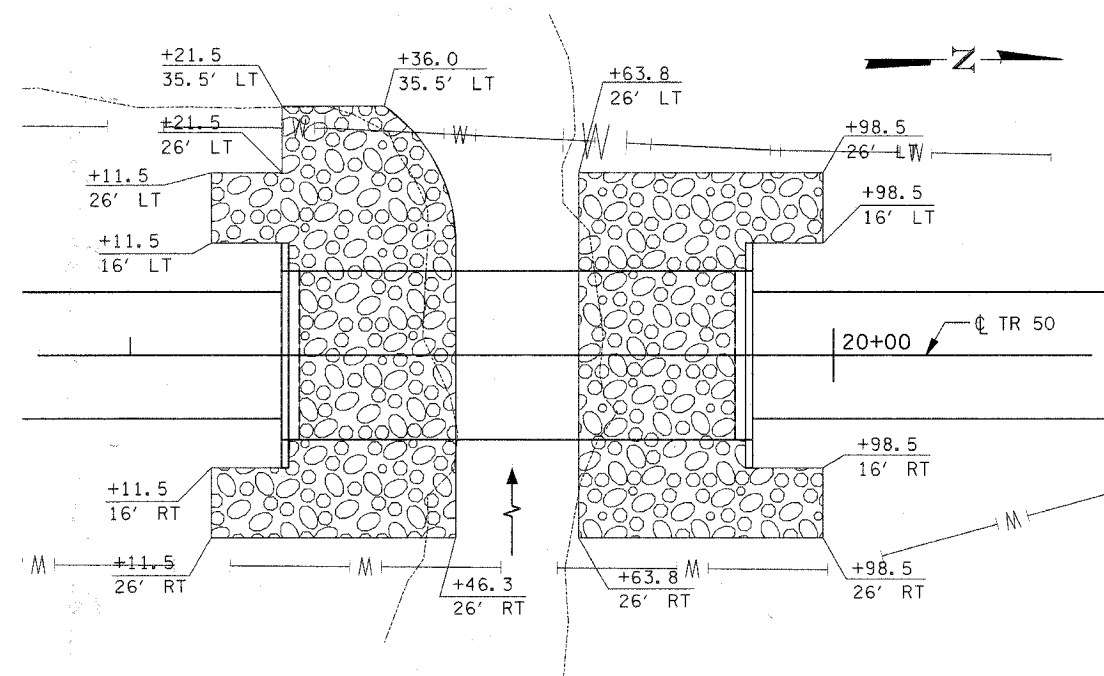
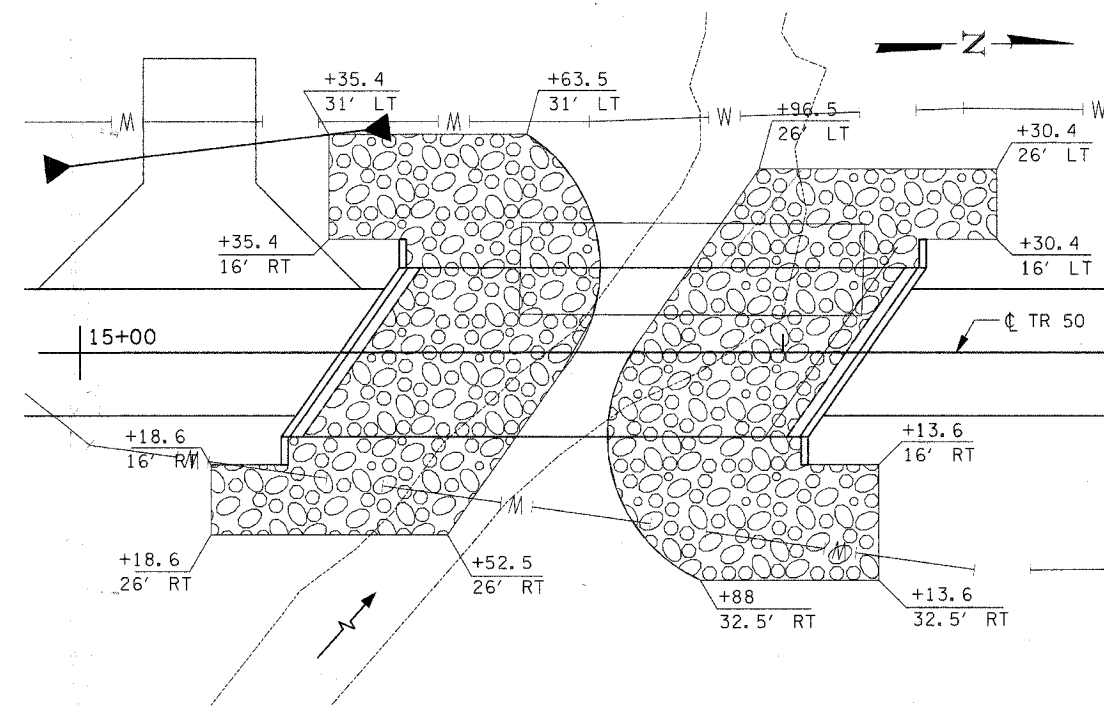
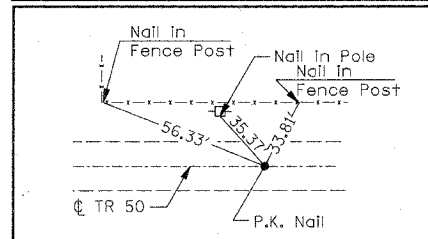

NOTE:
Location of watermain is approximate. Contractor shall dig test pits to locate prior to driving piles. See Special Provisions

FILE: G:\3085027\040\5027TS.SHT 2:55:05 PM