

STATE OF ILLINOIS  
DEPARTMENT OF TRANSPORTATION

PLANS FOR PROPOSED  
HIGHWAY BRIDGE PROGRAM

TR 454 OVER HICKORY CREEK  
SECTION 06-19125-00-BR  
FAYETTE COUNTY  
PROJECT NO. BROS-051(79)  
C-97-013-08

ROUTE	SECTION	COUNTY	TOTAL SHEETS	SHEET NO.
TR 454	06-19125-00-BR	FAYETTE	9	1
FED. ROAD DIST. NO. 7 ILLINOIS		FEDERAL AID PROJECT		
CONTRACT NO. 95532				

INDEX OF SHEETS

- COVER SHEET
- SUMMARY OF QUANTITIES AND TYPICAL SECTIONS
- PLAN AND PROFILE OF ROADWAY
- CROSS SECTIONS OF ROADWAY
- GENERAL PLAN AND ELEVATION
- PRECAST PRESTRESSED CONCRETE DECK BEAM DETAILS
- STEEL RAILING, TYPE S1 DETAILS
- ABUTMENT DETAILS

STANDARDS ARE INCLUDED IN PLANS AFTER SHEET NO. 9  
000001-05 STANDARD SYMBOLS, ABBREVIATIONS AND PATTERNS  
515001-02 NAME PLATE FOR BRIDGES  
635006-02 REFLECTOR AND TERMINAL MARKER PLACEMENT  
701901 TRAFFIC CONTROL DEVICES  
BLR 21-7 TYPICAL APPLICATION OF TRAFFIC CONTROL DEVICES FOR CONSTRUCTION ON RURAL LOCAL HIGHWAYS

SOIL BORINGS (SEE SPECIFICATIONS)

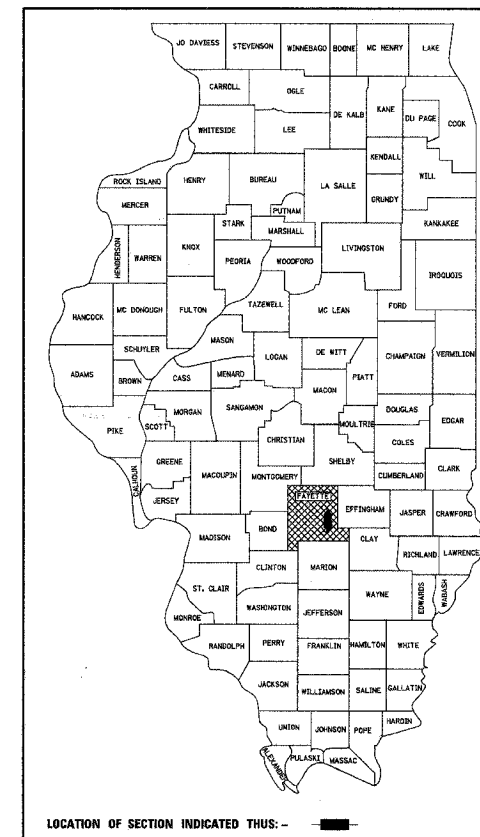

FAYETTE COUNTY HIGHWAY DEPARTMENT	
APPROVED	11-2, 2007 <i>Michael A. Witz</i> FAYETTE COUNTY, COUNTY ENGINEER
PASSED	11-7, 2007 <i>Manuel E. Kautl</i> DISTRICT SEVEN ENGINEER OF LOCAL ROADS & STREETS
RELEASING FOR BID BASED ON LIMITED REVIEW	11-7, 2007 <i>Christie M. Reed</i> DEPUTY DIRECTOR OF HIGHWAYS, REGION FOUR ENGINEER

DESIGN CLASSIFICATION: RURAL LOCAL ROAD  
ADT<sub>2007</sub> : 150  
ADT<sub>2027</sub> : 200  
DESIGN SPEED - 30 MPH

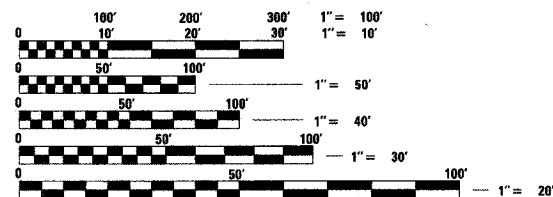

FULL SIZE PLANS HAVE BEEN PREPARED USING STANDARD ENGINEERING SCALES, REDUCED SIZED PLANS WILL NOT CONFORM TO STANDARD SCALES, IN MAKING MEASUREMENTS ON REDUCED PLANS, THE ABOVE SCALES MAY BE USED.

J.U.L.I.E.  
JOINT UTILITY LOCATING INFORMATION FOR EXCAVATORS  
1-800-892-0123 Website: <http://www.illinois1call.com>

CONTRACT NO. 95532

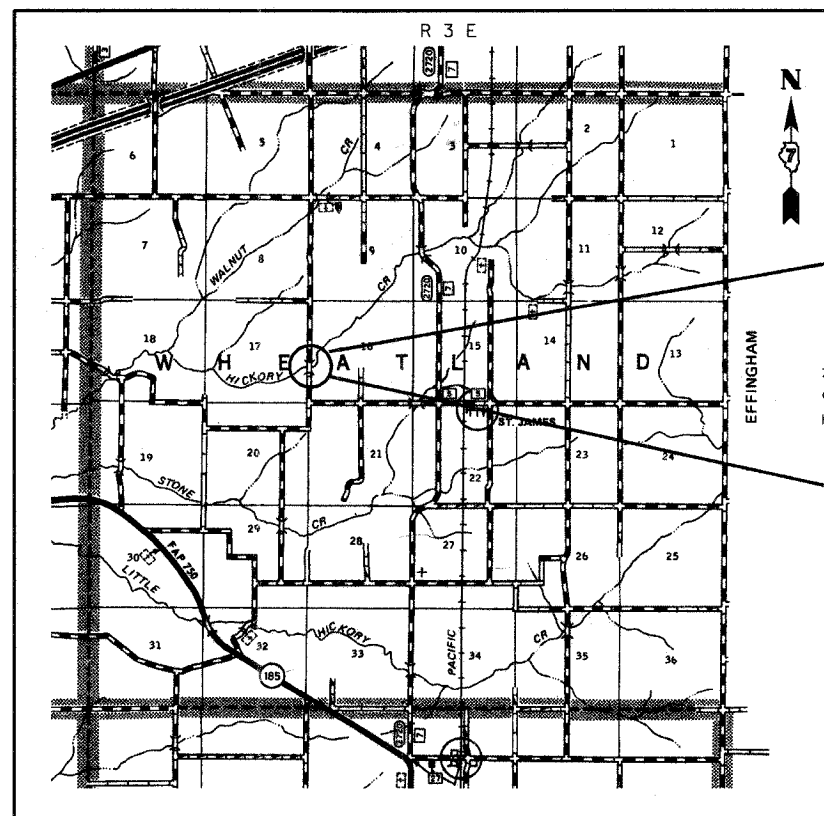

SECTION BEGINS  
STA. 8+57.36

SECTION 06-19125-00-BR

INCLUDES THE CONSTRUCTION OF A SINGLE SPAN PRECAST PRESTRESSED CONCRETE DECK BEAM BRIDGE CARRYING TR 454 OVER HICKORY CREEK, 82'-6" BK TO BK ABUTMENTS, NO SKEW, EXISTING STRUCTURE NO. 026-3308 PROPOSED STRUCTURE NO. 026-3437

SECTION ENDS  
STA. 12+71.25

LOCATION: NEAR THE NE CORNER, SE 1/4, SECTION 17, T6N, R3E, 3RD P.M.  
NET LENGTH OF PROJECT: 413.89 FT = 0.078 MI



*Gary L. Hahn* 10-31-07  
GARY L. HAHN  
CENTRALIA, ILLINOIS  
ILLINOIS LICENSED PROFESSIONAL  
ENGINEER NO. 62-42606  
EXPIRES NOV. 30, 2009