

B.M. - Rt. Sta. 5+80, spike in power pole, elev. 494.44.

Existing Structure - Structure 040-3015 consists of single span Precast Channel Beams on closed timber abutments. The bk. to bk. of abutments length is 26' and the out-to-out width is 22.7'. The existing structure shall be completely replaced. Road closure shall be used during construction.

Salvage - Any material deemed salvageable by the Engineer shall be stockpiled on the R.O.W. and shall become the property of Jasper County. The Contractor shall dispose of all remaining material.

ROUTE NO.	SECTION	COUNTY	SHEET NO.	SHEET	SHEET NO.
F.A.S. 1705	08-00110-00-BR	JASPER	15	5	7 SHEETS
FED. ROAD DIST. NO. 7	ILLINOIS	FED. AID PROJECT			

Contract # 95559

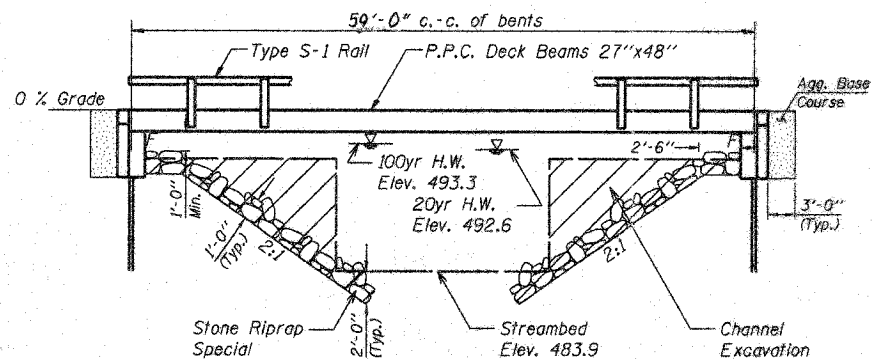

ELEVATION

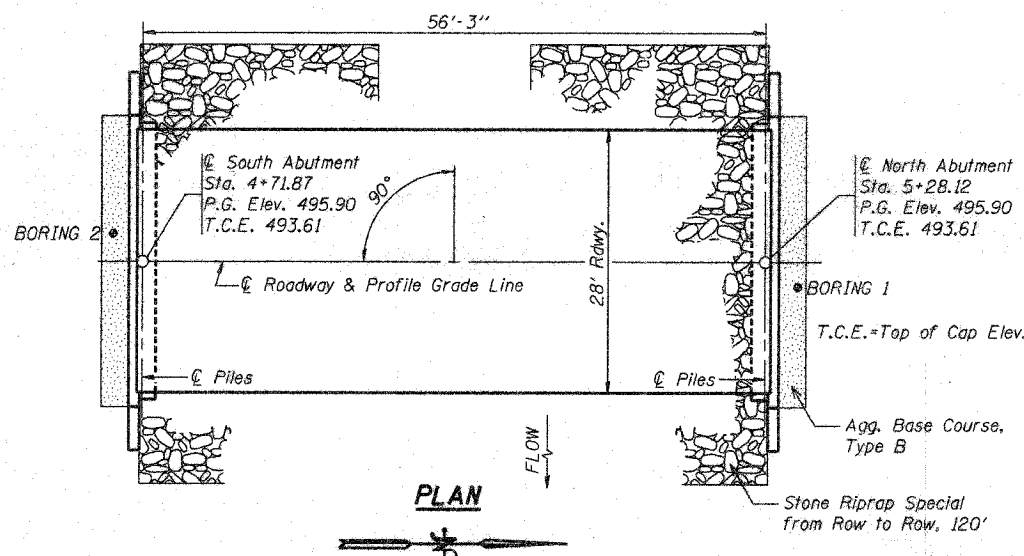

PLAN

GENERAL NOTES

- The Contractor shall drive 1 test pile, as specified, in a permanent location as directed by the Engineer before ordering the remaining piles.
- See Bridge Plan Sheet 7 for boring logs.
- A Corrosion inhibitor, as covered in the Special Provisions, shall be used in the concrete for precast prestressed concrete deck beams.
- Concrete sealer shall be applied to exterior face of each fascia beam. Reinforcement bars shall conform to the requirements of AASHTO M31 or M322 Grade 60.
- The Steel H-piles shall be according to AASHTO M270 grade 50.
- The test pile(s) shall be driven to 110 percent of the Nominal Required Bearing indicated in the pile data information.
- Reinforcement bars shall conform to the requirements of ASTM A 706 Fr 60 (IL Modified). See Special Provisions.
- Reinforcement bars designated (E) shall be epoxy coated.
- Layout of the slope protection system may be varied to suit ground conditions in the field as directed by the Engineer.

TOTAL BILL OF MATERIAL

Item	Unit	Super	Sub.		Total
			Piers	Abuts.	
Removal of Existing Structures	Each	-	-	-	1
Concrete Structures	Cu. Yd.	-	-	20.8	20.8
Precast Prestressed Concrete Deck Beams (27" Depth)	Sq. Ft.	1680	-	-	1680
Steel Bridge Railing, Type S-1	Foot	120	-	-	120
Reinforcement Bars, Epoxy Coated	Pound	-	-	2580	2580
Furnishing Steel Piles HP 10x42	Foot	-	-	295	295
Driving Piles	Foot	-	-	295	295
Test Piles Steel HP 10x42	Each	-	-	1	1
Name Plates	Each	1	-	-	1
Concrete Encasement	Cu. Yd.	-	-	3.5	3.5
Structure Excavation	Cu. Yd.	-	-	80.9	80.9
Stone Riprap Class A4 (Special)	Ton	-	-	411	411
Aggregate Base Course, Type B	Ton	-	-	60	60
Channel Excavation	Cu. Yd.	-	-	250	250

INDEX OF SHEETS

- General Plan & Elevation
- Superstructure
- Superstructure Details
- Steel Railing
- Abutment Details
- Pile Details
- Boring Logs



Daniel Feuerborn
Licensed Structural Engineer
State of Illinois No. 81-5933
License Expires 11-30-2008

Date

ESI CONSULTANTS, LTD
753 WINDSOR ROAD
CHARLESTON, IL 61820
(317) 548-1880
WWW.ESICONSULTANTS.LTD.COM
ILLINOIS DEPARTMENT OF PROFESSIONAL REGULATION REGISTRATION #184-003680

GENERAL PLAN & ELEVATION

F.A.S. 1705
OVER TURKEY CREEK
SECTION 08-00110-00-BR
JASPER COUNTY
STATION 5+00

STA 4+50 ELEV 495.90	0% Grade	STA 5+00 ELEV 495.90	STA 5+50 ELEV 495.90
-------------------------	----------	-------------------------	-------------------------

PROFILE GRADE

DESIGN STRESSES

FIELD UNITS

f'c = 3,500 psi
Fy = 60,000 psi (reinforcement)

PRECAST PRESTRESSED UNITS

f'c = 6,000 psi
f'ci = 5,000 psi
F's = 270,000 psi (1/2" low relax. strands)
Fsi = 201,960 psi (1/2" low relax. strands)

DESIGN SPECIFICATIONS

2007 AASHTO LRFD Bridge
Design Specifications - 4th ed.

LOADING HL-93

Allow 25#/sq. ft. for future
wearing surface.

SEISMIC DATA

Seismic Performance Zone (SPZ) = 1
Bedrock Acceleration Coefficient (A) = 0.075g
Site Coefficient (S) = 1.0

PILE DATA (2-ABUTS.)

Type	STEEL HP 10x42
Nominal Required Bearing	335 kips
Factored Resistance Available	167 kips
Estimated Pile Length	35 Feet North Abut. and 30 Feet South Abut.
Number of Production Piles	9
Number of Test Piles	1 (In South Abutment)

TURKEY CREEK
BUILT 200... BY
JASPER COUNTY
SEC. 08-00110-00-BR
PROJECT NO. BRS-1705(102)
F.A.S. 1705 STA. 5+00
STR. NO. 040-3258 LOADING HL-93

LETTERING FOR NAME PLATE

Locate Name Plate at Corner
of Bridge (See Std. 515001)

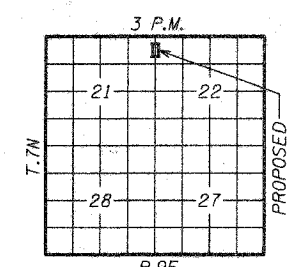

LOCATION SKETCH

WATERWAY INFORMATION

Drainage Area = 5.5 SQ MI		Low Grade Elev. = 495.9 @ Sta. 5+00							
Flood	Freq. Yr.	Q C.F.S.	Opening Sq. Ft.		Nat. Head - Ft.		Headwater El.		
			Exist.	Prop.	H.W.E. Exist.	Prop.	Exist.	Prop.	
Design	20	1965	148	340	492.6	0.1	0.1	492.7	492.7
Base	100	3060	166	380	493.3	2.2	0.7	495.5	494.0
Overlapping									
Max. Calc.	500								