

Copyright © 2014 by BAXTER & WOODMAN, INC.
 STATE OF ILLINOIS - PROFESSIONAL DESIGN FIRM
 LICENSE NO. - 184-00121 - EXPIRES 4/30/2015
 5/22/2014 3:27:59 PM
 ...\\pilot\100153-WO-17-Plan16.sht
 ...\\pilot\100153-WO-17-PEN.tbl
 I:\CrystalLakes\IDOT\100153-WO-Design\WO-17 11 38 Rt to Rt 31\CADD-SURVEY\DRAWINGS\DCNS\100153-WO-17-Plan16.sht

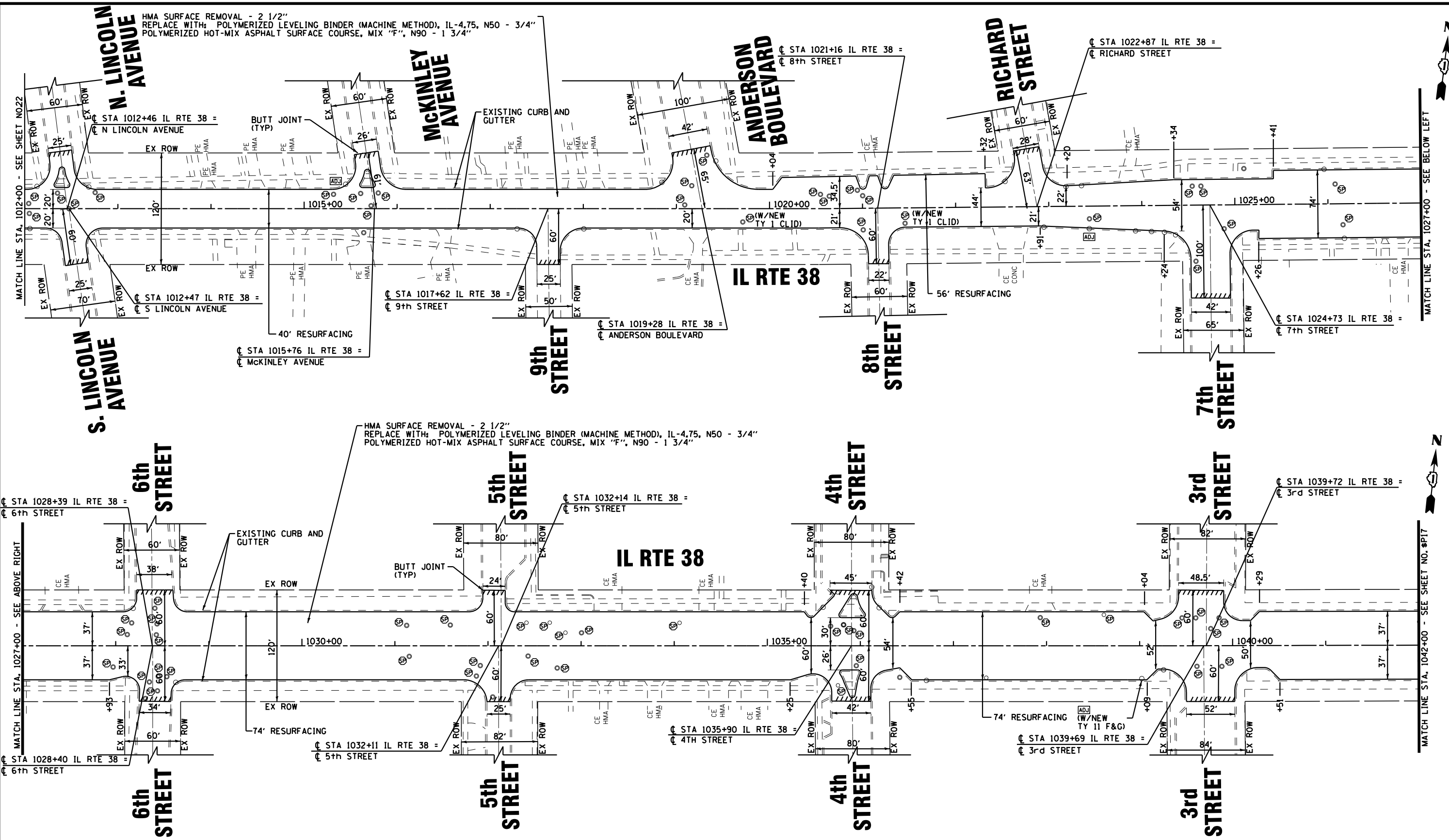

NOTES:
 1. ALL PAVEMENT PATCHING LOCATIONS WILL BE DETERMINED BY THE RESIDENT ENGINEER.

BAXTER & WOODMAN
 Consulting Engineers

DESIGNED - TLH	REVISED - 7-20-11 IDOT REVIEW
DRAWN - UKB	REVISED - 10-22-12 IDOT REVIEW
CHECKED - RWL	REVISED - 5-12-14 UPDATE
DATE - 12-17-10	FILE - 100153-WO-17-Plan16.sht

**STATE OF ILLINOIS
 DEPARTMENT OF TRANSPORTATION**

**IL ROUTE 38
 IL ROUTE 47 TO IL ROUTE 31
 ROADWAY PLAN**

SCALE: 1"=50'

STA. 1012+00 TO STA. 1042+00

F.A.P. RTE.	SECTION	COUNTY	TOTAL SHEETS	SHEET NO.
347	4R-R5-8	KANE	65	23
C-91-308-11		CONTRACT NO. 60N38		
FED. ROAD DIST. NO. 1 ILLINOIS FED AID PROJECT				