

COPYRIGHT © 2014 BY BAXTER & WOODMAN, INC.
 STATE OF ILLINOIS - PROFESSIONAL DESIGN FIRM
 LICENSE NO. - 184-00121 - EXPIRES 4/30/2015
 5/22/2014 3:28:00 PM
 I:\CrysalLakes\DOT\100153\40-Design\WO-17 11 38 Rt + 47 to Rt 31\CADD-SURVEY\DRAWINGS\DCNS\100153-WO-17-PM15.sht

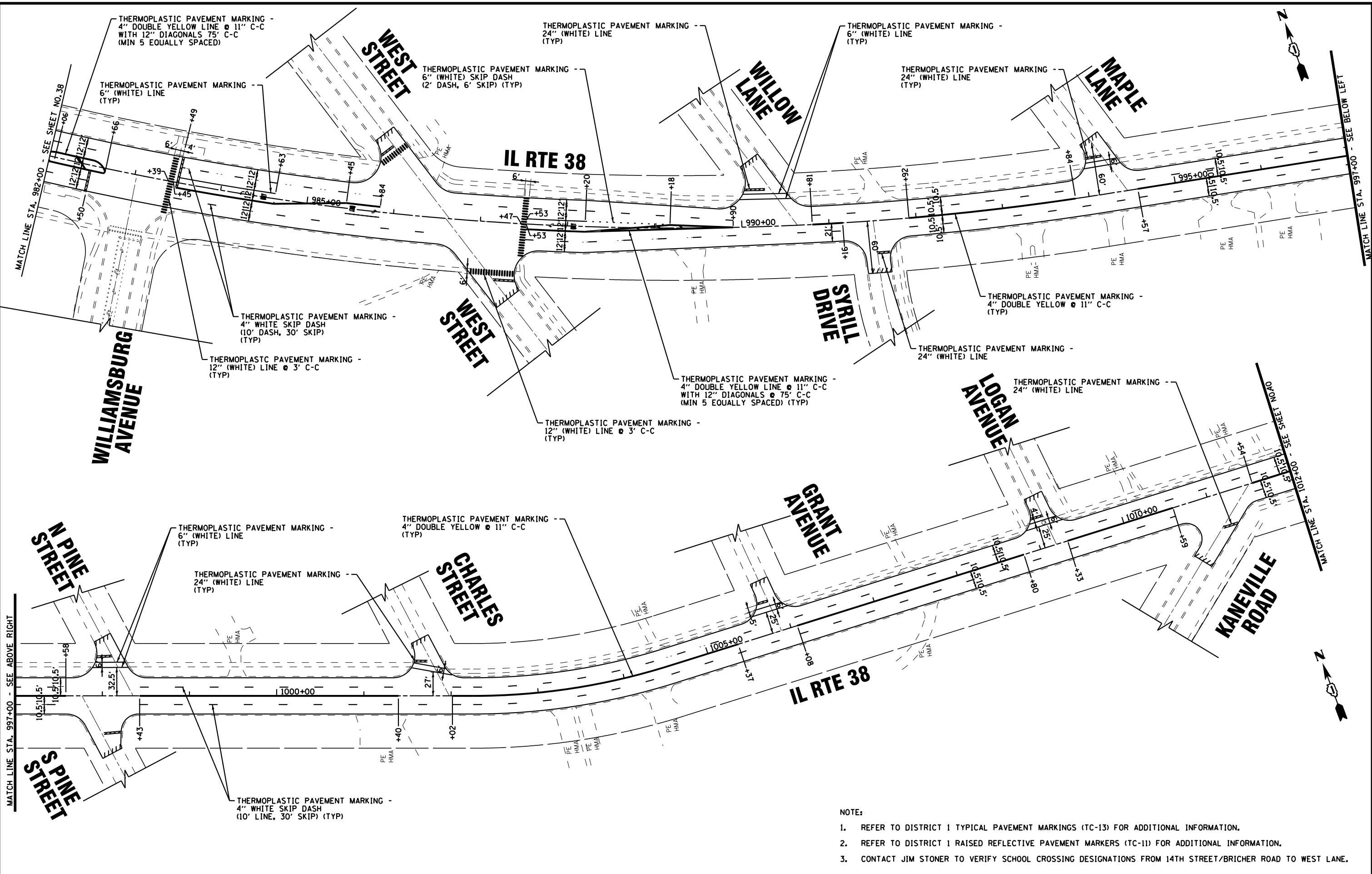

- NOTE:
- REFER TO DISTRICT 1 TYPICAL PAVEMENT MARKINGS (TC-13) FOR ADDITIONAL INFORMATION.
 - REFER TO DISTRICT 1 RAISED REFLECTIVE PAVEMENT MARKERS (TC-11) FOR ADDITIONAL INFORMATION.
 - CONTACT JIM STONER TO VERIFY SCHOOL CROSSING DESIGNATIONS FROM 14TH STREET/BRICHER ROAD TO WEST LANE.

DESIGNED - TLH	REVISED - 7-20-11 IDOT REVIEW
DRAWN - UKB	REVISED - 10-22-12 IDOT REVIEW
CHECKED - RWL	REVISED - 5-12-14 UPDATE
DATE - 12-17-10	FILE - 100153-WO-17-PM15.sht

STATE OF ILLINOIS
 DEPARTMENT OF TRANSPORTATION

IL ROUTE 38
 IL ROUTE 47 TO IL ROUTE 31
 PAVEMENT MARKING PLAN

F.A.P. RTE.	SECTION	COUNTY	TOTAL SHEETS	SHEET NO.
347	4R-RS-8	KANE	65	39
C-91-308-11		CONTRACT NO. 60N38		
FED. ROAD DIST. NO. 1 ILLINOIS FED AID PROJECT				

SCALE: 1"=50'
 STA. 982+00 TO STA. 1012+00