

WORK SHALL MEET THE REQUIREMENTS OF THE SPECIAL PROVISION, "TRAFFIC SIGNAL SPECIFICATIONS FOR DETECTOR LOOP REPLACEMENT AND/OR INSTALLATION ON ROADWAY GRINDING, RESURFACING AND PATCHING OPERATIONS". SPECIAL ATTENTION MUST BE MADE TO THE SECTIONS "INSPECTION OF CONSTRUCTION" AND "DETECTOR LOOP REPLACEMENT" FOR INSTALLATION AND INSPECTION REQUIREMENTS. LOOP REPLACEMENT WORK THAT DOES NOT MEET THE CONTRACT REQUIREMENTS SHALL NOT BE PAID. WORK NECESSARY TO COMPLETE THE LOOP REPLACEMENT WORK MAY BE ASSIGNED BY THE ENGINEER TO IDOT'S ELECTRICAL MAINTENANCE CONTRACTOR (EMC); ALL RELATED COSTS WILL BE THE RESPONSIBILITY OF THE CONTRACTOR.

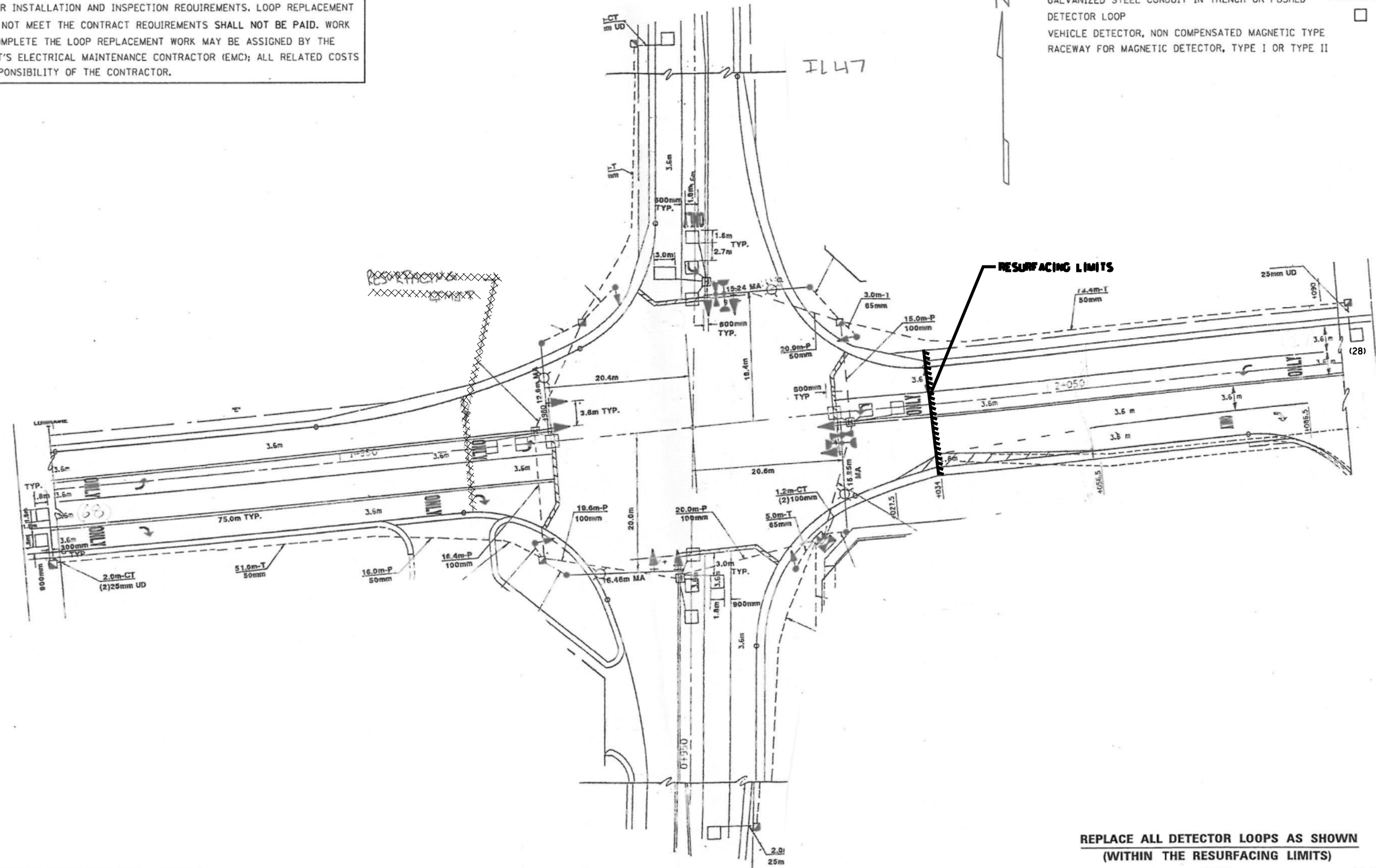
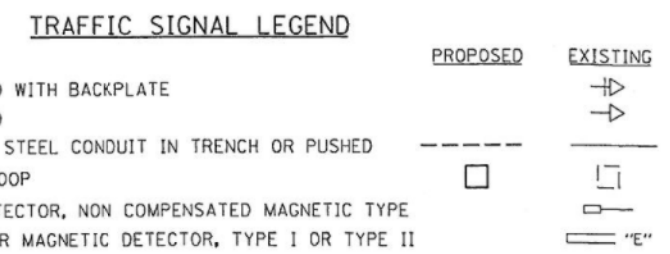

**THIS PLAN IS FOR THE SOLE PURPOSE OF  
DETECTOR LOOP REPLACEMENTS ONLY**

**REPLACE ALL DETECTOR LOOPS AS SHOWN  
(WITHIN THE RESURFACING LIMITS)**

CODE	QUANTITY	UNIT	ITEM
88600600	28	FOOT	DETECTOR LOOP, REPLACEMENT

COPYRIGHT © 2014 BY BAXTER & WOODMAN, INC.  
 STATE OF ILLINOIS - PROFESSIONAL DESIGN FIRM  
 LICENSE NO. - 184-00121 - EXPIRES 4/30/2015  
 263mcc 5/22/2014 3:28:42 PM  
 \\corpbboxwood.com\projects\CrystalLake\100153-40-Design\WO-17-DET2.sht  
 ..\plots\100153-WO-17-PEN.tbl  
 ..\plots\100153-WO-17-PEN.tbl  
 ..\plots\100153-WO-17-PEN.tbl

DESIGNED - TLH	REVISED - 7-20-11 IDOT REVIEW
DRAWN - UKB	REVISED - 10-22-12 IDOT REVIEW
CHECKED - RWL	REVISED -
DATE - 12-17-10	FILE - 100153-WO-17-DET2.sht

STATE OF ILLINOIS  
DEPARTMENT OF TRANSPORTATION

**IL ROUTE 38  
IL ROUTE 47 TO IL ROUTE 31  
IL 38 @ IL 47**

SCALE: STA. TO STA.

F.A.P. RTE.	SECTION	COUNTY	TOTAL SHEETS	SHEET NO.
347	4R-RS-8	KANE	65	42
C-91-308-11			CONTRACT NO. 60N38	
FED. ROAD DIST. NO. 1 ILLINOIS FED AID PROJECT				