

M.O.T. TYPICAL SECTION – STAGE 1

IL ROUTE 72

STA. 59+60 TO STA. 70+00
(LOOKING EAST)

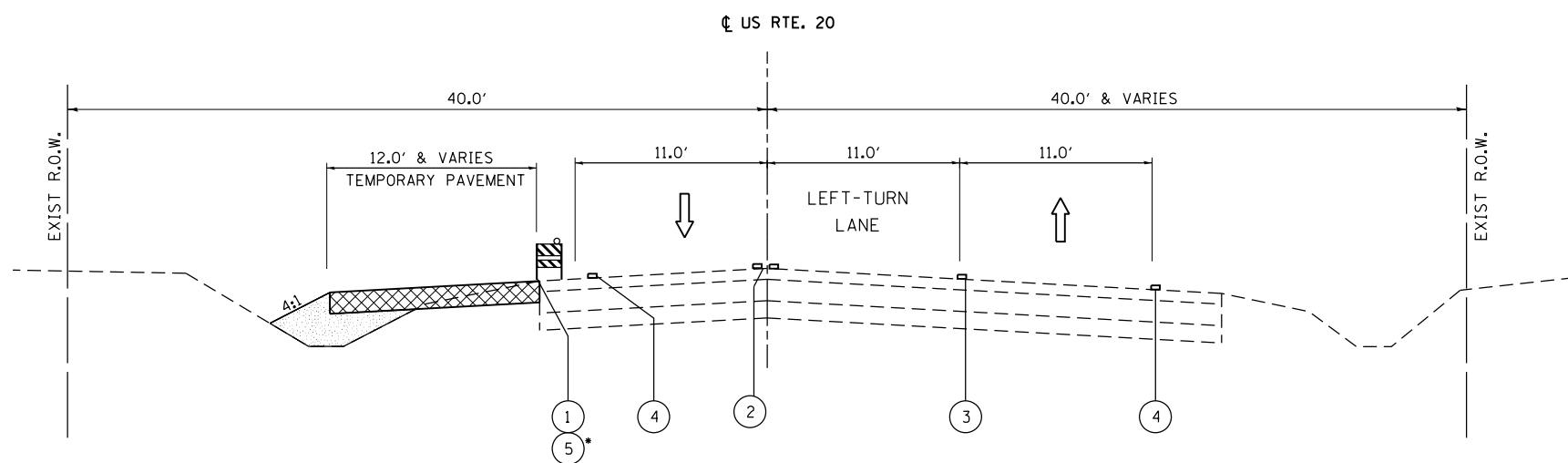

M.O.T. TYPICAL SECTION – STAGE 1

U.S. ROUTE 20

STA. 70+00 TO STA. 81+00
(LOOKING WEST)

* TEMPORARY CONCRETE BARRIER LOCATED
BETWEEN STA. 74+00 TO 76+00

LEGEND

- ① TYPE II BARRICADE, DRUM OR VERTICAL BARRICADE
- ② EXISTING 4" DOUBLE SOLID YELLOW (11" C-C)
- ③ TEMPORARY PAVEMENT MARKING - LINE 6" (WHITE)
- ④ TEMPORARY PAVEMENT MARKING - LINE 4" (WHITE)
- ⑤ TEMPORARY CONCRETE BARRIER
- ← DIRECTION OF TRAFFIC
- ▨ WORK ZONE

NOTES

1. PRIOR TO INSTALLING POST MOUNTED SIGNS, THE CONTRACTOR SHALL CONTACT J.U.L.I.E.
2. SEE STAGING PLAN AND STANDARD 701422 FOR ADDITIONAL INFORMATION.

FILE NAME =	USER NAME = chr1sf1sh	DESIGNED - MTM	REVISED -	STATE OF ILLINOIS DEPARTMENT OF TRANSPORTATION	SUGGESTED MAINTENANCE OF TRAFFIC STAGE 1 TYPICAL SECTION – SOUTH JUNCTION	F.A.P. RTE.	SECTION	COUNTY	TOTAL SHEETS	SHEET NO.	
Default	PLOT SCALE = 10.0000' / in.	DRAWN - MTM	REVISED -			345	106-S-N-2	KANE	147	32	
	PLOT DATE = 4/1/2014	CHECKED - BA	REVISED -			CONTRACT NO. 60T09					
		DATE - 3/31/14	REVISED -			SCALE: N.T.S.	SHEET 1 OF 7 SHEETS	STA.	TO STA.	ILLINOIS FED. AID PROJECT	