

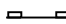





LEGEND:

-  PERIMETER EROSION BARRIER (SILT FENCE, SEE STD. 280001)
-  TEMPORARY DITCH CHECK
-  INLET FILTER
-  STONE RIPRAP, CLASS A1
-  TEMPORARY EROSION CONTROL BLANKET
-  TEMPORARY SEDIMENT BASIN SIZE: 10'x5'x3'

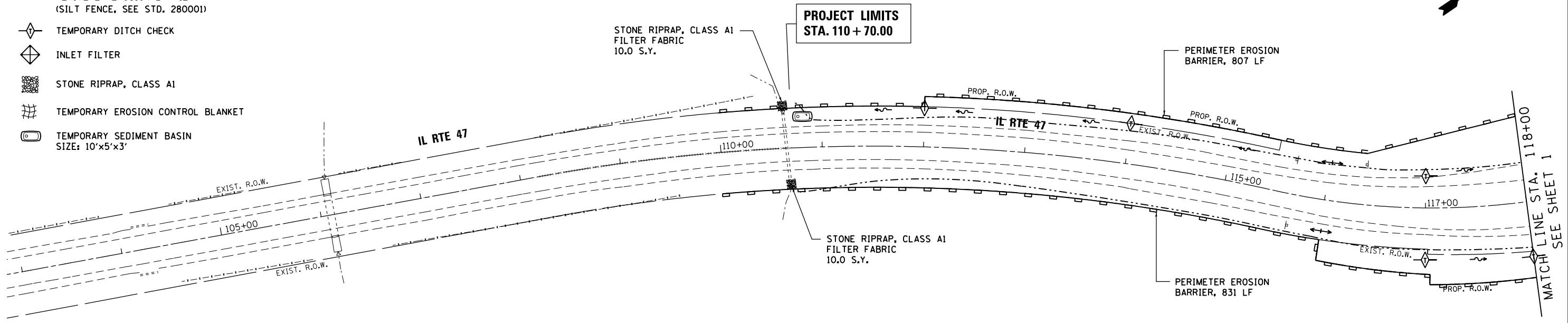

NOTES:

1. INSTALL INLET FILTERS ON ALL OPEN STRUCTURES AND ALL FLARED END SECTIONS.
2. TEMPORARY EROSION CONTROL BLANKET SHALL BE PLACED IN ACCORDANCE WITH THE REQUIREMENTS OF THE STANDARD SPECIFICATIONS ON AREAS WITH SLOPES 1:3 OR STEEPER.

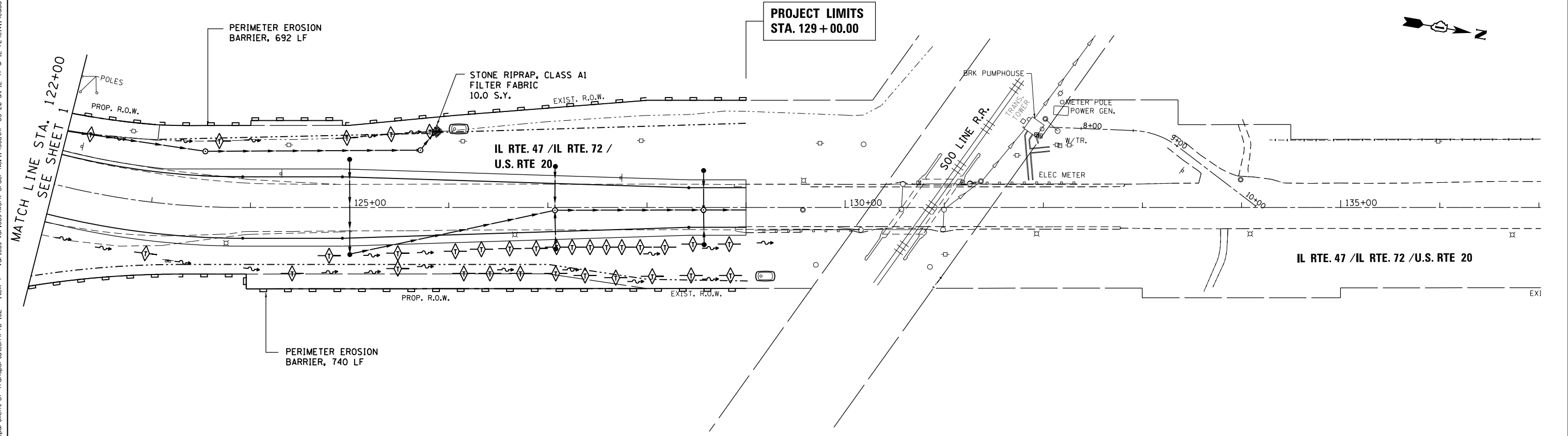

FILE NAME =	USER NAME = chr15fish	DESIGNED - MTM	REVISED -
Default		DRAWN - MTM	REVISED -
	PLOT SCALE = 100.0000' / 1" =	CHECKED - BA	REVISED -
	PLOT DATE = 4/1/2014	DATE - 3/31/14	REVISED -

**STATE OF ILLINOIS
DEPARTMENT OF TRANSPORTATION**

**TEMPORARY EROSION & SEDIMENTATION CONTROL DETAILS - STAGE I
U.S. RTE 20 (SOUTH JUNCTION)**

SCALE: 1"=50' SHEET 3 OF 5 SHEETS STA. 110+70 TO STA. 129+00

F.A.P. RTE.	SECTION	COUNTY	TOTAL SHEETS	SHEET NO.
345	106-S-N-2	KANE	147	46
CONTRACT NO. 60T09				
ILLINOIS FED. AID PROJECT				

G:\Projects\ILLINOIS Department of Transportation\PIB 162 - Item 7 - Various Various Work Order No. 11 (South) - US 20 at IL 47 & IL-72\Civil\Cadd Sheets\160109-sht-erosion- stage 1.dgn