

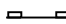



LEGEND:

-  PERIMETER EROSION BARRIER (SILT FENCE, SEE STD. 280001)
-  TEMPORARY DITCH CHECK
-  INLET FILTER
-  STONE RIPRAP, CLASS A1
-  TEMPORARY EROSION CONTROL BLANKET
-  TEMPORARY SEDIMENT BASIN SIZE: 10'x5'x3'

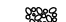

NOTES:

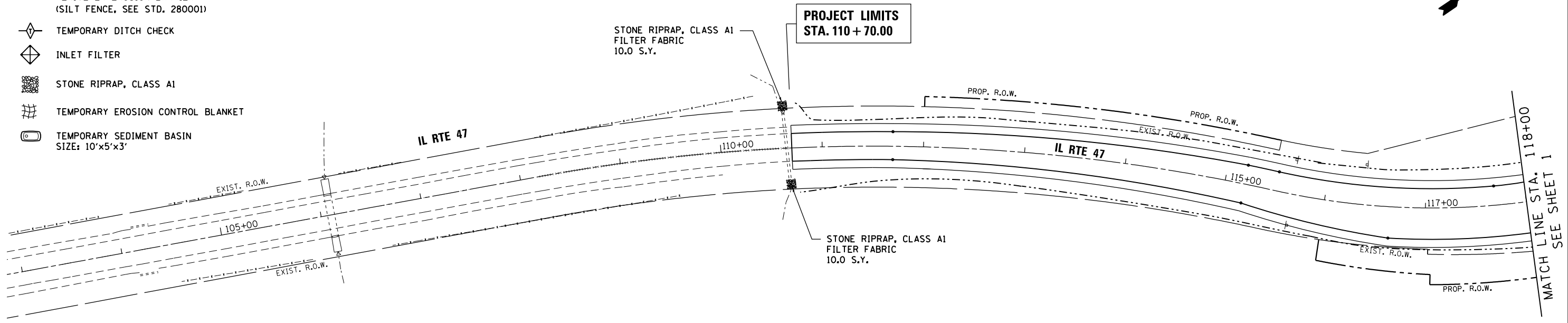
1. INSTALL INLET FILTERS ON ALL OPEN STRUCTURES AND ALL FLARED END SECTIONS.
2. TEMPORARY EROSION CONTROL BLANKET SHALL BE PLACED IN ACCORDANCE WITH THE REQUIREMENTS OF THE STANDARD SPECIFICATIONS ON AREAS WITH SLOPES 1:3 OR STEEPER.

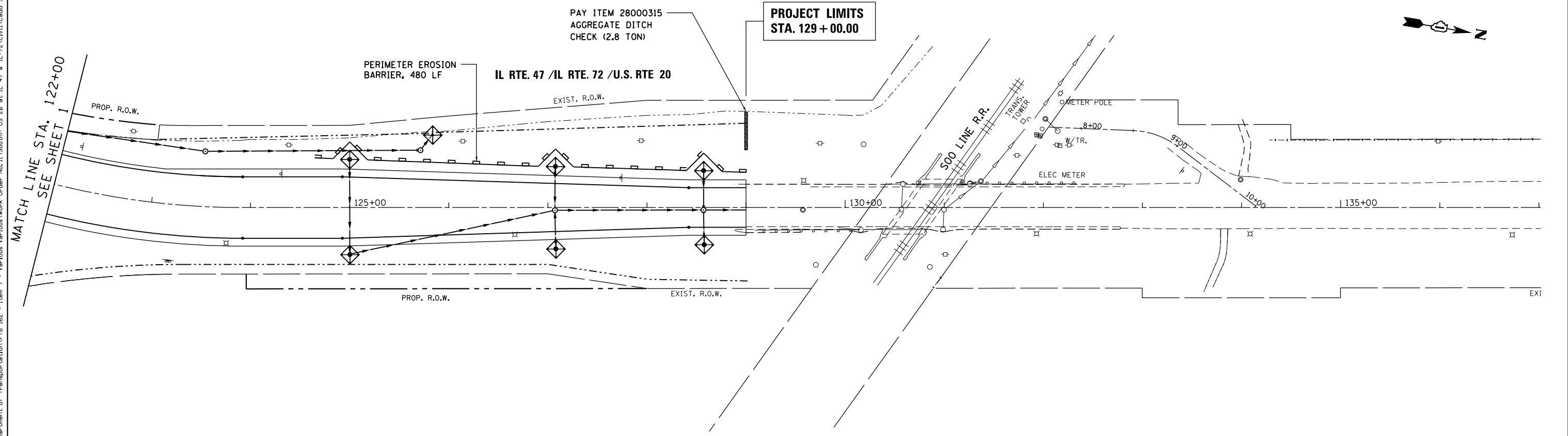

G:\Projects\ILLINOIS Department of Transportation\VTB 162 - Item 7 - Various Various Work Order No. 11 (South) US 20 at IL 47 & IL 72\Civil\Cadd Sheets\0160709-shr-erosion-stage II.cad

FILE NAME =	USER NAME = chr1sf1sh	DESIGNED - MTM	REVISED -
		DRAWN - MTM	REVISED -
	PLOT SCALE = 100.0000' / 1" =	CHECKED - BA	REVISED -
	PLOT DATE = 4/1/2014	DATE - 3/31/14	REVISED -

**STATE OF ILLINOIS
DEPARTMENT OF TRANSPORTATION**

**TEMPORARY EROSION & SEDIMENTATION CONTROL DETAILS - STAGE II
U.S. RTE 20 (SOUTH JUNCTION)**

SCALE: 1"=50' SHEET 5 OF 5 SHEETS STA. 110+70 TO STA. 129+00

F.A.P. RTE.	SECTION	COUNTY	TOTAL SHEETS	SHEET NO.
345	106-S-N-2	KANE	147	48
CONTRACT NO. 60T09				
ILLINOIS FED. AID PROJECT				