



NOTE
 THE VIDEO DETECTION ZONES SHOWN ON THE PLANS
 ARE FOR PRE-CONSTRUCTION STAGE AND SHALL BE
 REDEFINED FOR EACH CONSTRUCTION STAGE AS
 PART OF "TEMPORARY TRAFFIC SIGNAL INSTALLATION".

NOTE 1: THE SPLIT PHASE CONDITION FOR EASTBOUND AND WESTBOUND IL. 72 & US 20 WILL REMAIN UNTIL THE ROADWAY CONSTRUCTION IS COMPLETE AND THE PROPOSED LEFT TURN LANE IS OPEN FOR TRAFFIC.
 NOTE 2: USE 5-SECTION SIGNAL HEADS FOR EASTBOUND AND WESTBOUND DIRECTION WHEN THE ROADWAY CONSTRUCTION IS COMPLETE AND THE LEFT TURN LANE PERMANENTLY OPENED TO TRAFFIC AND PRIOR TO COMPLETION OF THE NEW PERMANENT TRAFFIC SIGNAL INSTALLATION.
 NOTE 3: ALL TEMPORARY AND PERMANENT INTERCONNECT WORK CONNECTIONS WILL BE PERFORMED UNDER CONTRACT 60T09. ALL ASSOCIATED COSTS WILL BE PAID FOR UNDER CONTRACT 60T09.

US ROUTE 20
 ILLINOIS ROUTE 47
 ILLINOIS ROUTE 72

THE TRAFFIC SIGNAL CONTROL EQUIPMENT FOR THIS PROJECT SHALL BE "ECONOLITE" TO MATCH THE EXISTING ADJACENT SYSTEM.

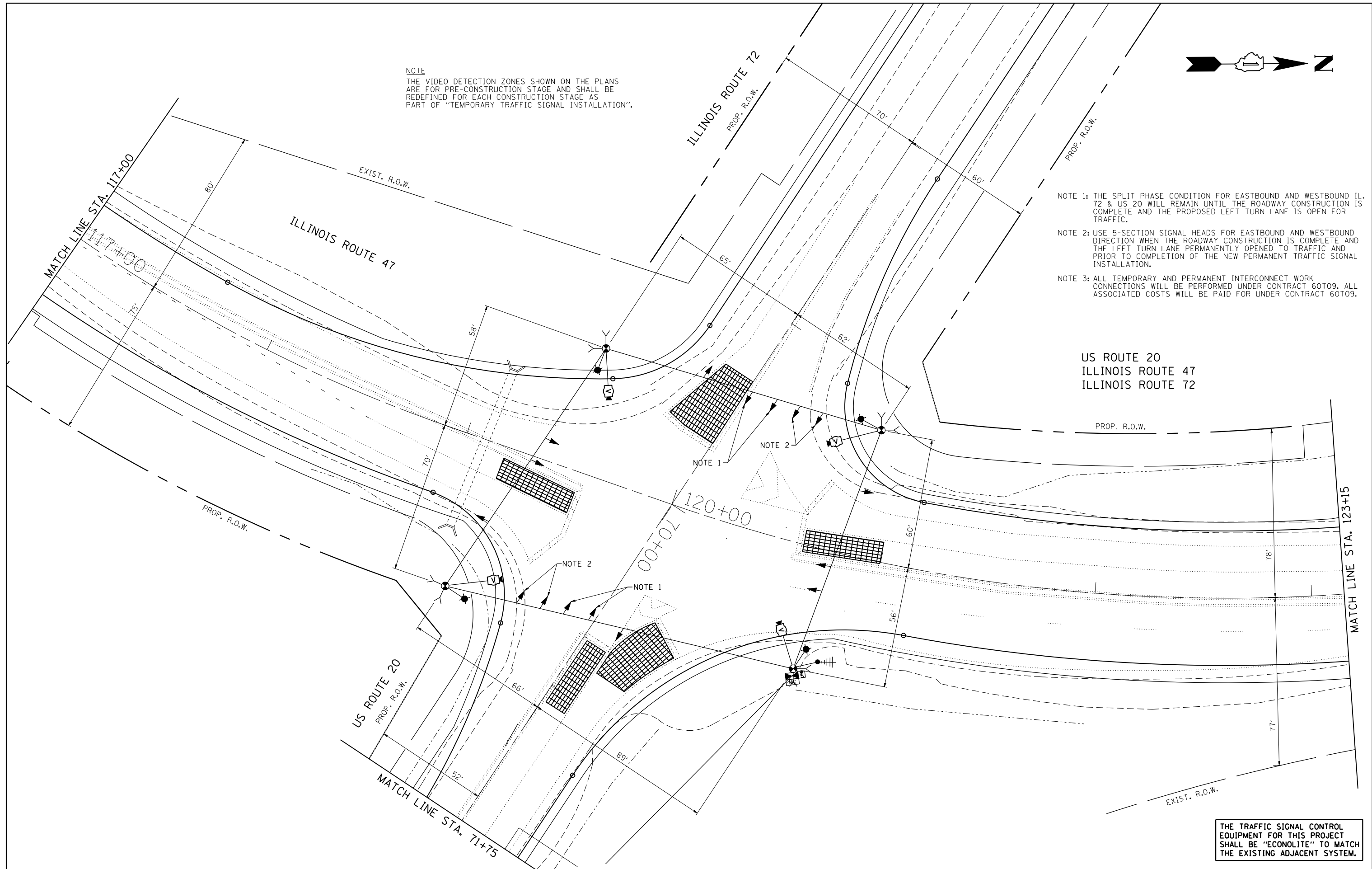

FILE NAME =	USER NAME = Esse	DESIGNED - PKG	REVISED - 4/21/2014, EA
k:\projects\projects 2013\us 20 at il 47	il 72\signals\60t09 (south)\15.US 20 at IL	DRAWN 72 (South Junction).Temp.Int.dgn	REVISED -
	PLOT SCALE = 40.0000' / IN.	CHECKED - PKG	REVISED -
	PLOT DATE = 4/21/2014	DATE - 3/15/2013	REVISED -

**STATE OF ILLINOIS
 DEPARTMENT OF TRANSPORTATION**

TEMPORARY TRAFFIC SIGNAL INSTALLATION PLAN			
ILLINOIS ROUTE 47 AT US ROUTE 20 / ILLINOIS ROUTE 72			
(SOUTH JUNCTION) (SHEET 1 OF 2)			
SCALE: 1"=20'	SHEET NO.	OF SHEETS	STA. TO STA.

F.A.P. RTE.	SECTION	COUNTY	TOTAL SHEETS	SHEET NO.
345	106-S-N-2	KANE	147	76
CONTRACT NO. 60T09				
FED. ROAD DIST. NO. - ILLINOIS FED. AID PROJECT				