

QUANTITY  
 4 (100) LINE = 64.1 ft. (19.7 m)  
 21.1 sq. ft. (1.97 sq. m)

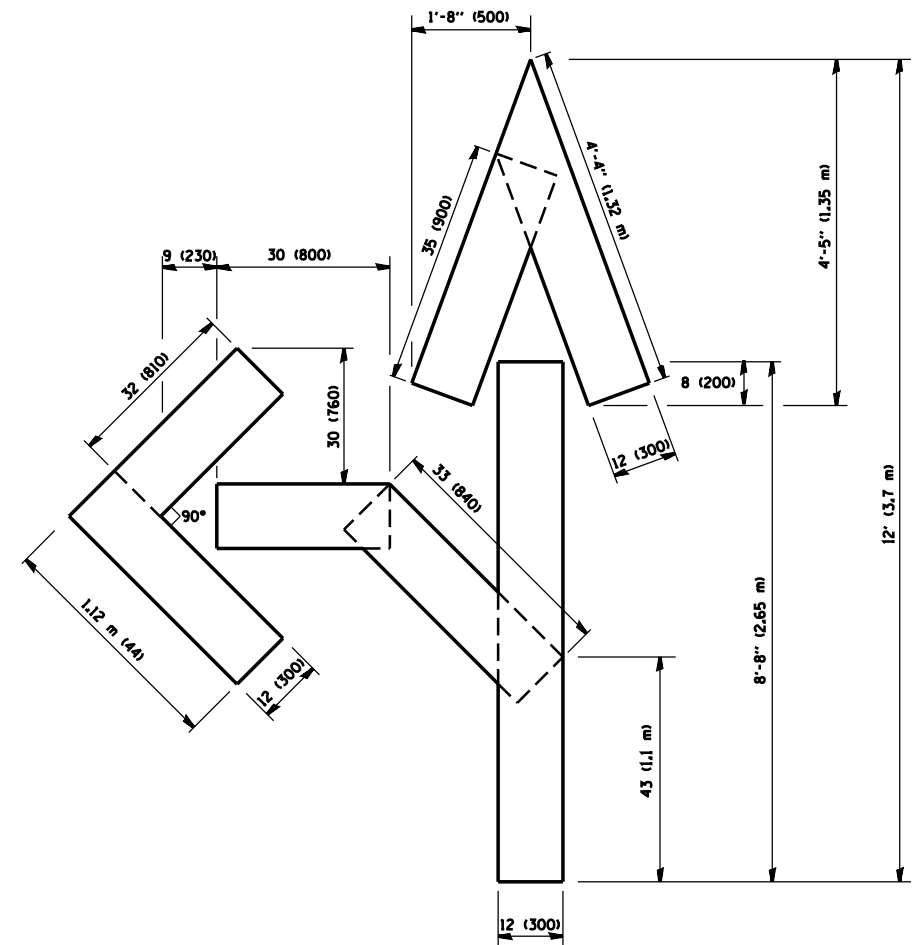

QUANTITY  
 4 (100) LINE = 82.5 ft. (25.3 m)  
 27.5 sq. ft. (2.53 sq. m)

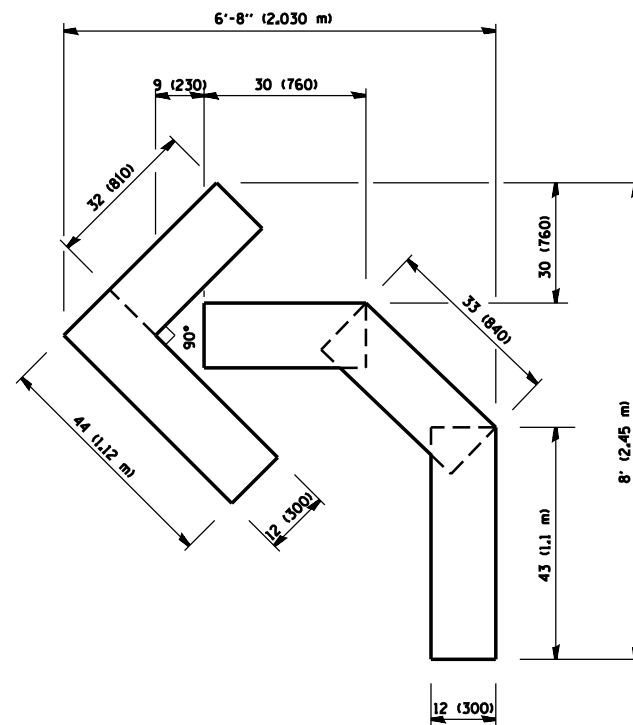

QUANTITY  
 4 (100) LINE = 45.5 ft. (13.9 m)  
 15.2 sq. ft. (1.39 sq. m)

All dimensions are in inches (millimeters) unless otherwise shown.

FILE NAME =	USER NAME = osbornnp	DESIGNED -	REVISED -T, RAMMACHER 06-05-96
et:\pwork\pwork\osbornnp\d0313225\Drawings	tStd.dgn	DRAWN -	REVISED -T, RAMMACHER 11-04-97
	PLOT SCALE = 100.0000' / 1"	CHECKED -	REVISED -T, RAMMACHER 03-02-98
	PLOT DATE = 5/22/2014	DATE - 09-18-94	REVISED -E. GOMEZ 08-28-00

STATE OF ILLINOIS  
 DEPARTMENT OF TRANSPORTATION

PAVEMENT MARKING LETTERS AND SYMBOLS  
 FOR TRAFFIC STAGING

SCALE: NONE SHEET NO. 1 OF 1 SHEETS STA. TO STA.

F.A.P. RTE.	SECTION	COUNTY	TOTAL SHEETS	SHEET NO.
303	(21X,29V&132R5-2	MCHEMRY	34	32
TC-16		CONTRACT NO. 60V12		
FED. ROAD DIST. NO. 1 ILLINOIS FED. AID PROJECT				