

PART OF SECTION 26, TOWNSHIP 44 NORTH, RANGE 7 EAST OF THE THIRD PRINCIPAL MERIDIAN, IN McHENRY COUNTY, ILLINOIS

PARCEL NO.	OWNER	TOTAL HOLDING (ACRES) SQ. FEET	PART TAKEN (ACRES) SQ. FEET	REMAINDER (ACRES) SQ. FEET	PREVIOUS DEDICATION (ACRES) SQ. FEET	EASEMENT (ACRES) SQ. FEET	EASEMENT PURPOSE	TAX NUMBER(S)	ACQUIRED BY
1CV1027	Lord and Savior Evangelical Lutheran Church	(6.409)	(1.074)	(5.335)	(0.773)	N/A	N/A	13-26-200-003 13-26-200-001 13-26-200-004	

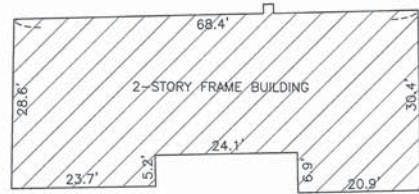

CURVE "KK"
 $\Delta=32^{\circ}08'36''$
 $L=235.64'$
 $R=420.03'$
 $CH=232.56'$
 $CH. BRG.=S73^{\circ}03'02''W$

CURVE "1F"
 $\Delta=11^{\circ}32'22''$
 $L=92.65'$
 $R=480.03'$
 $CH=92.49'$
 $CH. BRG.=N83^{\circ}21'09''E$

PROJECT COORDINATES FOR PROPOSED R.O.W.				
POINT NUMBER	STATION	OFFSET	NORTHING	EASTING
609	STA.=457+88.64	70.00' LEFT	2040844.1145	971547.3143
612	STA.=461+86.43	70.00' LEFT	2040510.5823	971764.0875
613	STA.=461+86.43	65.00' LEFT	2040507.8575	971759.8951
614	STA.=465+39.06	65.00' LEFT	2040212.1849	971952.0621
617	STA.=853+06.44 (2)	40.00' LEFT	2040166.9193	972282.3696
618	STA.=853+91.04 (2)	40.00' LEFT	2040177.6264	972374.2404
619	STA.=856+43.45 (2)	40.00' LEFT	2040181.4935	972626.6196

PROJECT COORDINATES FOR PROPOSED CENTERLINE RIDGEFIELD ROAD NORTH				
POINT NUMBER	STATION	OFFSET	NORTHING	EASTING
123	STA.=850+00.00 (2)	0.00' RIGHT	2039985.1484	972022.0981
350	STA.=851+55.40 (2)	0.00' RIGHT	2040069.8335	972152.3963
351	STA.=853+91.04 (2)	0.00' RIGHT	2040137.6311	972374.8533
352	STA.=856+43.45 (2)	0.00' RIGHT	2040141.4982	972627.2325
352	STA.=407+00.00 (2)	0.00' RIGHT	2040141.4982	972627.2325
353	STA.=410+81.66 (2)	0.00' RIGHT	2040147.3458	973008.8493
355	STA.=856+00.00 (2)	0.00' RIGHT	2040140.8326	972583.7919

(2) PROPOSED RIDGEFIELD ROAD NORTH STATIONING
 (3) EXISTING RIDGEFIELD ROAD NORTH STATIONING

PROJECT COORDINATES FOR PROPOSED CENTERLINE U.S. 14				
POINT NUMBER	STATION	OFFSET	NORTHING	EASTING
122	STA.=459+00.00	0.00' RIGHT	2040712.5988	971549.3051
123	STA.=467+67.59	0.00' RIGHT	2039985.1484	972022.0981
124	STA.=478+00.00	0.00' RIGHT	2039119.5061	972584.7063

LEGEND

- SECTION CORNER
- QUARTER SECTION CORNER
- SECTION LINE
- QUARTER SECTION LINE
- QUARTER, QUARTER SECTION LINE
- PLATTED LOT LINE
- PROPERTY (DEED) LINE
- APPARENT PROPERTY LINE
- CENTERLINE
- EXISTING RIGHT OF WAY LINE
- PROPOSED CENTERLINE
- PROPOSED RIGHT OF WAY LINE
- PROPOSED EASEMENT
- MEASURED DIMENSION
- COMPUTED DIMENSION
- RECORD DATA
- EXISTING BUILDING

120.32'
129.32' (Comp.)

50' 0 50'
SCALE: 1"=50'

- IRON PIPE OR ROD SET OR FOUND
- + CUT CROSS SET OR FOUND
- ⊗ CONCRETE R.O.W. MARKER FOUND
- 3/4" IRON PIPE SET OR FOUND
- ⊙ "MAG" NAIL SET OR FOUND
- 5/8" REBAR SET OR FOUND
- ⊙ "P.K." NAIL SET OR FOUND
- T1 THESE STAKES REFERENCE FOUND OR SET MONUMENTATION. SET 5/8 INCH IRON ROD FLUSH WITH GROUND TO THE FOUND IRON STAKE. IDENTIFIED BY T3 COLORED PLASTIC CAP BEARING SURVEYORS REGISTRATION NUMBER.
- BT1 THESE STAKES, IN CULTIVATED AREAS, REFERENCE FOUND OR SET MONUMENTATION. BURIED 5/8 INCH IRON ROD 20 INCHES BELOW GROUND TO THE FOUND IRON STAKE. IDENTIFIED BY COLORED PLASTIC CAP BEARING SURVEYORS REGISTRATION NUMBER.
- STAKING OF PROPOSED RIGHT OF WAY. SET DIVISION OF HIGHWAYS SURVEY MARKER TO MONUMENT THE POSITION SHOWN. IDENTIFIED BY INSCRIPTION DATA AND SURVEYORS REGISTRATION NUMBER.
- M STAKING OF PROPOSED RIGHT OF WAY IN CULTIVATED AREAS. BURIED 5/8 INCH METAL ROD 20 INCHES BELOW GROUND TO MARK FUTURE SURVEY MARKER POSITION IDENTIFIED BY COLORED PLASTIC CAP BEARING SURVEYORS REGISTRATION NUMBER.
- PERMANENT SURVEY MARKER, I.D.O.T. STD 2135
- RIGHT OF WAY STAKING PROPOSED TO BE SET.



STATE OF ILLINOIS }
 COUNTY OF COOK } SS

THIS IS TO CERTIFY THAT I, RANDELL E. GANN, AN ILLINOIS PROFESSIONAL LAND SURVEYOR, HAVE SURVEYED THE PLAT OF HIGHWAYS SHOWN HEREON IN SECTION 26, TOWNSHIP 44 NORTH, RANGE 7 EAST OF THE THIRD PRINCIPAL MERIDIAN, McHENRY COUNTY, ILLINOIS, THAT THE SURVEY IS TRUE AND COMPLETE AS SHOWN TO THE BEST OF MY KNOWLEDGE AND BELIEF, THAT THE PLAT CORRECTLY REPRESENTS SAID SURVEY, THAT ALL MONUMENTS FOUND AND ESTABLISHED ARE OF PERMANENT QUALITY AND OCCUPY THE POSITIONS SHOWN THEREON AND THAT THE MONUMENTS ARE SUFFICIENT TO ENABLE THE SURVEY TO BE RETRACED. MADE FOR THE DEPARTMENT OF TRANSPORTATION, STATE OF ILLINOIS.

DATED AT SOUTH HOLLAND, ILLINOIS THIS 22ND DAY OF OCTOBER, 2010 A.D.

Randell E. Gann
 ILLINOIS REGISTERED LAND SURVEYOR NO. 035-003241
 EXPIRATION DATE: NOVEMBER 30, 2012

THIS PROFESSIONAL SERVICE CONFORMS TO THE CURRENT ILLINOIS MINIMUM STANDARDS FOR A BOUNDARY SURVEY.

RECEIVED
 APR 05 2012
 PLATS & LEGALS

Robinson ENGINEERING
 17000 SOUTH PARK AVENUE
 SOUTH HOLLAND, IL 60473
 (708) 331-6700

PLAT OF HIGHWAYS
 STATE OF ILLINOIS
 DEPARTMENT OF TRANSPORTATION
 U.S. ROUTE 14
 WEST LAKE SHORE DRIVE TO DOLE AVENUE

SECTION McHENRY COUNTY
 PROJECT JOB NO. R-91-015-98
 STATION STATION 468+90.53
 SCALE: 1"=50' SHEET 47 OF 88

BUREAU OF LAND ACQUISITION
 201 WEST CENTER COURT
 SCHAMBURG, ILLINOIS 60196

DATE	BY	R.O.W. PLAT	NOTEBOOK NO.

