

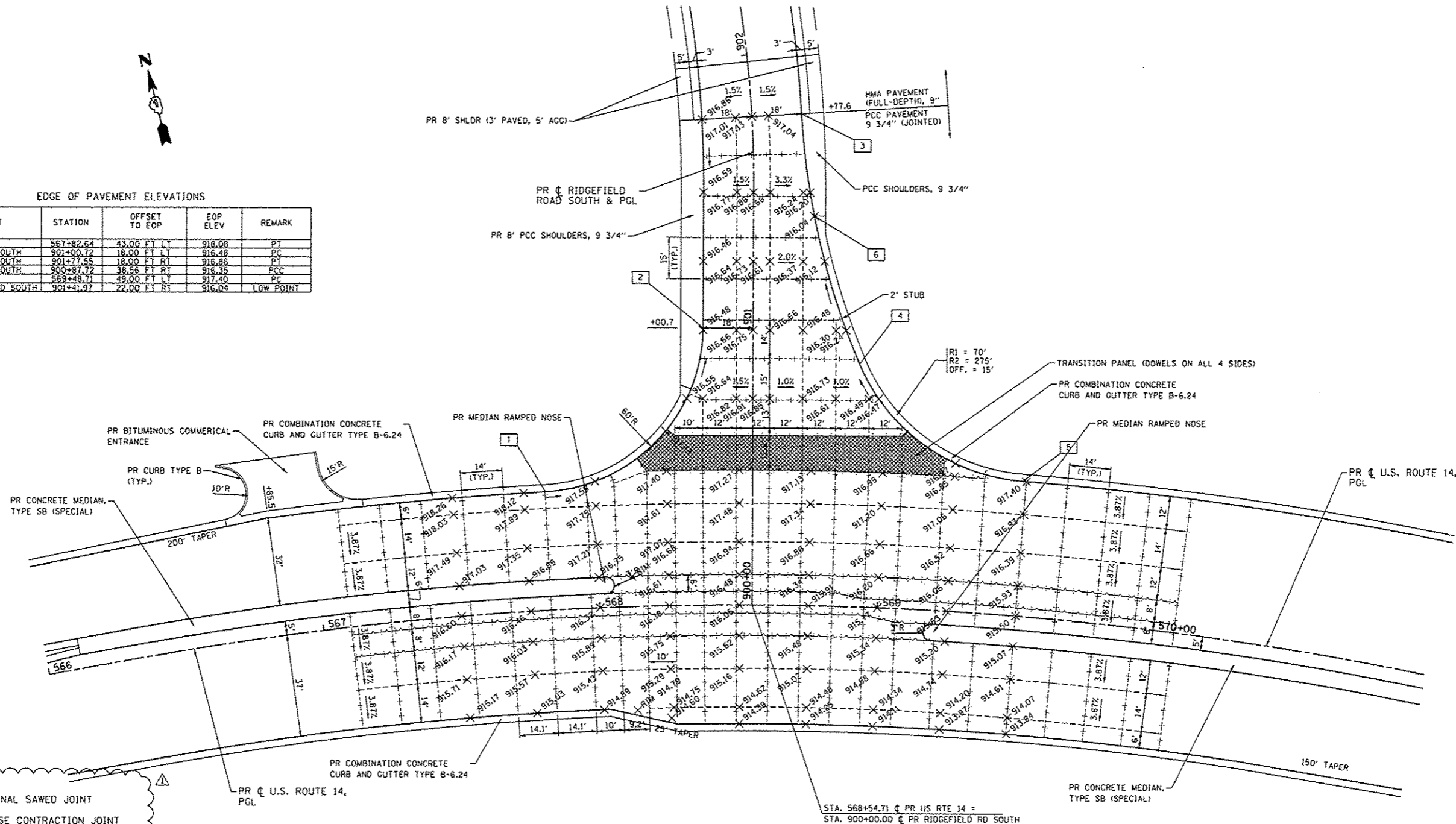

**EDGE OF PAVEMENT ELEVATIONS**

ALIGNMENT	STATION	OFFSET TO EOP	EOP ELEV	REMARK
1 ROUTE 14	567+82.64	43.00 FT LT	918.08	PT
2 RIDGEFIELD SOUTH	901+00.72	18.00 FT LT	916.48	PT
3 RIDGEFIELD SOUTH	901+77.55	18.00 FT RT	916.86	PT
4 RIDGEFIELD SOUTH	900+87.72	38.56 FT RT	916.35	PCC
5 ROUTE 14	569+49.71	49.00 FT LT	917.40	PC
6 RIDGEFIELD RD SOUTH	901+41.97	22.00 FT RT	916.04	LOW POINT



**LEGEND**

-----	LONGITUDINAL SAWED JOINT
-----	TRANSVERSE CONTRACTION JOINT
-----	LONGITUDINAL CONSTRUCTION JOINT

- NOTES:**
- ADDITIONAL JOINTS MAY BE REQUIRED IN THE FIELD, AS DIRECTED BY THE ENGINEER. EXACT LOCATIONS TO BE VERIFIED IN THE FIELD AND APPROVED BY THE ENGINEER.
  - SEE HIGHWAY STD 420101-04, 420106-04, 420111-03, 483001-04 AND DISTRICT 1 DETAIL BD52 FOR ADDITIONAL PAVEMENT JOINT DETAILS.
  - LONGITUDINAL CONSTRUCTION JOINTS WITH TIE BARS SHALL BE PLACED BETWEEN PCC PAVEMENT AND PCC SHOULDERS. NOT SHOWN FOR CLARITY.
  - FOR DETAIL ON CURB RAMP, SEE IDOT STD 424006-01.
  - FOR DETAIL ON MEDIAN RAMPED NOSE, SEE IDOT STD 606301-04.

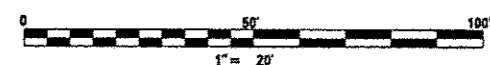

FILE NAME = S:\1685\CADD Sheets\0162517-shr\intersec	USER NAME = .USERNAME Addendum.dgn	DESIGNED - JPW	REVISED - 7/14/2014 HNL
	PLOT SCALE = 40.0000' / IN.	DRAWN - JPW	REVISED -
	PLOT DATE = 7/14/2014	CHECKED - MGZ	REVISED -
		DATE - 10/15/2013	REVISED -

**STATE OF ILLINOIS  
DEPARTMENT OF TRANSPORTATION**

**INTERSECTION JOINTING DETAILS  
RIDGEFIELD ROAD SOUTH & U.S. ROUTE 14**

SCALE: 1"=20'    SHEET NO. 212 OF 431 SHEETS    STA.    TO STA.

F.A.P. RTE. 305	SECTION 27R-3	COUNTY MCHENRY	TOTAL SHEETS 431	SHEET NO. 212
			CONTRACT NO. 62517	
[ILLINOIS] FED. AID PROJECT				