

STAGE 1

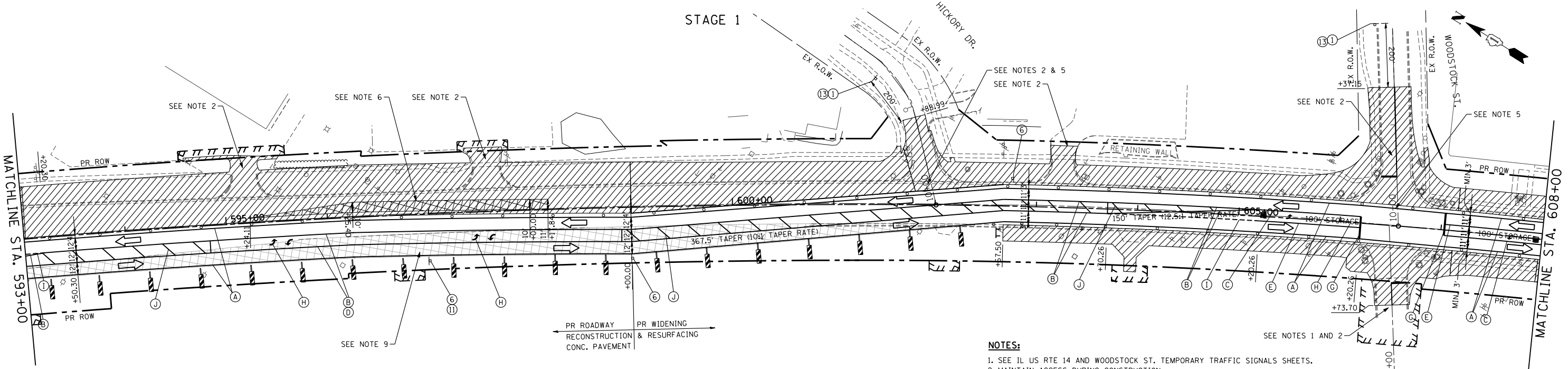

- NOTES:**
1. SEE IL US RTE 14 AND WOODSTOCK ST. TEMPORARY TRAFFIC SIGNALS SHEETS.
 2. MAINTAIN ACCESS DURING CONSTRUCTION.
 3. PROVIDE MINIMUM 50' TURNING RADII WHEN STAGING US RTE 14/IL 176 INTERSECTION RECONSTRUCTION.
 4. SEE IDOT STANDARD 701502-06 FOR LANE CLOSURE PROCEDURES FOR US RTE 14 RESURFACING STARTING AT STA. 599+00.
 5. BARRICADES PRESENT WHEN RESURFACING.
 6. TEMPORARY PAVEMENT CONSTRUCTED FOR STAGE 2 TRAFFIC.
 7. SEE SHEET 59 FOR MAINTENANCE OF CONSTRUCTION GENERAL NOTES, SEQUENCE OF CONSTRUCTION AND TEMPORARY TRAFFIC SIGN LEGEND.
 8. UTILIZE THE EXISTING SPEED LIMIT SIGNS WITHIN CONSTRUCTION LIMITS UNLESS NOTED OTHERWISE. THE SIGNS SIZES SHALL MATCH THE SIZES OF THE EXISTING SIGNS IN FIELD.
 9. TEMPORARY PAVEMENT BUILT IN PRE-STAGE 1.

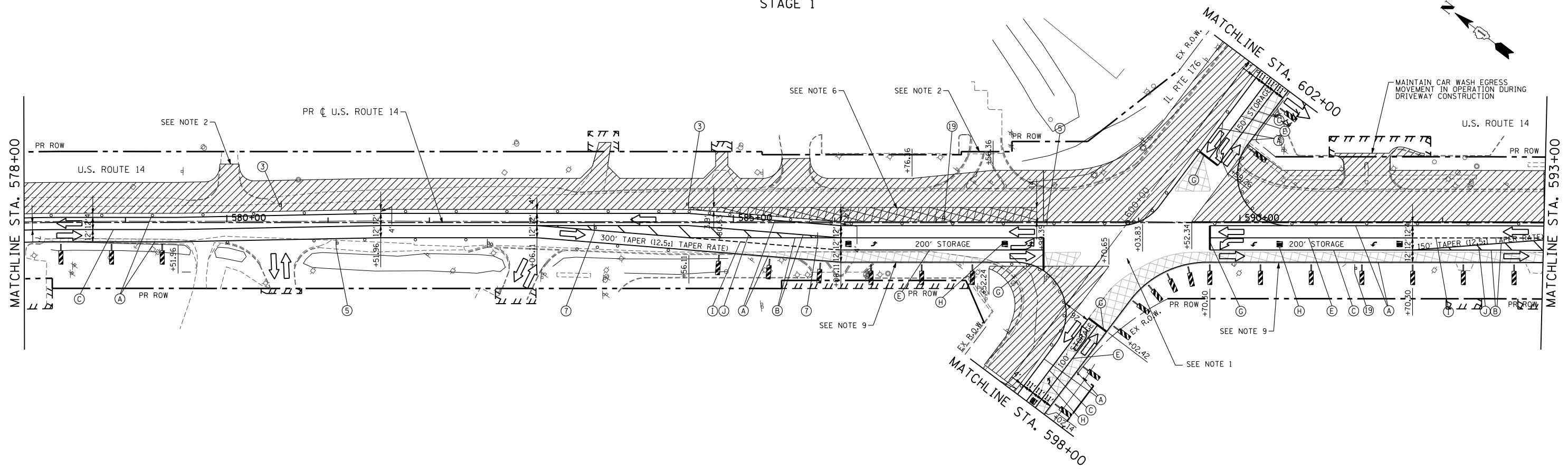
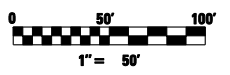

| | | | |
|---|------------------------------|-------------------|-----------|
| FILE NAME = | USER NAME = .USERNAME. | DESIGNED - JPW | REVISED - |
| S:\1606\CADD Sheets\0162517-sht-stag1.dgn | | DRAWN - JPW | REVISED - |
| | PLOT SCALE = 100.0000' / IN. | CHECKED - MGZ | REVISED - |
| | PLOT DATE = 10/14/2013 | DATE - 10/15/2013 | REVISED - |

**STATE OF ILLINOIS
DEPARTMENT OF TRANSPORTATION**

**MAINTENANCE OF TRAFFIC PLAN
US ROUTE 14 STAGE 1**

SCALE: 1"=50' SHEET NO. 71 OF 431 SHEETS STA. 578+00 TO STA. 608+00

| | | | | |
|--------------------|---------|---------|---------------------------|-----------|
| F.A. RTE. | SECTION | COUNTY | TOTAL SHEETS | SHEET NO. |
| 305 | 27R-3 | MCHENRY | 431 | 71 |
| CONTRACT NO. 62517 | | | ILLINOIS FED. AID PROJECT | |