

STAGE 2

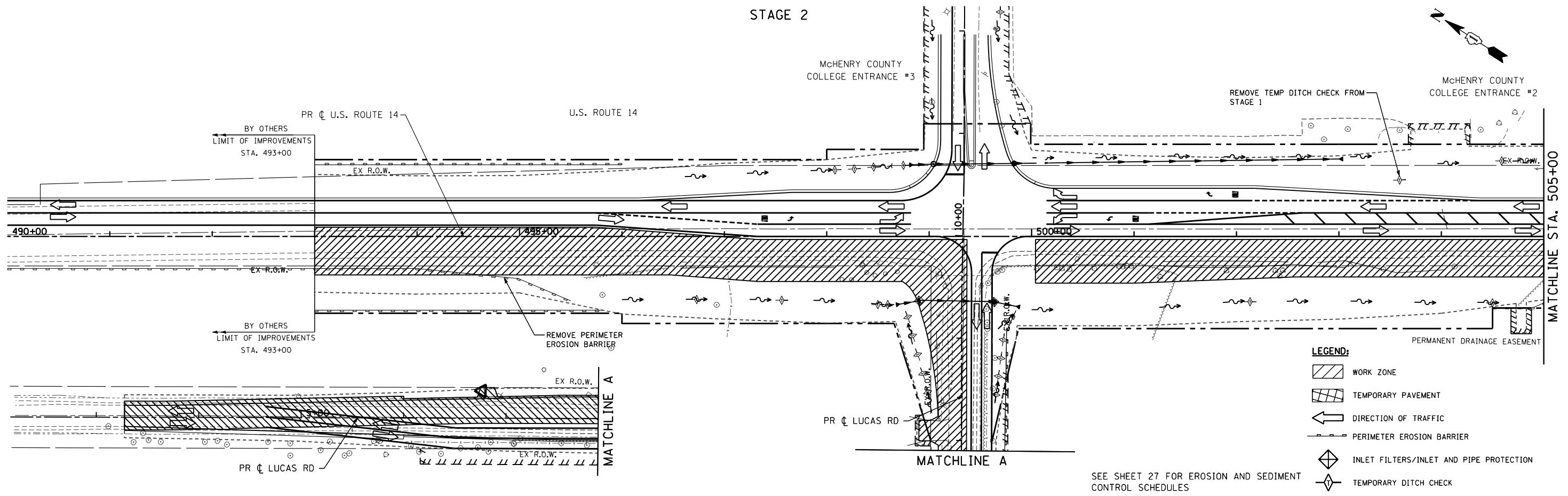

STAGE 2

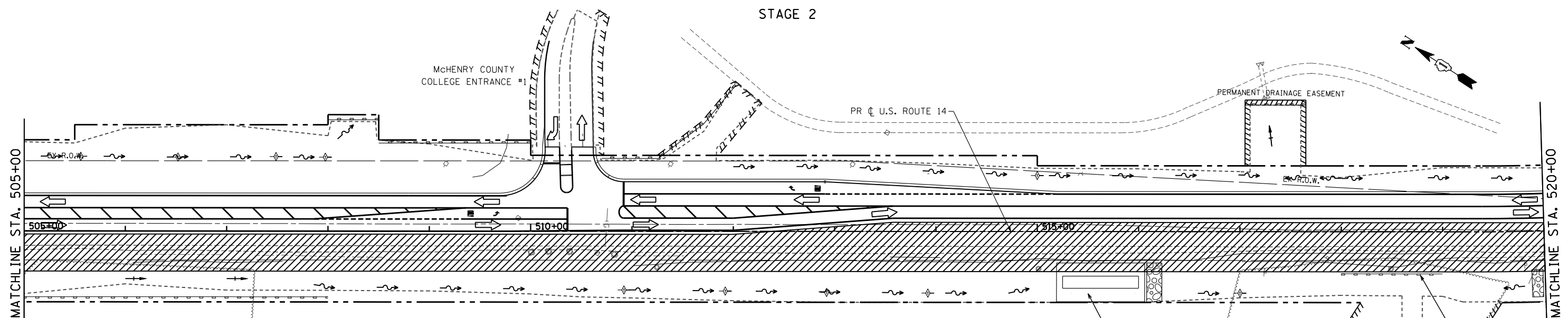

NOTES:

1. PLACE PERIMETER EROSION BARRIER PRIOR TO ANY EARTH DISTURBING OR GRADING ACTIVITIES.
  2. EXCAVATE THE PROPOSED DITCHES, COMPLETE EMBANKMENT/GRADING AND STABILIZE WITH PERMANENT LANDSCAPING MEASURES (SEEDING AND EROSION CONTROL BLANKET OR SOD -SEE LANDSCAPING PLANS) AS SOON AS POSSIBLE.
  3. PLACE TEMPORARY DITCH CHECKS AT THE LOCATIONS SHOWN ON THE PLANS.
  4. INSTALL INLET FILTERS IN ALL PROPOSED OPEN LID INLETS AND CATCH BASINS AND IN EXISTING OPEN LID DRAINAGE STRUCTURES THAT WILL RECEIVE SEDIMENT LADEN DISCHARGE AT THE DIRECTION OF THE ENGINEER (WITHIN OPEN AREAS). INSTALL INLET AND PIPE PROTECTION (SILT FENCE WITH CROSS BRACING) AT OPEN LID DRAINAGE STRUCTURES LOCATED IN DITCHES AND SWALES AT LOCATIONS SHOWN ON PLANS OR AS DIRECTED BY THE ENGINEER
  5. TEMPORARY EROSION CONTROL SEEDING SHALL BE PLACED ON ERODABLE AREAS EARTH AREAS IN ACCORDANCE WITH THE STANDARD SPECIFICATIONS AT THE DIRECTION OF THE ENGINEER.
  6. THE CONTRACTOR SHALL MAINTAIN TEMPORARY EROSION CONTROL ITEMS INSTALLED IN PRE-STAGE 1 AND STAGE 1 THAT DO NOT INTERFERE WITH STAGE 2 WORK (PRE-STAGE 1 ITEMS AND STAGE 1 ITEMS ARE SHOWN ON PLANS FOR REFERENCE).
- STAGE 3 NOTE (STAGE 3 CONSISTS OF THE CONSTRUCTION OF THE CENTER LANDSCAPED MEDIAN-NO SEPARATE EROSION AND SEDIMENT CONTROL PLANS):
- STABILIZE THE CENTER MEDIAN AS SHOWN ON THE LANDSCAPING PLANS. FOR AREAS WITH SEED USE TEMPORARY EROSION CONTROL BLANKET. INSTALL INLET FILTERS IN ANY OPEN LID DRAINAGE STRUCTURES CONSTRUCTED WITH THE MEDIAN. MAINTAIN THE INLET FILTERS (NEW OR CONSTRUCTED IN PREVIOUS STAGES) WITHIN THE PAVEMENT AREA UNTIL THE VEGETATION IN THE MEDIAN IS ESTABLISHED AT THE DIRECTION OF THE ENGINEER.

REDUCE WIDTH OF SEDIMENT TRAP CONSTRUCTED IN PRE-STAGE 1 TO AVOID CONFLICT WITH STAGE 2 WORK AT DIRECTION OF THE ENGINEER. REMOVE TRAP AT COMPLETION OF STAGE 2 AND GRADE DITCH AND SIDESLOPES TO FINAL CONFIGURATION.

FILE NAME =	USER NAME = .USERNAME.	DESIGNED -	AWM	REVISED -	
S:\1606\CADD Sheets\0162517-sht-ErosionStage2.dgn		DRAWN -	DA	REVISED -	
		PLOT SCALE =	100.0000' / IN.	CHECKED -	JWM
		PLOT DATE =	11/6/2013	DATE -	10/15/2013

STATE OF ILLINOIS  
DEPARTMENT OF TRANSPORTATION

EROSION AND SEDIMENT CONTROL PLAN  
US ROUTE 14 - STAGE 2

SCALE: 1"=50' SHEET NO. 107 OF 431 SHEETS STA. 490+00 TO STA. 520+00

F.A. RTE.	SECTION	COUNTY	TOTAL SHEETS	SHEET NO.
305	27R-3	MCHENRY	431	107
CONTRACT NO. 62517			ILLINOIS FED. AID PROJECT	