

McHENRY COUNTY
COLLEGE ENTRANCE #3

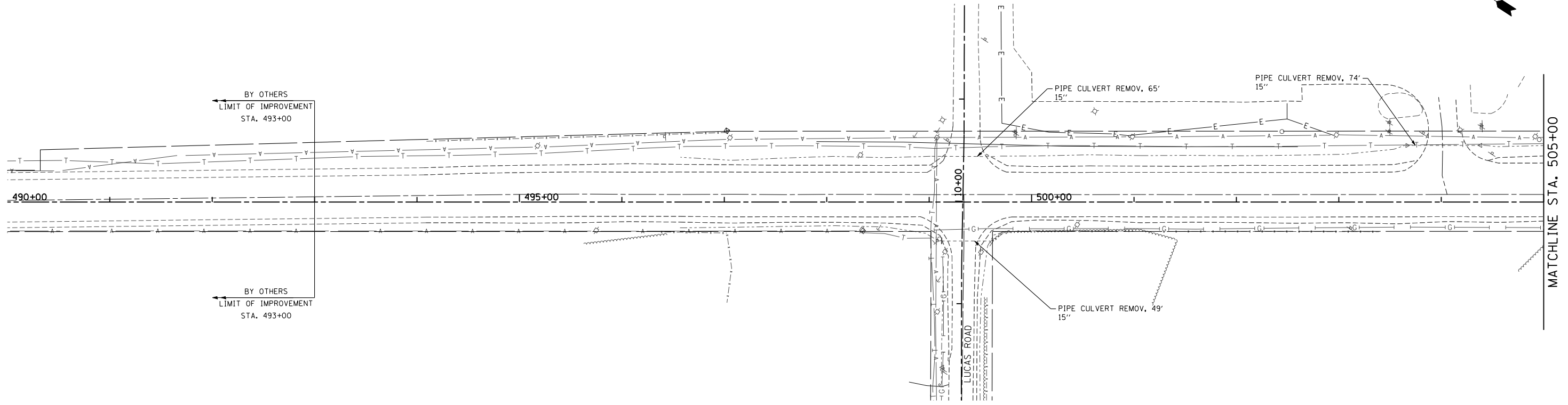

COLLEGE ENTR #3 STA. 12+00

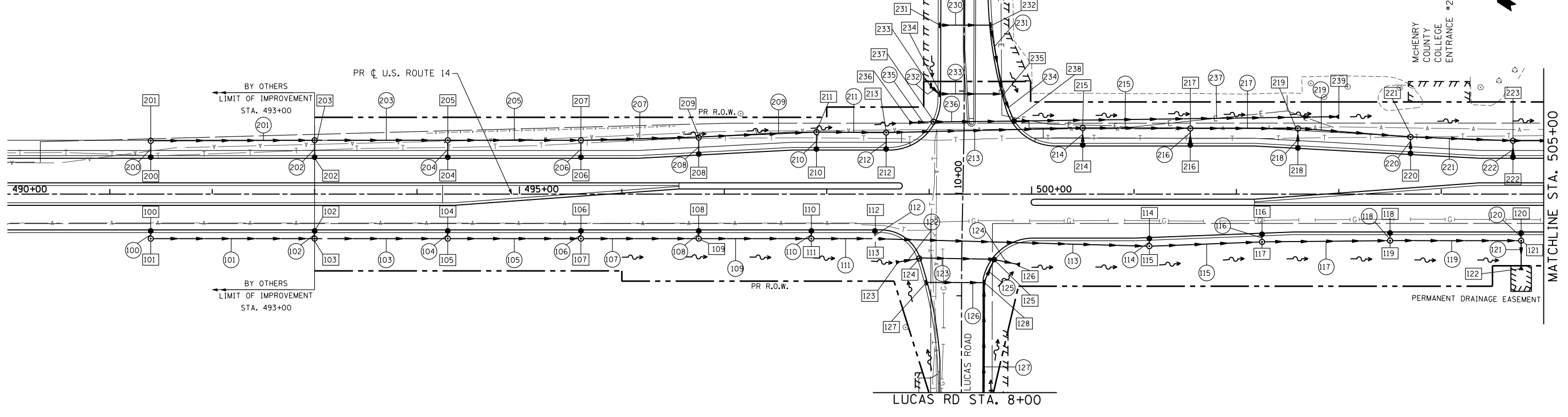

FILE NAME = S:\1606\CADD Sheets\0162517-sht-drain.dwg	USER NAME = .USERNAME.	DESIGNED - AWM	REVISED -
		DRAWN - DA	REVISED -
		CHECKED - MGZ	REVISED -
		DATE - 10/15/2013	REVISED -

STATE OF ILLINOIS
DEPARTMENT OF TRANSPORTATION

DRAINAGE AND UTILITY PLAN
US ROUTE 14

SCALE: 1"=50' SHEET NO. 121 OF 431 SHEETS STA. 490+00.00 TO STA. 505+00.00

F.A.P. RTE.	SECTION	COUNTY	TOTAL SHEETS	SHEET NO.
305	27R-3	MCHENRY	431	121
CONTRACT NO. 62517				
ILLINOIS FED. AID PROJECT				