

EDGE OF PAVEMENT ELEVATIONS

ALIGNMENT	STATION	OFFSET TO EOP (FT)	EOP ELEV	REMARK	
1	LUCAS RD	498+66.12	43.00 LT	928.37	PT
2	LUCAS RD	499+16.12	32.91 LT	927.16	PC
3	LUCAS RD	499+12.72	74.39 LT	927.00	PCC
4	ROUTE 14	500+10.68	47 LT	927.50	PC
5	ROUTE 14	500+01.06	43 RT	927.69	PT
6	LUCAS RD	9+36.46	21 RT	927.70	PC
7	LUCAS RD	8+38.08	21 LT	927.97	PT
8	LUCAS RD	9+36.36	40.74 LT	926.90	PCC/LOW
9	ROUTE 14	498+52.31	35 RT	928.59	PC
10	LUCAS RD	12+01.30	23 RT	928.27	PT
11	LUCAS RD	8+12.51	21 LT	928.21	PC
12	LUCAS RD	9+36.55	30.03 RT	927.27	LOW
13	COL. ENTR #3	10+70.12	47.08 RT	927.00	LOW
14	COL. ENTR. #3	10+68.80	28.60 LT	927.10	LOW

LEGEND

- LONGITUDINAL CONSTRUCTION JOINT
- ++++ SAWED TRANSVERSE CONTRACTION JOINT
- ~ ~ ~ ~ LONGITUDINAL CONSTRUCTION JOINT W/ DOWEL BARS

NOTES:

1. ADDITIONAL JOINTS MAY BE REQUIRED IN THE FIELD, AS DIRECTED BY THE ENGINEER. EXACT LOCATIONS TO BE VERIFIED IN THE FIELD, AND APPROVED BY THE ENGINEER.
2. SEE HIGHWAY STD 420101-04, 420106-04, 420111-03 AND DISTRICT 1 DETAIL BD52 FOR ADDITIONAL PAVEMENT JOINT DETAILS.
3. LONGITUDINAL CONSTRUCTION JOINTS WITH TIE BARS SHALL BE PLACED BETWEEN PCC PAVEMENT AND PCC SHOULDERS. NOT SHOWN FOR CLARITY.
4. FOR DETAIL ON CURB RAMP, SEE IDOT STD 424006-01.
5. FOR DETAIL ON MEDIAN RAMPED NOSE, SEE IDOT STD 606301-04.

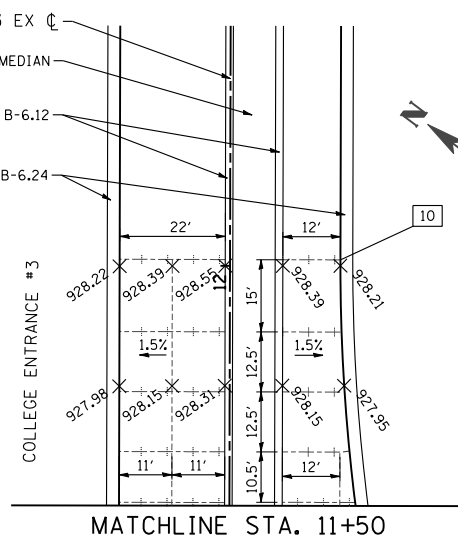

FILE NAME =	USER NAME = .USERNAME.	DESIGNED - JPW	REVISED -
S:\1606\CADD Sheets\0162517-sht-intersec.dgn		DRAWN - JPW	REVISED -
	PLOT SCALE = 40.0000' / IN.	CHECKED - MGZ	REVISED -
	PLOT DATE = 10/14/2013	DATE - 10/15/2013	REVISED -

STATE OF ILLINOIS
DEPARTMENT OF TRANSPORTATION

INTERSECTION JOINTING DETAILS
LUCAS ROAD /COLLEGE ENTRANCE #3 & U.S. ROUTE 14

SCALE: 1"=20' SHEET NO. 210 OF 431 SHEETS STA. TO STA.

F.A.P. RTE.	SECTION	COUNTY	TOTAL SHEETS	SHEET NO.
305	27R-3	MCHENRY	431	210
CONTRACT NO. 62517				
ILLINOIS FED. AID PROJECT				