

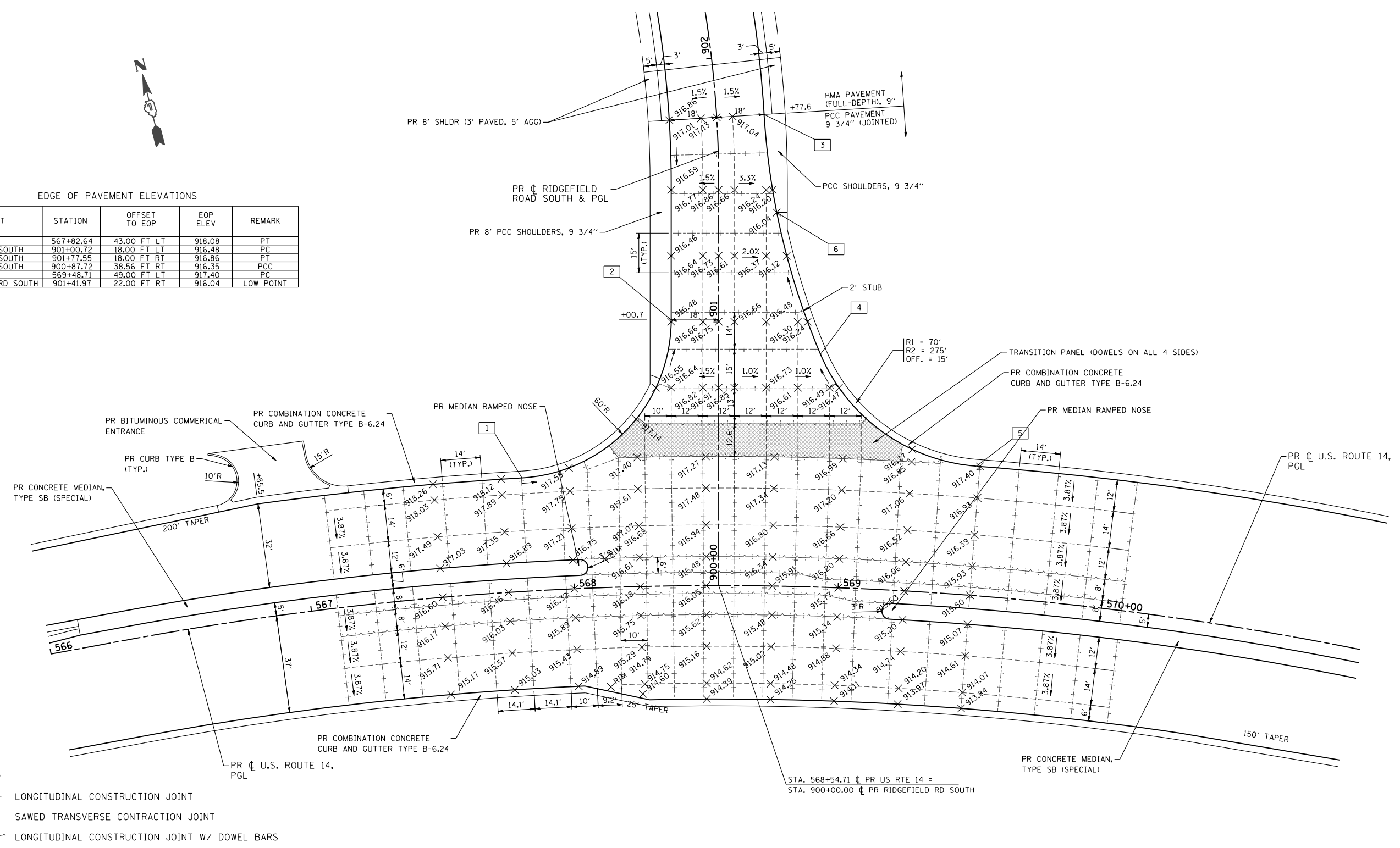

EDGE OF PAVEMENT ELEVATIONS

ALIGNMENT	STATION	OFFSET TO EOP	EOP ELEV	REMARK
1 ROUTE 14	567+82.64	43.00 FT LT	918.08	PT
2 RIDGEFIELD SOUTH	901+00.72	18.00 FT LT	916.48	PC
3 RIDGEFIELD SOUTH	901+77.55	18.00 FT RT	916.86	PT
4 RIDGEFIELD SOUTH	900+87.72	38.56 FT RT	916.35	PCC
5 ROUTE 14	569+48.71	49.00 FT LT	917.40	PC
6 RIDGEFIELD RD SOUTH	901+41.97	22.00 FT RT	916.04	LOW POINT



LEGEND

- LONGITUDINAL CONSTRUCTION JOINT
- ++++ SAWED TRANSVERSE CONTRACTION JOINT
- +---+--- LONGITUDINAL CONSTRUCTION JOINT W/ DOWEL BARS

NOTES:

1. ADDITIONAL JOINTS MAY BE REQUIRED IN THE FIELD, AS DIRECTED BY THE ENGINEER. EXACT LOCATIONS TO BE VERIFIED IN THE FIELD, AND APPROVED BY THE ENGINEER.
2. SEE HIGHWAY STD 420101-04, 420106-04, 420111-03 AND DISTRICT 1 DETAIL BD52 FOR ADDITIONAL PAVEMENT JOINT DETAILS.
3. LONGITUDINAL CONSTRUCTION JOINTS WITH TIE BARS SHALL BE PLACED BETWEEN PCC PAVEMENT AND PCC SHOULDERS. NOT SHOWN FOR CLARITY.

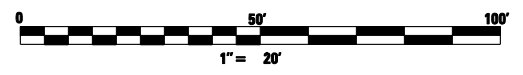

FILE NAME =	USER NAME = .USERNAME.	DESIGNED - JPW	REVISED -	STATE OF ILLINOIS DEPARTMENT OF TRANSPORTATION	INTERSECTION JOINTING DETAILS RIDGEFIELD ROAD SOUTH & U.S. ROUTE 14	F.A.P. RTE.	SECTION	COUNTY	TOTAL SHEETS	SHEET NO.
S:\1606\CADD Sheets\0162517-sht-intersec.dgn	DRAWN - JPW	REVISED -	305			27R-3	MCHENRY	431	212	
PLOT SCALE = 40.0000' / IN.	CHECKED - MGZ	REVISED -	CONTRACT NO. 62517							
PLOT DATE = 10/14/2013	DATE - 10/15/2013	REVISED -	ILLINOIS FED. AID PROJECT							
				SCALE: 1"=20'	SHEET NO. 212 OF 431 SHEETS	STA.	TO STA.			