

EDGE OF PAVEMENT ELEVATIONS

ALIGNMENT	STATION	OFFSET TO EOP	EOP ELEV	REMARK	
1	LENNY DRIVE	1+45.21	12.00 FT RT	922.47	PC
2	LENNY DRIVE	1+95.21	62.00 FT RT	921.62	PT
3	LENNY DRIVE	2+20.27	37.00 FT RT	922.00	PC
4	LENNY DRIVE	2+45.27	12.00 FT RT	922.43	PT
5	LENNY DRIVE	3+42.26	12.00 FT LT	921.88	PC
6	LENNY DRIVE	3+90.00	47.12 FT LT	922.03	PT

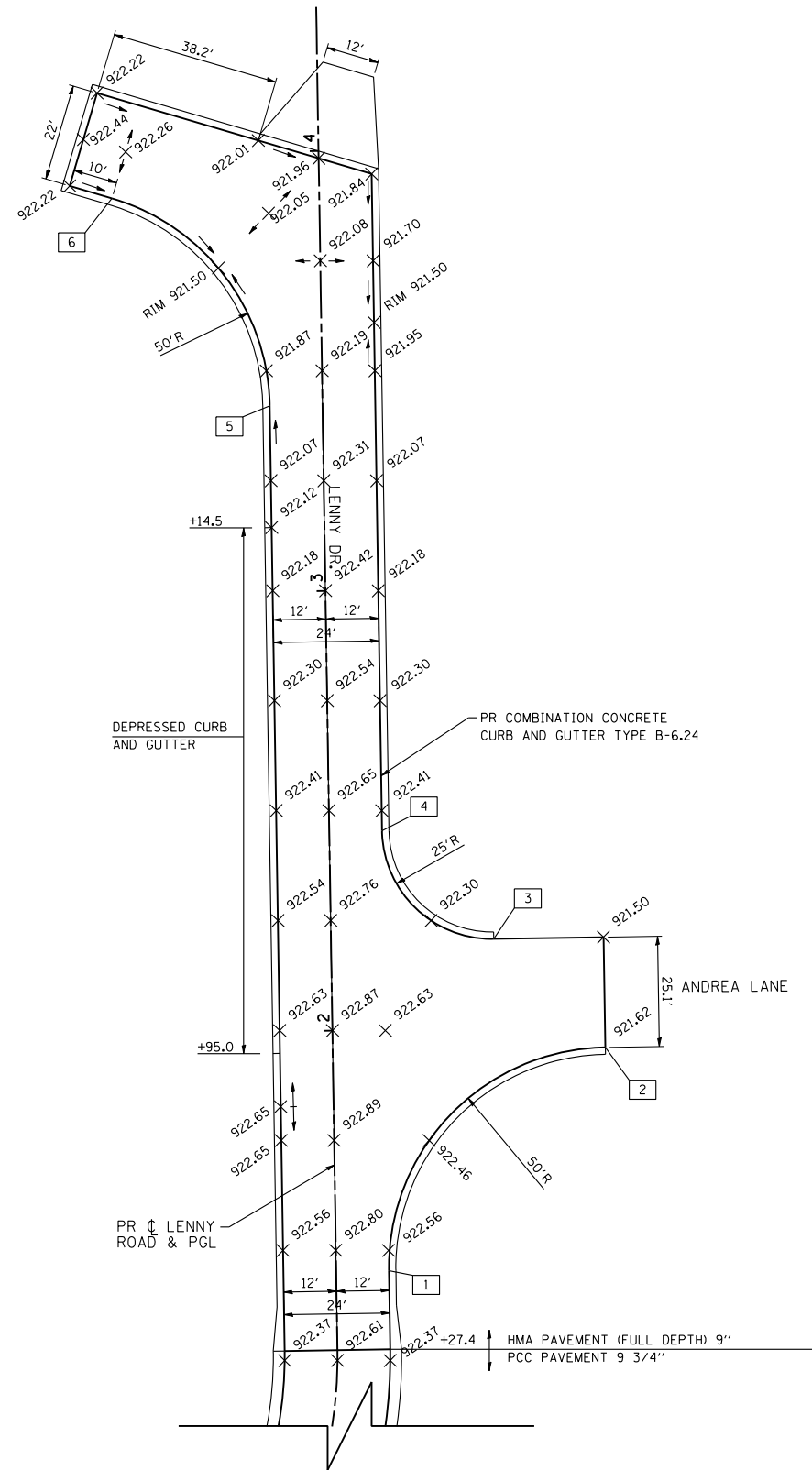

FILE NAME =	USER NAME = .USERNAME.	DESIGNED - CGC	REVISED -
S:\1606\CADD Sheets\0162517-sht-intersec.dgn		DRAWN - CGC	REVISED -
	PLOT SCALE = 40.0000' / IN.	CHECKED - MGZ	REVISED -
	PLOT DATE = 10/9/2013	DATE - 10/15/2013	REVISED -

STATE OF ILLINOIS
DEPARTMENT OF TRANSPORTATION

INTERSECTION JOINTING DETAILS
LENNY ROAD & ANDREA LANE

SCALE: 1"=20' SHEET NO. 214 OF 431 SHEETS STA. TO STA.

F.A.P. RTE.	SECTION	COUNTY	TOTAL SHEETS	SHEET NO.
305	27R-3	MCHENRY	431	214
				CONTRACT NO. 62517
ILLINOIS FED. AID PROJECT				