

EDGE OF PAVEMENT ELEVATIONS

| ALIGNMENT | STATION | OFFSET TO EOP | EOP ELEV | REMARK |
|-----------|--------------|---------------|-------------|------------|
| 1 | IL ROUTE 176 | 597+76.23 | 18.00 FT LT | 906.88 PT |
| 2 | IL ROUTE 176 | 598+59.82 | 32.29 FT RT | 906.92 PCC |
| 3 | ROUTE 14 | 587+40.56 | 41.00 FT RT | 908.27 PC |
| 4 | ROUTE 14 | 588+28.84 | 49.00 FT LT | 907.84 PT |
| 5 | IL ROUTE 176 | 600+99.26 | 30.00 FT LT | 907.31 PC |
| 6 | IL ROUTE 176 | 602+24.88 | 18.00 FT RT | 908.18 PT |
| 7 | IL ROUTE 176 | 601+41.58 | 32.29 FT RT | 907.39 PCC |
| 8 | ROUTE 14 | 590+38.02 | 41.00 FT LT | 907.37 PC |
| 9 | ROUTE 14 | 589+43.73 | 49.00 FT RT | 907.48 PT |
| 10 | IL ROUTE 176 | 599+02.14 | 30.00 FT RT | 907.04 PC |

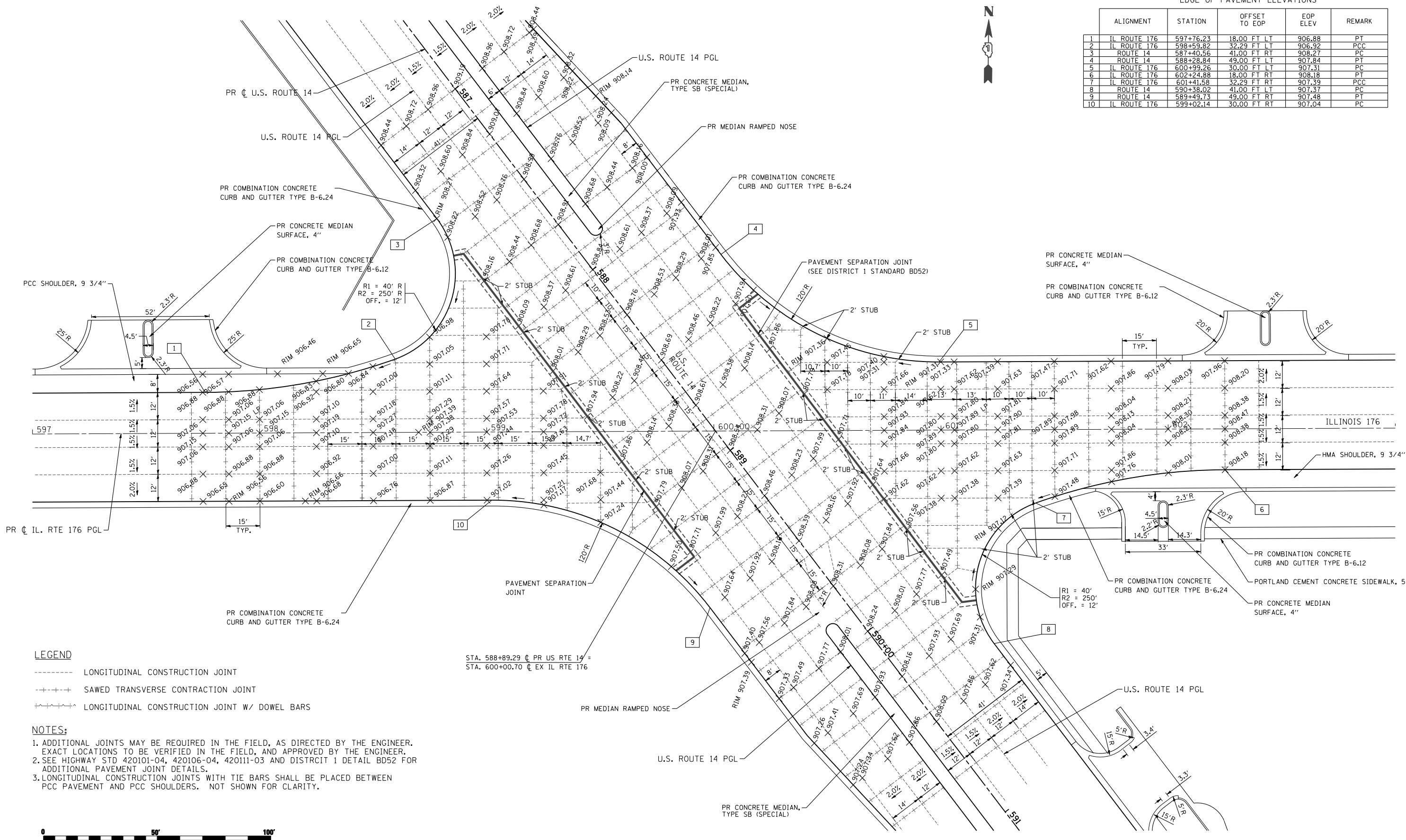

LEGEND

- LONGITUDINAL CONSTRUCTION JOINT
- - - - - SAWED TRANSVERSE CONTRACTION JOINT
- - - - - LONGITUDINAL CONSTRUCTION JOINT W/ DOWEL BARS

NOTES:

1. ADDITIONAL JOINTS MAY BE REQUIRED IN THE FIELD, AS DIRECTED BY THE ENGINEER. EXACT LOCATIONS TO BE VERIFIED IN THE FIELD, AND APPROVED BY THE ENGINEER.
2. SEE HIGHWAY STD 420101-04, 420106-04, 420111-03 AND DISTRICT 1 DETAIL BD52 FOR ADDITIONAL PAVEMENT JOINT DETAILS.
3. LONGITUDINAL CONSTRUCTION JOINTS WITH TIE BARS SHALL BE PLACED BETWEEN PCC PAVEMENT AND PCC SHOULDERS. NOT SHOWN FOR CLARITY.

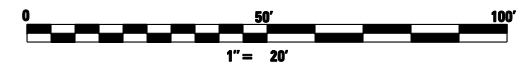

| | | | |
|--|------------------------|-------------------|-----------|
| FILE NAME = | USER NAME = .USERNAME. | DESIGNED - JPW | REVISED - |
| S:\1606\CADD Sheets\0162517-sht-intersec.dgn | | DRAWN - JPW | REVISED - |
| | | CHECKED - MGZ | REVISED - |
| | | DATE - 10/15/2013 | REVISED - |

STATE OF ILLINOIS
DEPARTMENT OF TRANSPORTATION

INTERSECTION JOINTING DETAILS
IL 176 & U.S. ROUTE 14

SCALE: 1"=20' SHEET NO. 215 OF 431 SHEETS STA. TO STA.

| | | | | |
|---------------------------|---------|---------|--------------|-----------|
| F.A.P. RTE. | SECTION | COUNTY | TOTAL SHEETS | SHEET NO. |
| 305 | 27R-3 | MCHENRY | 431 | 215 |
| CONTRACT NO. 62517 | | | | |
| ILLINOIS FED. AID PROJECT | | | | |