

ORIGINAL SURVEY	SURVEYED	BY	DATE
NOTE BOOK	PLOTTED		
	TEMPLATE		
	AREAS		
	CHECKED		

FINAL SURVEY	SURVEYED	BY	DATE
NOTE BOOK	PLOTTED		
	TEMPLATE		
	AREAS		
	CHECKED		

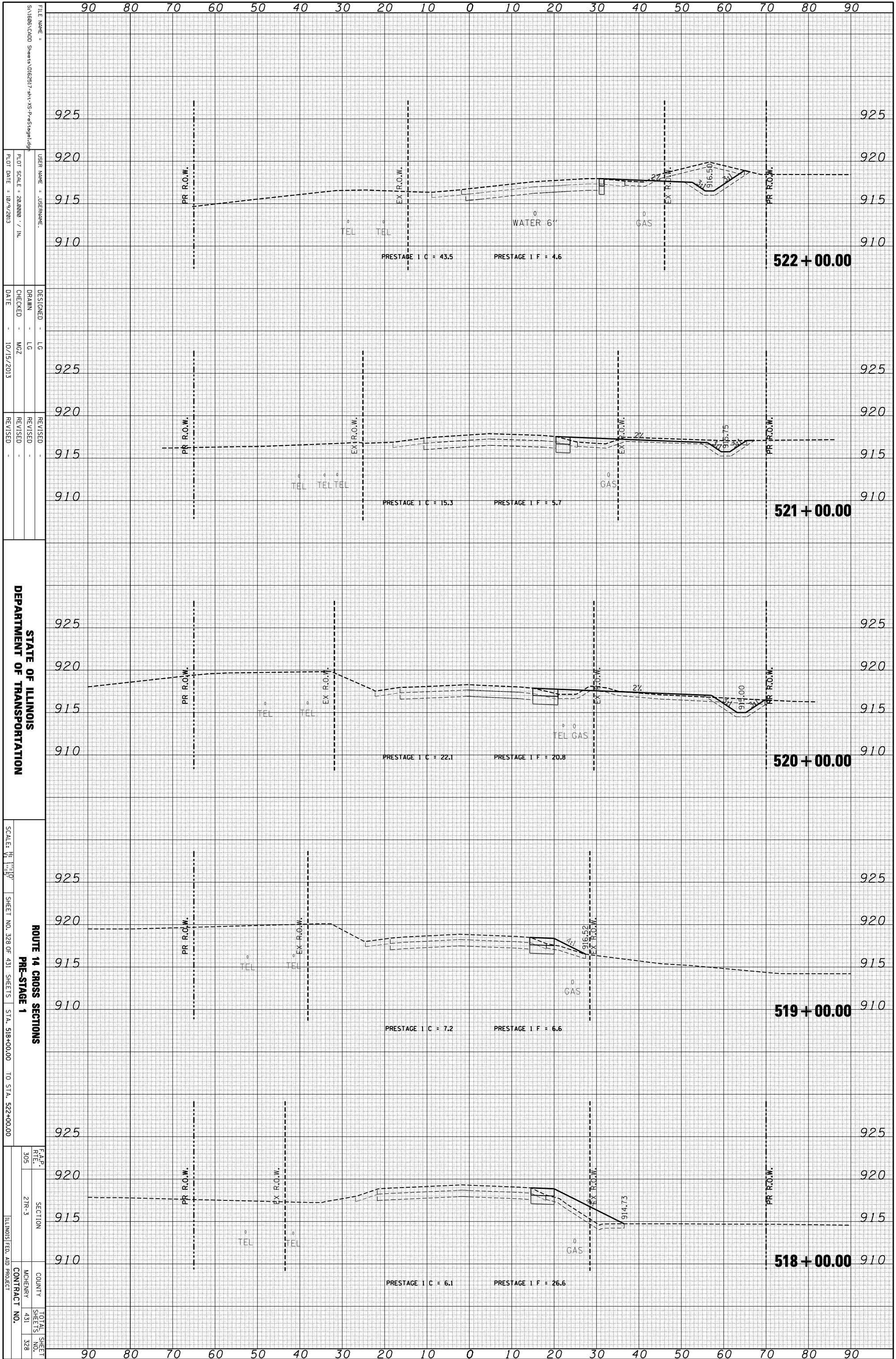

STATE OF ILLINOIS
DEPARTMENT OF TRANSPORTATION

ROUTE 14 CROSS SECTIONS
PRE-STAGE 1

SCALE: 1" = 10'	SHEET NO. 328 OF 431 SHEETS	STA. 518+00.00 TO STA. 522+00.00
F.A.P. REL. 305	SECTION 21R-3	COUNTY MCHENNY
TOTAL SHEET NO. 328		CONTRACT NO. 431
ILLINOIS FED. AID PROJECT		