

ORIGINAL SURVEY	SURVEYED	BY	DATE
NOTE BOOK	PLOTTED		
	TEMPLATE		
	AREAS		
	AREAS CHECKED		

FINAL SURVEY	SURVEYED	BY	DATE
NOTE BOOK	PLOTTED		
	TEMPLATE		
	AREAS		
	AREAS CHECKED		

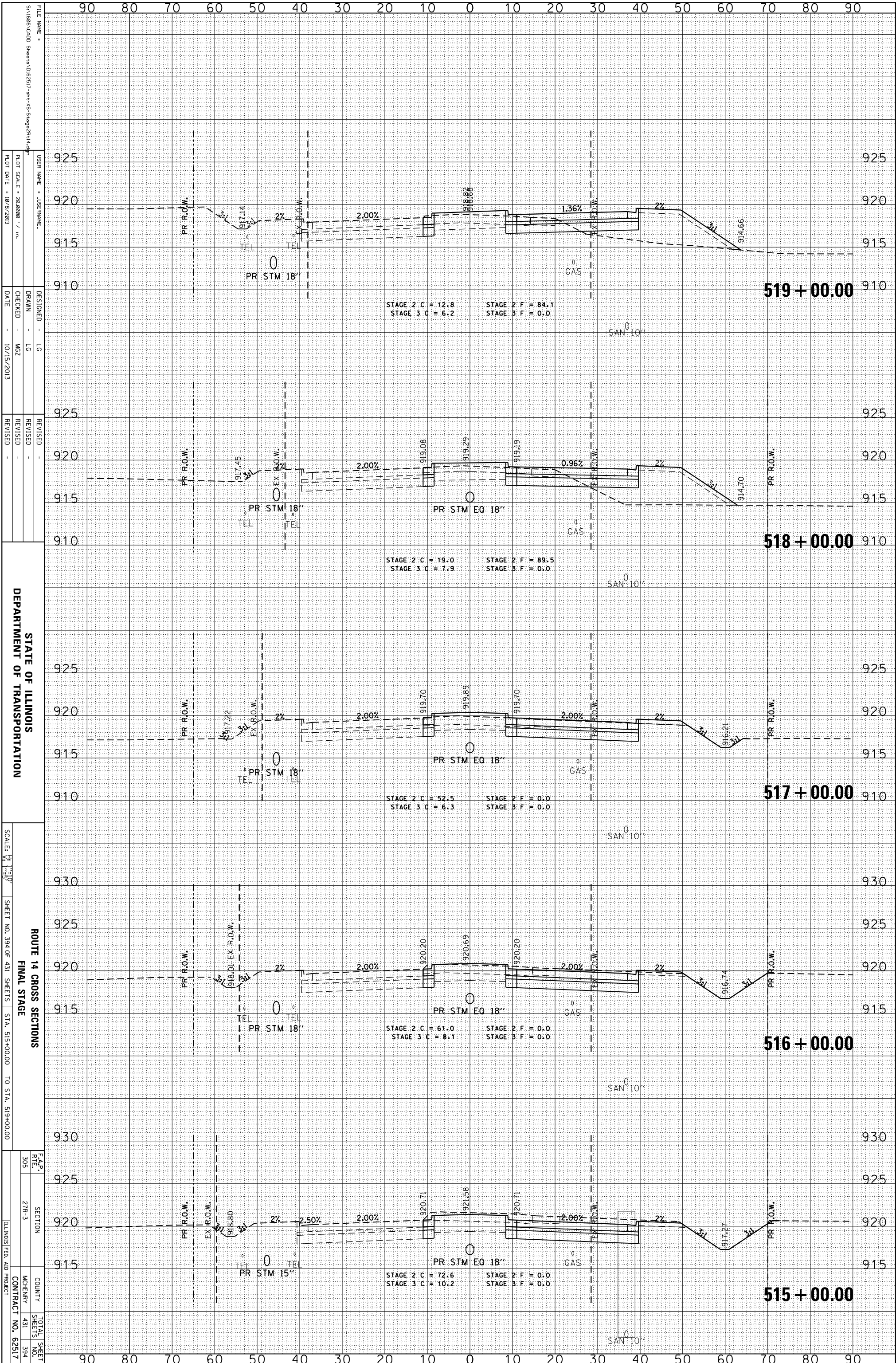

STATE OF ILLINOIS
DEPARTMENT OF TRANSPORTATION

ROUTE 14 CROSS SECTIONS
FINAL STAGE

SCALE: 1" = 10'	SHEET NO. 394 OF 431 SHEETS	STA. 515+00.00 TO STA. 519+00.00
F.A.P. R.T.E.	SECTION	COUNTY
305	27R-3	MCHEMERY
		CONTRACT NO. 62517
		ILLINOIS FED. AID PROJECT

FILE NAME =	USER NAME =	DESIGNED -	REVISION
51606.CADD	Sheet 394 of 431 - Sta. 515+00.00 to 519+00.00	LG	
		DRAWN -	REVISION
		LG	
		CHECKED -	REVISION
		MZ	
		DATE -	
		10/15/2013	

PLLOT SCALE = 28,000 / in.
PLLOT DATE = 10/9/2013

TOTAL SHEET NO. 394