

ORIGINAL SURVEY	SURVEYED	BY	DATE
NOTE BOOK	PLOTTED		
	TEMPLATE		
	AREAS		
	CHECKED		

FINAL SURVEY	SURVEYED	BY	DATE
NOTE BOOK	PLOTTED		
	TEMPLATE		
	AREAS		
	CHECKED		

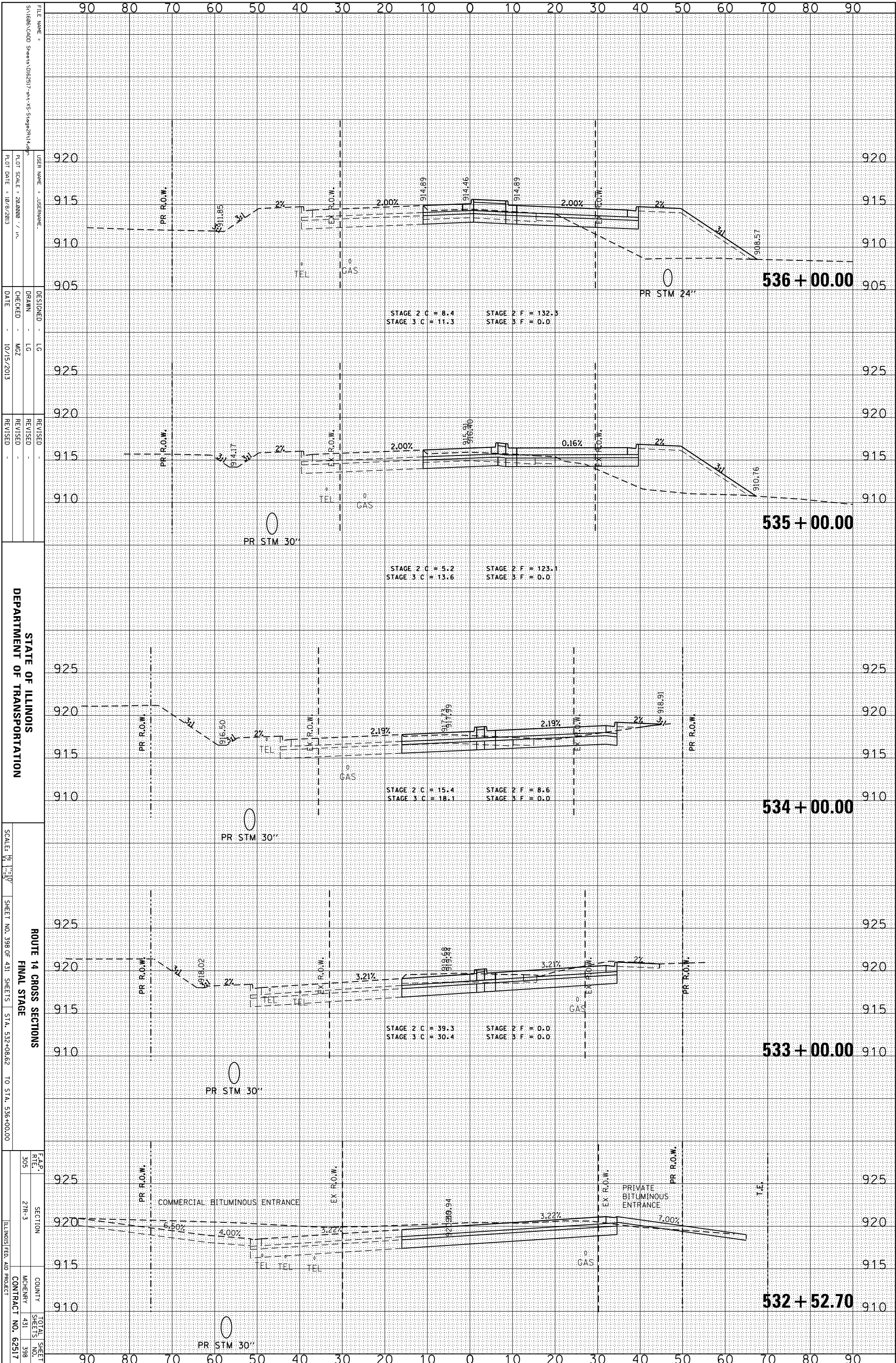

STATE OF ILLINOIS  
 DEPARTMENT OF TRANSPORTATION

ROUTE 14 CROSS SECTIONS  
 FINAL STAGE  
 SCALE: 1" = 50'  
 SHEET NO. 398 OF 431 SHEETS STA. 532+08.62 TO STA. 536+00.00

F.A.P. R.T.E.	SECTION	COUNTY	TOTAL SHEETS
305	27R-3	MCHEMERY	398
		CONTRACT NO.	62517
		ILLINOIS FED. AID PROJECT	

FILE NAME = S:\1606\CADD Sheets\062517-rt-14-SS-Stage2Final.dgn  
 USER NAME = JUSEPHNAME  
 DESIGNED - LG  
 DRAWN - LG  
 CHECKED - MZ  
 DATE - 10/15/2013

REVISIONS  
 REVISION NO. 1  
 REVISION DESCRIPTION  
 DATE