

ORIGINAL SURVEY	SURVEYED	BY	DATE
NOTE BOOK	PLOTTED		
	TEMPLATE		
	AREAS		
	CHECKED		

FINAL SURVEY	SURVEYED	BY	DATE
NOTE BOOK	PLOTTED		
	TEMPLATE		
	AREAS		
	CHECKED		

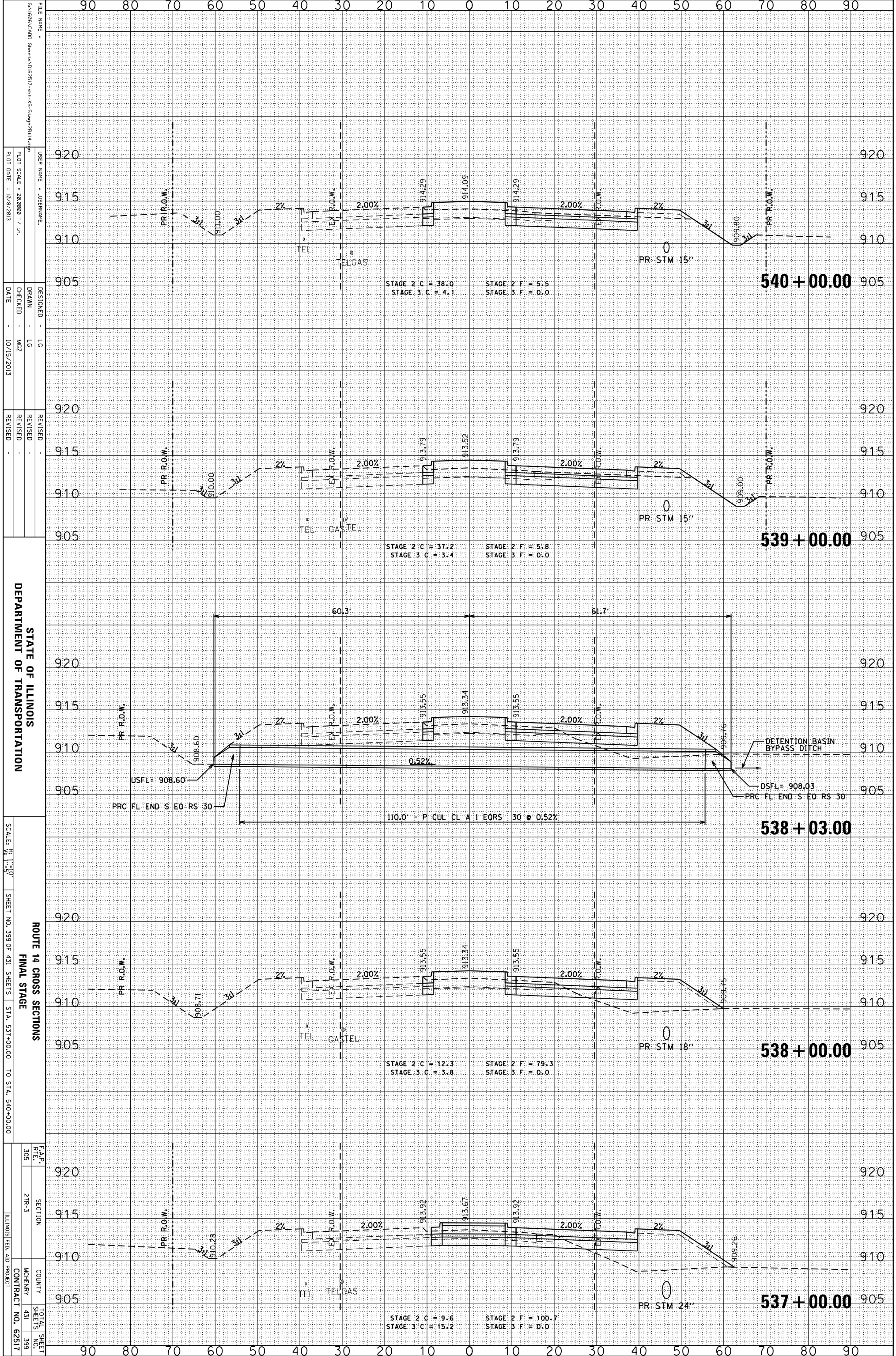

FILE NAME = S:\1606\CADD Sheets\062517-rt-v3-Stage2R1.dwg
 USER NAME = JUSERNAME
 DESIGNER = LG
 DRAWN = LG
 CHECKED = MZ
 DATE = 10/15/2013

REVISIONS
 REVISION NO. | DATE | DESCRIPTION

STATE OF ILLINOIS
 DEPARTMENT OF TRANSPORTATION

ROUTE 14 CROSS SECTIONS
 FINAL STAGE
 SCALE: 1" = 10'
 SHEET NO. 399 OF 431 SHEETS STA. 537+00.00 TO STA. 540+00.00

F.A.P. R.T.L.	SECTION	COUNTY	TOTAL SHEETS
305	27R-3	MCHEMERY	399
CONTRACT NO. 62517		ILLINOIS FED. AID PROJECT	