

ORIGINAL SURVEY	SURVEYED	BY	DATE
NOTE BOOK	PLOTTED		
	TEMPLATE		
	AREAS		
	CHECKED		

FINAL SURVEY	SURVEYED	BY	DATE
NOTE BOOK	PLOTTED		
	TEMPLATE		
	AREAS		
	CHECKED		

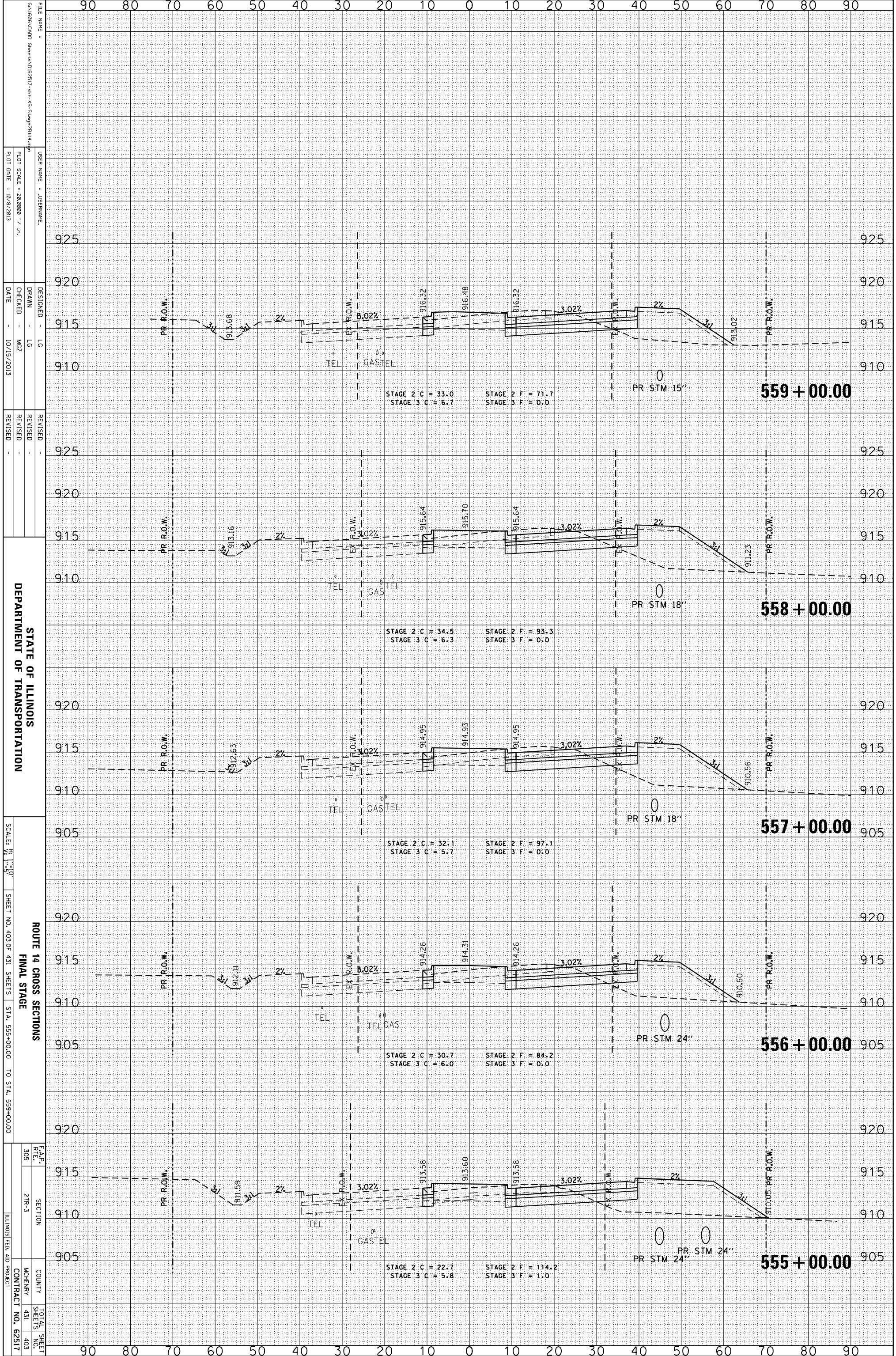

FILE NAME = S:\1606\CADD Sheets\0162517-rt-15-Stage2R14.dgn
 USER NAME = JUSEPHNAME
 DESIGNER = LG
 DRAWN = LG
 CHECKED = MZ
 DATE = 10/15/2013

REVISIONS
 REVISION
 REVISION
 REVISION

STATE OF ILLINOIS
 DEPARTMENT OF TRANSPORTATION
 SCALE: 1" = 10'
 SHEET NO. 403 OF 431 SHEETS STA. 555+00.00 TO STA. 559+00.00

ROUTE 14 CROSS SECTIONS
 FINAL STAGE
 F.A.P. SECTION
 R.T.L. SECTION
 COUNTY
 MCHENRY 431
 CONTRACT NO. 62517
 TOTAL SHEET NO. 403