

ORIGINAL SURVEY	SURVEYED	BY	DATE
NOTE BOOK	PLOTTED		
	TEMPLATE		
	AREAS		
	CHECKED		

FINAL SURVEY	SURVEYED	BY	DATE
NOTE BOOK	PLOTTED		
	TEMPLATE		
	AREAS		
	CHECKED		

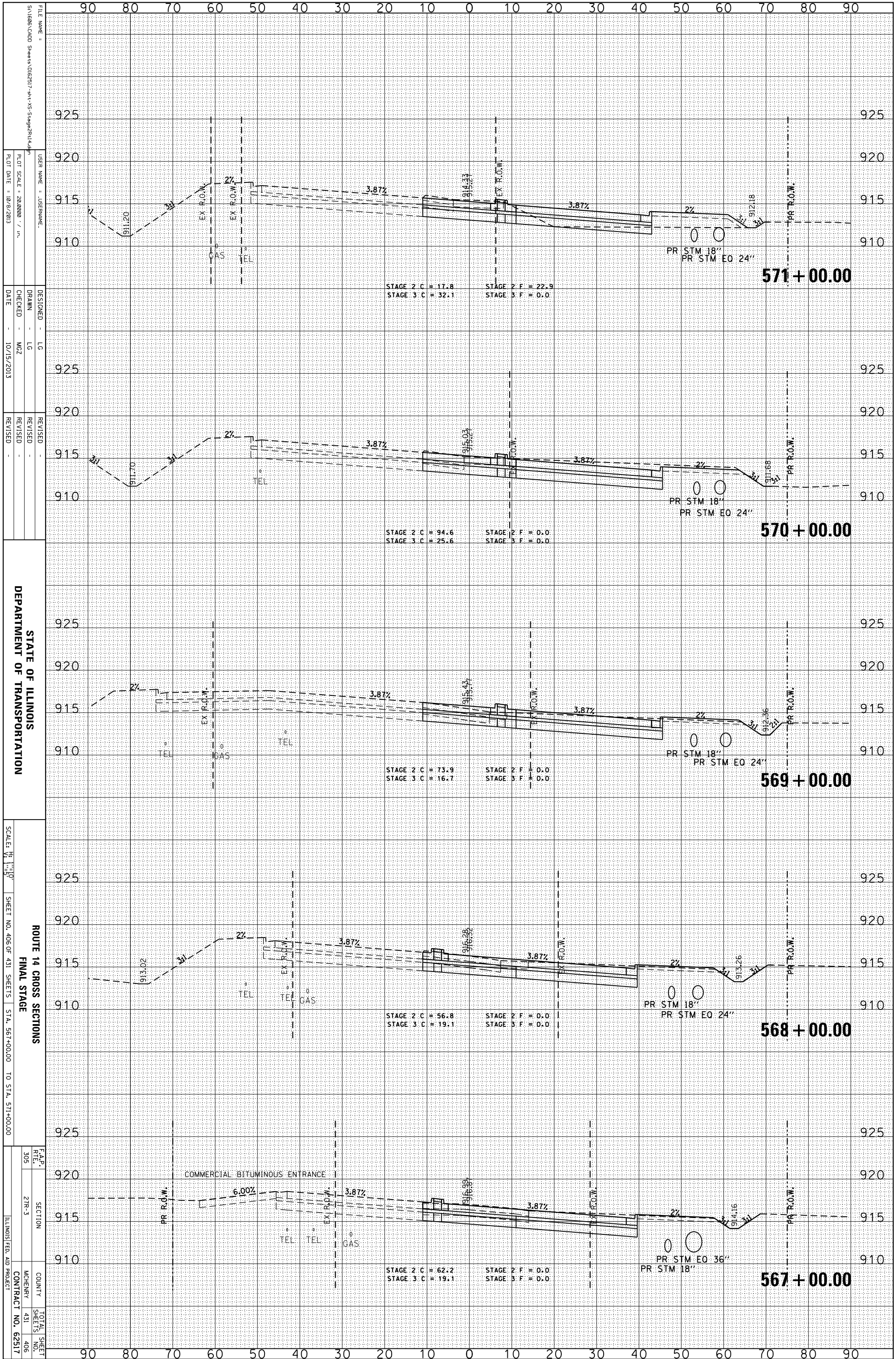

STATE OF ILLINOIS
DEPARTMENT OF TRANSPORTATION

ROUTE 14 CROSS SECTIONS
FINAL STAGE

F.A.P. R.T.L.	SECTION	COUNTY	TOTAL SHEETS
305	27R-3	MCHEMERY	406
ILLINOIS FED. AID PROJECT		CONTRACT NO.	62517

FILE NAME = S:\1606\CADD Sheets\062517-rt-14-SS-Stage2Rt14.dgn
USER NAME = JUSEPHNAME
DESIGNED - LG
DRAWN - LG
CHECKED - MZ
DATE - 10/15/2013
REVISIONS

SCALE: HORIZONTAL = 1" = 50'
SHEET NO. 406 OF 431 SHEETS STA. 567+00.00 TO STA. 571+00.00

STAGE 2 C = 17.8
STAGE 3 C = 32.1
STAGE 2 F = 22.9
STAGE 3 F = D.O.

STAGE 2 C = 94.6
STAGE 3 C = 25.6
STAGE 2 F = D.O.
STAGE 3 F = D.O.

STAGE 2 C = 73.9
STAGE 3 C = 16.7
STAGE 2 F = D.O.
STAGE 3 F = D.O.

STAGE 2 C = 56.8
STAGE 3 C = 19.1
STAGE 2 F = D.O.
STAGE 3 F = D.O.

STAGE 2 C = 62.2
STAGE 3 C = 19.1
STAGE 2 F = D.O.
STAGE 3 F = D.O.

COMMERCIAL BITUMINOUS ENTRANCE